



**NOTIFICATION TO ATTEND MEETING OF THE NORTH WEST AREA COMMITTEE
TO BE HELD IN THE CONFERENCE ROOM - BALLYMUN CIVIC OFFICES,
ON TUESDAY, 18 OCTOBER 2016 AT 2.30 PM**

AGENDA

TUESDAY, 18 OCTOBER 2016

		PAGE
1	Minutes of the North West Area Committee Meeting held on Tuesday 20th September 2016	1 - 6
2	Questions to the Area Manager	7 - 16
	Cabra Area Matters	
3	Cabra Area Office Report, Fergus Synnott, Administrative Officer	17 - 20
4	Proposed extinguishment of the public right of way over the laneway to the rear of 62-72 Faussagh Avenue, Dublin 7.	21 - 22
	Housing Matters: Cabra - Finglas	
5	Housing Cabra/Finglas Report, Derek Healy, Housing Manager	23 - 28
	Finglas Area Matters	
6	Finglas Area Office Report, Aidan Maher, Assistant Area Manager	29 - 32
7	Proposed disposal of a plot of land on the Finglas Road, Dublin 11 to the Ardmore Care Home Group Ltd.	33 - 36
8	Finglas Festival Presentation, Fintan Walsh and Sean Mooney, Finglas Festival Committee	
	Motions	
9	Motion in the name of Councillor David Costello That this committee or a sub group of this committee be included in some way in the process of selecting a site for a new library in Finglas.	
10	Motion in the name of Councillor David Costello That the manager provides an update in relation to communications between DCC area office and the Owner of the Barry Shops and that a plan be put in place to CPO the site if funds become available.	

- 11 Motion in the name of Councillor David Costello

That the Manager requests a report from the relevant section of DCC in relation to the usage of AstroTurf facilities at the Finglas Leisure Centre. and that consideration be given to supplementary uses by other sports. (Bowls, tennis etc.)

Area Wide Matters

- 12 Update on Dublin North West Area Partnership, Michael Bowe, Chief Executive.
- 13 Public Domain Report, John Twamley, Public Domain Officer **37 - 42**
- 14 Sports & Wellbeing Partnership Report **43 - 46**
- 15 Dublin's Culture Connects: The National Neighbourhood Project, Ray Yeates, Arts Officer **47 - 50**
- 16 Social Housing Delivery Report **51 - 70**
- 17 Traffic Service Requests, Status Report **71 - 102**
- 18 Minutes of the Traffic Advisory Group (TAG) Meeting **103 - 104**

Motions

- 19 Motion in the name of Councillor David Costello

That this area committee would reconsider the practice of handing out flowers to community groups and residents associations in favour of providing them with vouchers and credit notes for local garden centres.

- 20 Motion in the name of Councillor David Costello

That the manager provides an update in relation to the local DCC / Fingal Forum that was set up over 18 months ago.

- 21 Motion in the name of Councillor Aine Clancy

To request that the Manager invite the parking enforcement Company for DCC to attend at an area meeting to respond to Councillors questions. Councillors will be asked to submit their questions prior to the meeting.

Ballymun Area Matters

- 22 Ballymun Area Office Report, Mary Taylor, Assistant Area Manager **105 - 112**
- 23 Proposed grant of a further licence of part of 133A Slaney Road, Glasnevin, Dublin 11 to Eco Mattress Recycling Limited for Noting **113 - 116**
- 24 Q&A on Report on Submissions from Members of the Public on the Wider Area Traffic Cell Analysis of Walsh Road, Ferguson Road and Millmount Avenue, Drumcondra, Neil O'Donoghue, Traffic Engineer, Eoin O'Mahony, Associate Director, Transportation AECOM Consultants **117 - 126**

Motions

25 Motion in the name of Councillor Noeleen Reilly

That this area committee support the rising of the wall between Magenta Crescent and Magenta Hall in Santry. While the Council maintain the wall is high enough, it is not stopping anti social elements climbing over it which in turn is causing issues within the estates.

26 Motion in the name of Councillor Noeleen Reilly

That the Council immediately commence consultation with Residents in St Margaret's Traveller Community Association and Carton Estate in relation to the New Northside Depot at St Margaret's.

27 Motion in the name of Councillor Greg Kelly, South East Area

To ask the manager to urgently review Traffic Safety measures at Balcurris/Balbutcher lane Junction. There was another accident here recently.

28 Motion in the name of Councillor Michael MacDonncha, North East Area

That the Manager look at tree pruning at the rear of Magenta Crescent, Santry. The current situation is making is very dark for residents living along this stretch.

29 Motion in the name of Councillor Cathleen Carney Boud

That the manager explains why a previous plan to put car parking spaces on the green area on Glasanaon Road, to the side of Mother of Divine Grace School, at the time when the dressing rooms were to be installed there? Can a plan to install parking spaces there now be reinvigorated and also considerations of parking at intermittent spots where possible along the Glasanaon Road where traffic and parking is causing serious problems.

30 Motion in the name of Councillor Cathleen Carney Boud

That the manager considers the installation of railings around the Swale area at Ballygall Parade to be financed by the discretionary budget in 2017.

This page is intentionally left blank

NORTH WEST AREA COMMITTEE MEETING

MINUTES

TUESDAY 20th September 2016

NWA/196/16 Minutes of the North West Area Committee Meeting held on Tuesday 19th July 2016.

ORDER: Noted.

NWA/197/16 Questions to the Area Manager

ORDER: Noted.

NWA/198/16 Cabra Area Office Report, Fergus Synnott, Administrative Officer

ORDER: Noted. Emergency motion from Councillor Cieran Perry in relation to working hours of Iarnród Éireann was withdrawn and discussed as an item under the Cabra Area Office Report.

NWA/199/16 Bus Priority Report "The bus priority team is proposing a scheme to improve bus journey times outbound on the Navan Road", Maggie O'Donnell, Senior Executive ITS Officer.

ORDER: Noted.

NWA/200/16 With reference to the proposed disposal of the Council's fee simple interest in the premises now known as No. 137 North Circular Road, Dublin 7

ORDER: Recommend to City Council.

NWA/201/16 **Motion in the name of Councillor Cieran Perry**

Can the Manager organise the installation of a mobile CCTV camera to identify the culprits illegally dumping at the bottle bank at the end of Carnlough Road. This has been done on a number of occasions previously.

ORDER: Report to Councillor.

NWA/202/16 Housing Cabra/Finglas Report, Derek Healy, Housing Manager

ORDER: Noted.

NWA/203/16 Part 8 St. Finbarr's Court - Bedsit Amalgamation Proposal for information purposes only, Cecilia Naughton, City Architects

ORDER: Noted

NWA/204/16 Finglas Area Office Report, Aidan Maher, Assistant Area Manager

ORDER: Noted

NWA/205/16 Motion in the name of Councillor Paul McAuliffe

After 7 years lying idle, the NWAC call on the council to compulsory purchase the derelict house in Oakwood. While the owner who is now in the UK has been registered on the Derelict Sites Register and will incur fines, we cannot let this eyesore remain. There are many similar sites across the city and DCC should be using the power to CPO more.

ORDER: Report to Councillor.

NWA/206/16 Motion in the name of Councillors David Costello & Paul McAuliffe

That the office of international relations assist the village of Finglas to establish a cultural connection/sister village relationship with an urban village in one of the following Cities currently twinned with Dublin City: San Jose, Liverpool and Barcelona.

ORDER: Report to Councillor.

NWA/207/16 Motion in the name of Councillor Paul McAuliffe

That Dublin City Council will compulsory purchase the Drake Pub and use the site for the construction of a new Public Library for Finglas.

ORDER: Report to Councillor.

NWA/208/16 Motion in the name of Councillor David Costello

That the manager provides an update in relation to the Dunsink driveway extensions which the NWAC approved funding for as part of the discretionary fund.

ORDER: Report to Councillor.

NWA/209/16 Motion in the name of Councillor David Costello

That this committee calls on the manager to examine the possibility of replacing the harsh speed ramps in Northway Estate and adjacent roads with more appropriate ones.

ORDER: Report to Councillor. Possible inclusion in the Road Works Programme to be examined by Traffic.

NWA/210/16 Motion in the name of Councillor David Costello

the manager provides a full update in relation to the rapid build project in Finglas South and an update in relation to the PPP for Scribblestown.

ORDER: Report to Councillor.

NWA/211/16 Motion in the name of Councillor David Costello

That the manager orders an inspection of fire safety of all council owned houses in Lake Glen, Finglas South following reports of smoke permeating through houses following a recent fire.

ORDER: Report to Councillor.

NWA/212/16 Motion in the name of Councillor Anthony Connaghan

That the Area Office apply for Sports Capital Funding in 2017 to provide an outdoor gym in Tolka Valley Park.

ORDER: Report to Councillor.

NWA/213/16 Questionnaire on the North West Area Committee Format – Aidan Maher, Assistant Area Manager.

ORDER: Noted. It was agreed to keep the format as is, subject to review in three months, if there is insufficient time for Ballymum matters.

NWA/214/16 Public Domain Report, John Twamley, Public Domain Officer

ORDER: Noted. A number of issues were discussed. John Twamley will discuss the movement of the clothes bank at Coultry Lane with Waste Management and report back to the October meeting.

NWA/215/16 Sports & Wellbeing Partnership Report.

ORDER: Noted

NWA/216/16 Quarterly Housing Allocation Report up to 31st July 2016

ORDER: Noted

NWA/217/16 Planning Quarterly Enforcement Report, Fiacra Worrall, Assistant Enforcement Manager.

ORDER: Noted. A number of issues were discussed.

NWA/218/16 Traffic Service Requests, Status Report

ORDER: Noted. An update on the Drumcondra Traffic Study will be presented to the October North West Area Committee Meeting for Councillor's comments. A decision on the preferred option for the Traffic Study will be made and presented to the City Council in November for information purposes only.

NWA/219/16 Minutes of the Traffic Advisory Group (TAG) Meeting

ORDER: Noted.

NWA/220/16 Dublin North West Area Partnership Presentation, Michael Bowe, Chief Executive.

ORDER: Deferred.

NWA/221/16 Motion in the name of Councillor Norma Sammon

To call on Dublin City Council to recognise the late actor Gene Wilder and his role in the film "*Quackser Fortune Has A Cousin In The Bronx*" which included notable locations in the area including John Kavanagh's pub and St. Teresa's Place, both in Dublin 9.

ORDER: Report to Councillor.

NWA/222/16 Motion in the name of Councillor Anthony Connaghan

That the Northwest committee engage the DCC Beta projects team to come up with an Innovative solution to improve the dull and boring DCC square bins in the area. At present we hear that people are dumping household rubbish in and around some of the bins and others have been vandalised or damaged by fire. The Beta project team have helped provide artwork around the city which has brightened up dull boring grey boxes and a decrease in vandalism has been seen. It is hoped that we could see similar results with a Beta Project.

ORDER: Report to Councillor.

NWA/223/16 Ballymun Area Office Report, Mary Taylor, Assistant Area Manager

ORDER: Noted. A report on the Northern Site to be included in future Ballymun Area Office Reports.

NWA/224/16 With reference to the proposed grant of a licence in 1 Longdale Terrace.

ORDER: Recommend to City Council

NWA/225/16 Part 8 Glasanaon Court - Bedsit Amalgamation Proposal for information purposes only, Cecilia Naughton, City Architects.

ORDER: Noted.

NWA/226/16 Motion in the name of Councillor Noeleen Reilly

That this area committee supports the great facility that is the Poppintree Community Centre. We recognise the great work that continues there on a daily basis but feels that the sports side of the centre is not reaching its full potential. There is a feeling in the community that young people are not engaging in the activities taking place there. Going forward Dublin City Council will carry out a number of activities to promote the centre and encourage participation in sport.

- 1) Organise a sports introduction day highlighting all sports taking place
- 2) Carrying out a recruitment drive to encourage participation in the centre
- 3) Visit Local Schools advising students of the activities in the centre
- 4) Launch an advertising campaign

ORDER: Report to Councillor.

NWA/227/16 Motion in the name of Councillor Noeleen Reilly

In light of the recent Irish Business against Litter Survey which highlighted Ballymun as a litter black spot in Dublin, this area committee calls on DCC to provide additional resources to tackle illegal dumping. The last thing Ballymun needs when trying to attract business is to be mentioned negatively in a business report.

ORDER: Report to Councillor.

NWA/228/16 Motion in the name of Councillor Greg Kelly, South East Area

That this area committee calls for Traffic Calming measures at Poppintree Crescent and Belclare Drive. There have been numerous accidents recently on this road. Residents raised this issue before the road opened and were told that all measures were included. The safety measures on the road are not adequate with the level of traffic and it needs to be reviewed before there is serious injury to someone. Residents are requesting transfers out of the area because of the danger on the road.

ORDER: Report to Councillor.

NWA/229/16 Motion in the name of Councillor Andrew Montague

That the council provides bike racks on Ballymun Plaza as part of the planned refurbishment.

ORDER: Report to Councillor.

NWA/230/16 Motion in the name of Councillor Andrew Montague

That the council look at ways to prevent the ongoing dumping on the Shangan side of the gap between Shangan and Shanliss Grove. Planting, or a piece of art involving the community might help deter the regular dumping at this location.

ORDER: Report to Councillor.

NWA/231/16 Motion in the name of Councillor Andrew Montague

That the council replace the bin at the bus stop outside the Omni shopping centre on the Swords Road and replace the missing cobble locks from when the bin was removed.

ORDER: Report to Councillor.

NWA/232/16 Motion in the name of Councillor Andrew Montague

That the council examine Shantalla bridge flyover to make it more pedestrian friendly. The bridge was designed in a different era when cars were given priority and the basic design has not been changed since it was opened in

1983. It is very hostile for pedestrians trying to cross the road at the top of the bridge. There are a lot of elderly pedestrians crossing the bridge heading to the church further down the Swords Road. It can be difficult to see oncoming traffic coming from the Swords Road (see photo 1) and the nice smooth curve for vehicles coming from Shantalla Road, turning left on to the Swords Road, encourages vehicles to take the corner at higher speeds. Pedestrian lights should be considered at the top of the bridge, and there is also an opportunity to put in a pedestrian crossing at the bollards towards the Shantalla Road end of the bridge.

ORDER: Report to Councillor.

NWA Councillors:

ORDER: Noeleen Reilly, Anthony Connaghan, Emma Murphy, Paul McAuliffe, Cathleen Carney Boud, David Costello, Teresa Keegan, Cieran Perry, Andrew Keegan, Seamus McGrattan, Andrew Montague and Norma Sammon

Apologies: Councillor Lord Mayor, Brendan Carr, and Councillor Aine Clancy.

Officials: Dave Dinnigan (Area Manager), Aidan Maher (Senior Executive Officer), Mary Taylor (Senior Executive Officer), Donal Barron (Area Housing Manager – Ballymun), Catherine Quinlan (Housing), Fiacra Worrall, (Assistant Enforcement Manager), Fergus Synnott, (Administrative Officer – Cabra), Bridget Gilbert (Senior Staff Officer), Mary Bellew (Staff Officer), (Traffic Management & Control) Neil O'Donoghue (Traffic Engineer, NWA), John Twamley (Public Domain Officer, Maggie O'Donnell (Senior Executive ITS Environment & Transportation Department), Cecilia Lopez- Naughton, (Senior Executive Architect)

**Councillor Noeleen Reilly
Chairperson**

The meeting concluded at 4.20 pm.

Questions to the Area Manager

North West Area Committee

Meeting 18th October 2016

- Q1. Councillor Noeleen Reilly**
To ask the Manger to look at Sharp Bins for (details supplied) which are currently being piloted by DCC in the City Centre given the recent incidences of needles being found in the area
- Q2. Councillor Noeleen Reilly**
To ask the Manager to clear the leaves from (details supplied)
- Q3. Councillor Noeleen Reilly**
To ask the Manager to look at Traffic calming measures for (details supplied)
- Q4. Councillor Noeleen Reilly**
To ask the Manager to ensure that the pavements in (details supplied) are returned to their previous condition after recent works by Bord Gais.
- Q5. Councillor Noeleen Reilly**
To ask the Manager to clear the grass and weeds from the laneway at (details supplied)
- Q6. Councillor Noeleen Reilly**
To ask the Manager to look at Parking Restrictions at (details supplied), people are parking all over the grass there.
- Q7. Councillor Noeleen Reilly**
To ask the Manager for permission to plant a (details supplied)
- Q8. Councillor Noeleen Reilly**
To ask the Manager to apply for funding from the (details supplied) from the Infrastructure fund for site enabling works to task place in (details supplied) in preparation for the building of Affordable and Social Units.
- Q9. Councillor Noeleen Reilly**
To ask the Manager to ask for an update on the land at (details supplied) and if these could be used for Co-op housing.
- Q10. Councillor Aine Clancy**
To ask the Manager that an urgently needed disabled parking space is located outside the pharmacy on (details supplied).
- Q11. Councillor Aine Clancy**
To ask the Manager the condition of pavements and plan for improvements on (details supplied)
- Q12. Councillor Aine Clancy**
To ask the Manager for an inspection on a cherry blossom at the entrance of (details supplied) this mature tree has been blossoming for years however this year it failed and as I have had an opinion given to me I would be interested in parks analysis. There is also a couple of smaller trees missing just after the cherry blossom. Would it

be possible for person dealing with this issue to leave their name and mobile contact number with my response.

Q13. Councillor Norma Sammon

To ask the Manager what is the current strategy for parking management by Dublin City Council around the areas of (details supplied) in (details supplied) [e.g. How many extra Parking Services vehicles are dispatched? Is there coordination with An Garda Síochána? Is there a public awareness element?] And if they would consider increasing resources for big match days (All Ireland Finals).

Q14. Councillor Norma Sammon

To ask the Manager to provide a report on the number of fines issued and cars towed or clamped around that area on (details supplied) for the previous 3 years.

Q15. Councillor Norma Sammon

To ask the Manager which gates in (details supplied) are left open overnight and for what reason are they left open?

Q16. Councillor Norma Sammon

To ask the Manager (details supplied) to review traffic congestion on (details supplied) Rd. The road between (details supplied) is very narrow and barely allows two cars to pass with a third car parked by the pathway. Can this be investigated and a solution implemented to allow freer and safer flow of traffic whilst respecting residents' right to park outside their homes and pedestrians right to traverse the path.

Q17. Councillor Norma Sammon

To ask the Manager to remove graffiti at (details supplied) as soon as possible

Q18. Councillor Norma Sammon

To ask the Manager to review and introduce road markings, a crossing guard, additional enforcement or some other solution to prevent an accident happening on (details supplied) I understand the problem to be parked cars on the (details supplied) at the entrance to the school. As a result, the bus does not stop to pick up the school children as it is too dangerous. Parents park their cars opposite the school in (details supplied) grounds. When the children cross the road at the pedestrian lights it is difficult for them to see as a result of the parked cars. This is an ongoing problem, the Gardaí come periodically to issue tickets but people continue to park there. Teachers and staff also have difficulty getting access to the school.

Q19. Councillor Norma Sammon

To ask the Manager to remove weeds at on (details supplied)

Q20. Councillor Norma Sammon

To ask the Manager to investigate the parking spaces outside (details supplied) as they do not seem to have been drawn by the Council and take any necessary action

Q21. Councillor Norma Sammon

To ask the Manager which officials will make the decision on the traffic options for (details supplied).

Q22. Councillor Norma Sammon

To ask the Manager to review the trees outside (details supplied). They appear to be overgrown and the roots are a tripping hazard for residents.

Q23. Councillor Norma Sammon

To ask the Manager to review the traffic lights at the exit of (details supplied). The traffic at this exit means it's hard for residents of the area to come in and out of their estate. Many vehicles stop in the yellow box and the traffic lights are at times ignored. Is it possible to make the traffic lights higher or over hanging or to place a series of red lights/cat eyes on the road itself to indicate a stopping point to vehicles.

Q24. Councillor Anthony Connaghan

To ask the Manger to provide the following figures relating to road maintenance income/expenditure. Can the Manager provide comparative figures for the different Areas please?

- (a) Total Income from road openings closures etc from utility companies etc
- (b) Total Spending on roads/footpath maintenance per area

Q25. Councillor Anthony Connaghan

To ask the Manager how much has been spent on (details supplied) to (details supplied)being in poor condition for the previous 5 years.

Q26. Councillor Anthony Connaghan

To ask the Manager is there is policy to repair areas where claims have been made in relation to footpaths/roads being in poor condition?

Q27. Councillor Anthony Connaghan

To ask the Manager to arrange for a dead tree to be removed and replaced with a suitable tree at 6 Barnamore Park

Q28. Councillor Anthony Connaghan

To ask the Manager to arrange for a full inspection of the roads and footpaths in the Lakeglen Esate, Finglas South. Can the Manager arrange for particular attention for the following please?

- (a) 11-12 Gortmore Drive, the footpath is uneven and broken and needs repairing
- (b) 7 Gortmore Drive, the footpath is in poor condition here
- (c) Potholes in road between 61 and 100 Gortmore Road.

Q29. Councillor Anthony Connaghan

To ask the Manager to arrange for the paths outside numbers 1-21 Farnham Drive to be replaced and margins repaired. A small section was replaced outside number 1 but this wasn't continued further up the road.

Q30. Councillor Anthony Connaghan

To ask the Manager to arrange for the yellow box and road markings at Wellmount Road/N2 junction to be upgraded. Can the Manager arrange for the tarmac in Barrack Lane to be resurfaced also please?

Q31. Councillor Anthony Connaghan

To ask the Manager to arrange for trees along Plunkett Avenue to be pruned back. Some of these trees are badly overgrown and haven't been cut back in a good while.

Q32. Councillor Anthony Connaghan

To ask the Manager to arrange for a full inspection of the footpaths on Kildonan Drive and Casement Green. These roads have been reported as being in poor condition and are home to a number of elderly residents who can struggle with mobility issues.

Q33. Councillor Anthony Connaghan

To ask the Manager to arrange for the resurfacing of the tarmac in the cul de sac on Plunkett Green. There is a young child who lives here that needs the assistance of a walker and who struggles and has fallen on the road outside due to the unevenness of the road surface. I can pass on the parents details if needed.

Q34. Councillor Anthony Connaghan

To ask the Manager for a status update on the request for a walk in shower at (details supplied). The tenant has reported that the job was measured up but she hasn't heard anything since.

Q35. Councillor Emma Murphy

To ask the Manger Could the wall around the green on (details supplied) across from the scouts den & the (details supplied) be repaired. The wall around the green has been damaged for some time now & is an eyesore on one of the main thoroughfares in (details supplied).

Q36. Councillor Emma Murphy

To ask the Manager (details supplied) can the scrubs & trees on the green at the junction of (details supplied) be cut back and tidied up.

Q37. Councillor Emma Murphy

To ask the Manager can the potholes at the junction of (details supplied) be repaired.

Q38. Councillor Emma Murphy

To ask the Manager to extend the dog dirt bin trial to (details supplied).

Q39. Councillor Emma Murphy

To ask the Manager if the rocks that are used as a barrier in between (details supplied) can be replaced with railings as they are attracting constant dumping.

Q40. Councillor Emma Murphy

To ask the Manager If the railings at (details supplied), adjacent to (details supplied), can be repaired and missing sections replaced or alternative works be done to remedy the situation. The damaged & missing sections are an eyesore on this section of the road.

Q41. Councillor Emma Murphy

To ask the Manager to repair the pothole on (details supplied)

Q42. Councillor Emma Murphy

To ask the Manager To look at putting bollards on the extended corners of paths on (details supplied) to combat the parking that is taking place on them. I have received numerous complaints from drivers regarding this, cars are blocking the view of oncoming traffic and will cause an accident.

Q43. Councillor Emma Murphy

To ask the Manager Could the paths in (details supplied) be investigated and any repairs carried out. Also could any potholes in the estates be repaired.

- Q44. Councillor Emma Murphy**
To ask the Manager to have the bollard outside of (details supplied) repaired.
- Q45. Councillor Emma Murphy**
To ask the Manager to have the bin on (details supplied) near the (details supplied) replaced.
- Q46. Councillor Cathleen Carney Boud**
To ask the Manger for the potholes on the path outside nos (details supplied) to be repaired and to consider the whole street for full reinstatement in the roads and path works schedule for 2017
- Q47. Councillor Cathleen Carney Boud**
To ask the Manager or a railing and kissing gates to be fitted at the side of (details supplied). At present there are bollards only across this gap which are used to sit on and are completely ineffective.
- Q48. Councillor Cathleen Carney Boud**
To ask the Manager for the green area facing (details supplied) to be tarmacked as the green area is constantly dumped on and recently used needles were found there.
- Q49. Councillor Cathleen Carney Boud**
To ask the Manager for the green area facing (details supplied) to be removed and replaced with tarmac. The road is very narrow and there's no room for an ambulance or Fire Brigade to pass.
- Q50. Councillor Cathleen Carney Boud**
To ask the Manager to arrange for an inspection at (details supplied) to look at the following:
- a) The dampness in the bedroom
 - b) Cracks in the walls
 - c) Problems with the boiler and the heating
 - d) MDF shelter under the stairs
- Q51. Councillor Cathleen Carney Boud**
To ask the Manager to ask the manager that a new survey be carried out regarding Pay & Display Parking just for (details supplied) that doesn't include other streets.
- Q52. Councillor Cathleen Carney Boud**
To ask the Manager to ask the manager to arrange the following at (details supplied)
- a) the ceiling that was damaged to be repaired
 - b) the downstairs bathroom has a leak
- Q53. Councillor Cathleen Carney Boud**
To ask the Manager to ask the manager to explain why a water meter was installed for no (details supplied) and placed around the corner from the house at the side of no3 as opposed to directly in front of the property at no 1.
- Q54. Councillor Cathleen Carney Boud**
To ask the Manager to consider the full reinstatement of the concrete path at (details supplied) from no 1 (opposite the shops) the whole length of the street on that side to be included in the schedule of works 2017. Could the manager also confirm when the tarmac surface outside no 30 will be replaced as per previous requests. The tarmac there has sunk considerably and is dangerously uneven.

Q55. Councillor Andrew Montague

To ask the Manager will the council install a Pétanque court in Ellenfield Park in time for next Spring? The Whitehall Active Retirement Association has been campaigning for the court for a number of years.

Q56. Councillor Andrew Montague

To ask the Manager will the council install measures to prevent parking on the grass verge in Magenta Hall, where the trees are due to be replaced as part of the tree upgrade programme? There is plenty of room to park on the road but motorists frequently park on the grass, damaging the planted area. Will the council also consider removing the briars around the Magenta Hall sign, as part of the project? This is a common location for dumping, and it's very difficult for the local residents to keep clean. (photo attached)

Q57. Councillor Andrew Montague

To ask the Manager will the council address the water pooling that happens at the bus stop on the Swords Road, heading out of town, beside the junction with Collins Avenue. Water pools here frequently and people waiting for the bus often get soaked by fast moving traffic. (photo attached)

Q58. Councillor Andrew Montague

To ask the Manager will the council work with (details supplied) to get some planters in their area (for example (details supplied)). They would also like to get the ESB boxes painted, as has been done in other areas? Perhaps local business could help sponsor some of these upgrades?

Q59. Councillor Andrew Montague

To ask the Manager will the council resurface (details supplied)?

Q60. Councillor Andrew Montague

To ask the Manager will the council upgrade the footpaths on (details supplied). The surfaces are very broken up due to roots of trees, and there are two blind pedestrians that use the road daily and it's a difficult surface for them to walk.

Q61. Councillor Andrew Montague

To ask the Manager will the council assess the junction between (details supplied) for pedestrians to try and make it safer for pedestrians. Traffic turning left from (details supplied) on to (details supplied) frequently break the lights and cut across the pedestrians as they cross the road.

Q62. Councillor Andrew Montague

To ask the Manager will the council reassess the junction of (details supplied). There are particularly long delays for vehicles heading west along (details supplied), especially for cars going straight ahead, or turning left on to (details supplied). In order to avoid the delays some motorists are using the right only lane and using it to go straight ahead, which is a dangerous manoeuvre. Can the council give more time for vehicles coming out of (details supplied) both to reduce delays and to reduce the temptation for motorists to use the wrong lane.

Q63. Councillor Andrew Montague

To ask the Manager will the council upgrade the footpath on (details supplied), as the footpath is broken up.

- Q64. Councillor Andrew Montague**
To ask the Manager will the council assess (details supplied), which is in very bad condition? The resident is longterm in hospital, and their executors are not maintaining the property.
- Q65. Councillor Andrew Montague**
To ask the Manager will the council repair the broken pavement outside 65-67 Shanowen Grove (photo attached)
- Q66. Councillor Teresa Keegan**
To ask the Manger to arrange to have the yellow traffic box at (details supplied) repainted in order to improve driver safety.
- Q67. Councillor Teresa Keegan**
To ask the Manager to arrange to have the pavements at a location repaired as they have fallen into a poor state along (details supplied)
- Q68. Councillor Teresa Keegan**
To ask the Manager to arrange to have the trees at the green on (details supplied) pruned back as they have become very overgrown.
- Q69. Councillor Teresa Keegan**
To ask the Manager to arrange to have a site secured as it has become a magnet for illegal dumping and anti-social behaviour (details supplied)
- Q70. Councillor Teresa Keegan**
To ask the Manager when an approved access ramp will be installed at (details supplied). The resident is housebound due to the fact that her mobility scooter cannot enter or exit the property until the ramp.
- Q71. Councillor Teresa Keegan**
To ask the Manager to provide details about the proposed development of social housing at a site (details supplied).if he will outline the Council's design brief that has been supplied to the chosen architects, the proposals for local consultations and if these developments will be subject to 'fast track' planning regulations.
- Q72. Councillor Teresa Keegan**
To ask the Manager to provide details of the leaf sweeping schedule proposed for roads and estates in the North-West Area for the upcoming autumn/winter period
- Q73. Councillor Teresa Keegan**
To ask the Manager to arrange for a safety audit to be carried out (details supplied)
The area has become very congested during the morning and evening peaks and poses a risk to pedestrians and cyclists. The island in the centre of the pedestrian crossing on the Northern side of the (details supplied).
his is heavily used by schoolchildren who are required to wait for a second green man on the centre island which is inadequate to cater for the numbers crossing, including many students with bicycle
- Q74. Councillor Teresa Keegan**
Will the Manager undertake to ensure that all outstanding works at (details supplied) are completed without delay. The reinstatement of garden lighting, decking and paving to restore to original condition.

Q75. Councillor Teresa Keegan

To ask the Manager to outline the response to the request made by the Beaumont Residents Association at their meeting on Thursday September 15th in respect of the proposed housing on the Lawrence Lands site and will he say when a formal response to all of the points raised will be made to the residents association.

Q76. Councillor Teresa Keegan

To ask the Manager to arrange for a bollard/bollards to be erected at the southern side of the driveway into (details supplied) in order to prevent the frequent problem of illegal parking in this area.

Q77. Councillor David Costello

To ask the Manger why a man living in (details supplied) has applied for a small ramp outside his door but was told it could take 18 months. This is unacceptable for a small job and is confining the person in question to their house.

Q78. Councillor David Costello

To ask the Manager

Communication from resident:

(details supplied)

With regard to the above address. I was under the impression that the Council were going to take care of this premises instead they pulled a few weeds but did not come back to finish the job therefore the roots were not dug up and are now thriving at 3ft high once again. Would it be possible to get someone in your office could contact the council before this gets out of hand once again.

Thanks you for your help.

Q79. Councillor David Costello

To ask the Manager please provide an update of any housing developments in the Finglas area.

Q80. Councillor David Costello

To ask the Manager can the tree outside (details supplied) be pruned.

Q81. Councillor David Costello

To ask the Manager can the manager issue a report/update in relation to compliance with planning conditions of the site currently under construction at lidl Annamoe road, Cabra

Q82. Councillor Cieran Perry

To ask the Manger if it is possible to identify the financial institution which owns (details supplied? There is domestic waste dumped in the back garden shed and it is becoming a health hazard. The house was repossessed within the last year or two.

Q83. Councillor Cieran Perry

can the Manager confirm the following?

In relation to (details supplied) course and (details supplied),

a) The winter opening hours for both facilities?

b) The usage per month for the last two years for both facilities?

Q84. Councillor Cieran Perry

To ask the Manager (details supplied)

Details:

In relation to the (details supplied) can the Manager provide an update on the following?

- a) How many applicants are currently (details supplied)?
- b) Are all applicants accepted (details supplied)
- c) How many accepted applications, per year, are still waiting on suitable vacancies?
- d) How many applications (details supplied)?
- e) What monies are currently outstanding (details supplied)

Q85. Councillor Cieran Perry

To ask the Manager Can the Manager confirm the reasoning for the extension of the time allowed for additional information for (details supplied)? It appears that the time has been extended by 3 months.

Q86. Councillor Cieran Perry

To ask the Manager can the (details supplied) confirm which (details supplied) works on behalf of (details supplied), are covered by the main (details supplied) contract and which works require specific permissions?

Q87. Councillor Cieran Perry

Can the Manager confirm if DCC has a (details supplied)

Q88. Councillor Cieran Perry

Can the Manager inspect the footpaths (details supplied) and repair any damaged sections?

Q89. Councillor Cieran Perry

Can the Manager confirm if Dublin City Council is considering continuing the successful Sunday opening of the (details supplied)?

Q90. Councillor Seamus McGrattan

To ask the Manager to have the tree pruned outside (details supplied) as it is having a negative impact on elderly residents

Q91. Councillor Seamus McGrattan

To ask the Manager to put together a traffic plan for the (details supplied) following a lot of accidents at this location

Q92. Councillor Seamus McGrattan

To ask the Manager to upgrade the public domain around the bottle banks at the bottom of (details supplied)

Q93. Councillor Seamus McGrattan

To ask the Manager to put together a new plan for (details supplied) playground following the abandonment of the previous proposal from (details supplied)

- Q94. Councillor Seamus McGrattan**
To ask the Manager to consider traffic calming measures on (details supplied)
- Q95. Councillor Seamus McGrattan**
To ask the Manager to remove the horse being kept on the new landscaped area beside the new (details supplied)
- Q96. Councillor Seamus McGrattan**
To ask the Manager to change the sequence of traffic lights at the junction of the (details supplied) and (details supplied) to allow more traffic exit Kinvara in morning peak times
- Q97. Councillor Seamus McGrattan**
To ask the Manager to clarify if there is a two way system on (details supplied) between the bridge and the junction of (details supplied) and to erect signs to clarify what system is in place.
- Q98. Councillor Seamus McGrattan**
To ask the Manager to consider installing a playground on the green in (details supplied)
- Q99. Councillor Seamus McGrattan**
To ask the Manager what progress has been made on the installation of play facilities in (details supplied)
- Q100. Councillor Seamus McGrattan**
To ask the Manager to consider working with the (details supplied) to upgrade the playing pitches in the (details supplied) in the 15 acres.

**The Chairman and Members of
North West Area Committee.**

Meeting: 18th October 2016

Item No: 3

Cabra Area Office Report

Broome Lodge

There is no further update at this point.

Blackhorse Avenue – Section 2, Road Improvement Scheme

Cabra Area Office are working with the project team towards the reinstatement the Poor Man's Well at Cabra Gate. Site meetings have taken place between the project engineers, the contractor and city archaeologist to determine the works to be done. These are quite extensive in terms of site preparation and restoration and require considerable attention to detail. A detailed plan has been outlined for the project and a follow-up Site Meeting (attended by the City Archaeologist, the Contractor's Consultant Archaeologist, DCC's Parks Department, and Roads Construction Division) will be held on Tuesday, 18th October to confirm any outstanding items of interest in this matter.

Chapel Crescent

A local resident raised the issue of safety regarding a low wall between the Crescent and Ashington Court. I inspected this with the Parks Inspector and discussed the issue with local residents in Ashington Court. We are obtaining quotations for options to raise the level of the wall in order to discourage young people crossing from either side. Residents are fully supportive.

Faussagh Upgrade Project

Aidan Maher and I met with representatives from the Parks and Roads Departments with a view to initiating an upgrade project for Faussagh Avenue between Ratoath Road and Quarry Road roundabouts. While various measures have been taken over the past twelve months by both the Community Section and the Area Office in association with residents, this is aimed at delivering a more substantial 'greening' upgrade. It will include landscaping at the edge of the car park of Church of the Most Precious Blood and the corresponding front of Broome Lodge and also at various points along the road. A topographical survey of the road is being commissioned in the first instance to establish the position of underground services as it is hoped that a number of tree pits can be installed. While an initial meeting was held with Fr O'Grady in the summer to outline the idea in respect of the church grounds it must be emphasized that no agreement on any plan has yet been agreed. Fr O'Grady has agreed to submit plans being developed by our Parks Dept to the Parish Council and Archbishop's House for consideration when received.

It is expected that the main work will be undertaken in summer 2017 to coincide with the completion of Broome Lodge.

Liam Whelan Bridge

The issue of the bridge finish is being kept on the agenda and Councillors concerns is noted in this regard.

Ormond Print premises

This has been referred to the Derelicts Section for inspection. The Law Department has been requested to establish the ownership position, if it is decided that it warrants action under the Derelict Sites Act, 1990.

Pelletstown Development

I have held several meetings with Roads and Taking in Charge Sections and they maintain that the process has to be initiated by Castlethorn requesting the estate to be taken in charge. This process involves all DCC departments that maintain services including, Roads, Traffic, Lighting etc. Once a request is received the outstanding issues can be identified and notified to Castlethorn.

I met with residents the Navan Road/Pelletstown Community Policing Forum and explained this to them and suggested that they approach Castlethorn to initiate a request in respect of the Ashtown Road section. While normally estates are taken in charge in totality it is possible that this section could be considered on its own because of its overlapping with the public road. While success cannot be guaranteed I believe it is the best way forward and Bryan Maher of the resident's association has agreed to pursue this approach.

Shandon Gardens canal bank wall

An estimate for the rebuilding of the wall and railings has been obtained and forwarded to Waterways Ireland for consideration. As stated in the last report, DCC is keen to co-fund repairs and reinstatement but substantial work is required.

COMMUNITY & SOCIAL DEVELOPMENT

Community Development Grants Scheme

Completed application forms for the 2017 Grant Scheme and for the Informal Adult Education Grant must be submitted to Community and Social Development in Civic Offices by 5pm on the 28th October. If assistance is requiring filling out application or applicants have any queries please contact the community development team at the Cabra Area Office.

The City Neighbourhoods Competition Winners were announced in Croke Park on 29th of September. St Peters Avenue and Phibsborough Tidy Towns were well placed in the competition in their Categories.

Pride of Place.

Clareville Senior Citizens joined with Stoneybatter and they celebrated their achievements and experiences of participating in the Pride of Place Competition on 6th October in the Holy Family Centre in Prussia St. Their work continues on an on-going basis.

Halloween

Plans are being made for upcoming Halloween Activities. The Men's Shed members are busy making head stones and props for the Haunted Grave Yard which will be in St Finbarr's GAA Club Grounds. This was a great success last year. Annamoe Youth Club is bringing a group to Cozy Farm. Cabra for Youth, Ventry Park and Cabra Parkside will have a

programme of activities for the Halloween season. The details of all activities will be confirmed and advertised locally nearer to the time.

The Area Office will be working closely with the Public Domain Officer and the Gardai to prevent the accumulation of bonfire materials and their removal where necessary. Bonfires in the Cabra area have been smaller scale and less damaging in recent years and we will continue efforts to prevent them.

Cabra Community Development Project (CDP)

An open morning was held in Cabra CDP on 6th October. CDP works in partnership with DCC on events and festivals in Cabra and also with community groups, supporting their activities. Members of the Men's Shed, the History Group, Art Groups and Walking Groups, amongst others have been getting active with the "Go for Life" initiative. They are enjoying the games and competitions while visiting other communities.

Aidan Maher
Assistant Area Manager

This page is intentionally left blank

**The Chairman and Members of
North West Area Committee.**

Meeting: 18th October 2016

Item No: 4

**PROPOSED EXTINGUISHMENT OF THE PUBLIC RIGHT OF WAY OVER THE LANEWAY TO THE REAR
OF 62-72 FAUSSAGH AVENUE, CABRA, DUBLIN 7**

Proposal

At its meeting held on 17th November, 2015, the North West Area Committee agreed to a proposal to initiate the procedure for the extinguishment of the public right of way at the above location.

Statutory Requirement

The proposal was advertised in the public press on Monday 18th July, 2016 and signs were erected on site in accordance with Section 73 of the Roads Act 1993. The latest date for receipt of submissions regarding this proposal was Friday 26th August, 2016.

No submissions were received in response to the public advertisement.

Service Checks

There were no objections raised by the Statutory Bodies.

The extinguishment of a public right of way is a reserved function of the City Council. Any recommendation of the Committee will be brought to the attention of the City Council.

**Dave Dinnigan
Area Manager.**

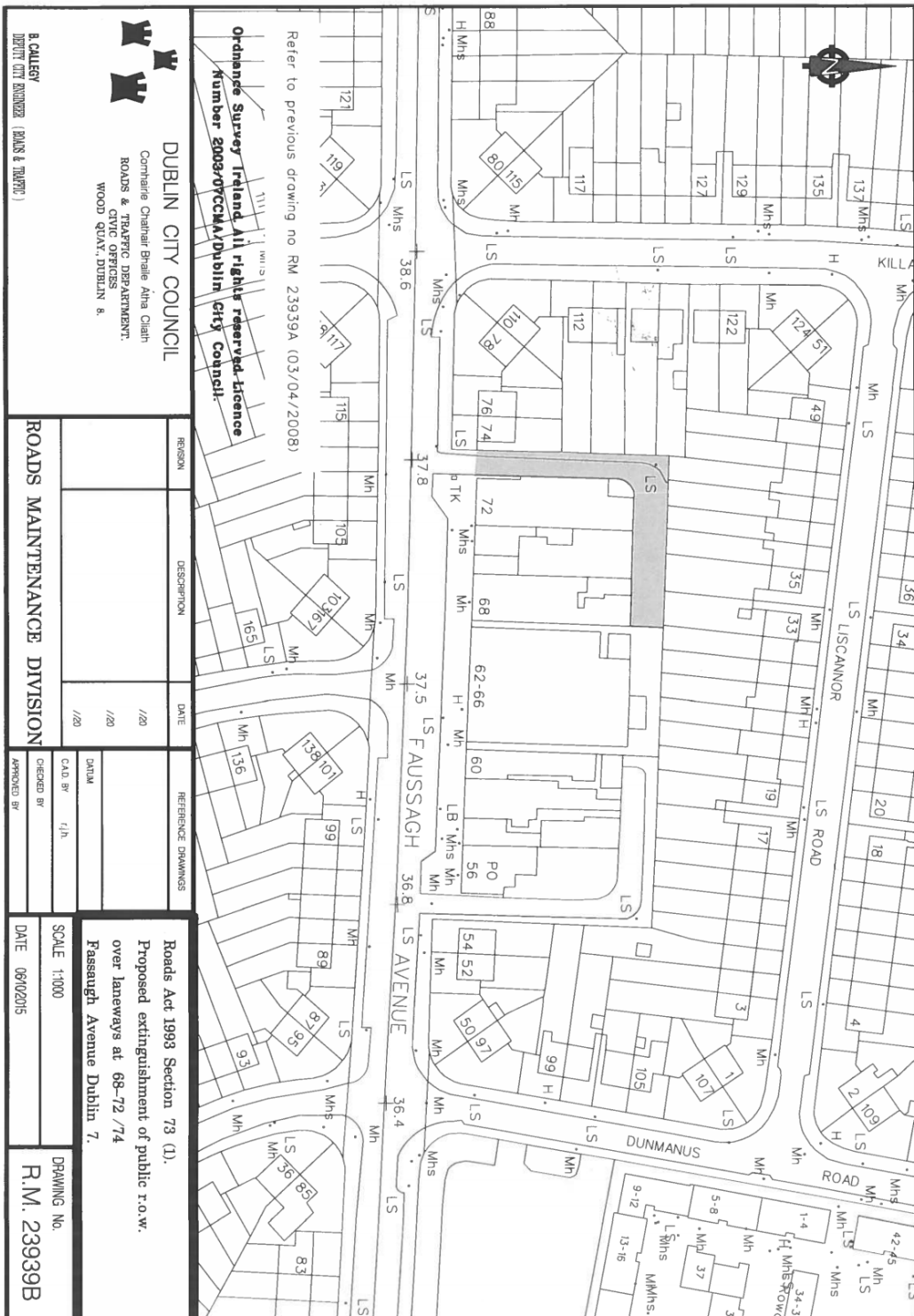

The Chairman and Members of
North West Area Committee.

Meeting: 18th October 2016

Item No: 5

Housing Matters: Cabra-Finglas Report Jan-Sept 2016

Estate Management

	FINGLAS	CABRA
No of Anti social complaints per 1997 act Drug Related	7	2
No of Anti social complaints per 1997 act <u>Not</u> Drug Related	6	4
No of other Complaints	23	19
Total Complaints	36	26

No of Anti Social Interviews per 1997 act	2	1
No of Other Interviews	24	20
Total Interviews	26	21

No of Requests for mediation	4	2
No of Complaints referred to central unit for Action	4	1
No of Section 20 Evictions	0	0
No of excluding Orders applied for by Tenant	0	0
No of Excluding orders applied for by DCC	0	0
No of surrender of Tenancies due to Anti Social Behaviour	0	0
No of Notice to Quits sent to Central Unit	0	0
No of Court Orders Granted	0	0
No of Appeals / Judicial Reviews Challenges	0	0
No of Warrants executed (Evictions)	0	0

Housing Allocations

Category	Housing		Transfers	
	FINGLAS	CABRA	FINGLAS	CABRA
Bands 2 & 3	5	1	0	2
Medical	0	1	0	0
Welfare	1	1	0	1
Homeless	2	2	0	0
Travellers	1	1	0	0
De-tenanting	0	0	0	0
Maintenance Grds	0	0	0	0
Surrendering Larger	0	0	0	0
Unable to afford	0	0	0	0
Total	9	6	0	3

Senior Citizens Allocations

Category	Housing		Transfers	
	FINGLAS	CABRA	FINGLAS	CABRA
Bands 2 & 3	6	1	9	0
Medical	5	1	1	0
Welfare	2	1	0	1
Homeless	5	2	0	0
Travellers	0	0	0	0
De-tenanting	0	0	0	1
Maintenance Grds	0	0	0	0
Surrendering Larger	0	0	1	0
Unable to afford	0	0	0	0
Financial Contribution	0	0	0	0
Total	18	5	11	2

Voids Report

There are currently 12 vacant housing units in the Finglas Area

Address	Type of unit	Date of vacancy	Remarks
15 Barnamore Grove	House	24/06/2016	Works in progress
6 Barry Drive	House	24/08/2016	Works in progress
9 Barry Close	House	01/09/2016	Works in progress
12 Casement Park	House	09/08/2016	Works in progress
3 Kilshane Road	House	01/07/2016	On offer
225 McKee Avenue	House	17/05/2016	On offer
59 Mellowes Avenue	House	30/01/2015	On offer
101 Mellowes Avenue	House	14/04/2016	On offer
61 Ratoath Avenue	House	27/06/2016	*
63 Ratoath Avenue	House	26/07/2016	*
825 Ratoath Road	House	03/10/2016	Works in progress
41 Sycamore Road	House	25/07/2016	Works in progress

* As 61 & 63 Ratoath Avenue are vacant the Local office is looking at ways to redesign the entrances to both these houses to alleviate anti-social behaviour and to improve the appearance of the properties.

There are currently 8 vacant housing units in the Cabra Area

Address	Type of unit	Date of vacancy	Remarks
156 Carnlough Road	House	24/06/2016	On offer
10 Chancel Mews Riverston Abbey	House	09/09/2016	Works in progress
153 Dingle Road	House	28/09/2016	Works in progress
131 Killala Road	House	01/08/2016	Works in progress
108 Quarry Road	House	04/05/2016	Works in progress
66 Saint Attracta Road	House	28/09/2016	Works in progress
33 Villa Park Gardens	House	25/07/2016	Detenancing (O'Devaney Gardens)
5 Villa Park Drive	House	18/08/2016	Works in progress

There are currently 15 vacant senior citizens units in the Finglas area

Address	Type of Unit	Date of vacancy	Remarks
6 Brookville Court	1 bed	20/09/2016	Works in progress
12 Clareville Court	1 bed	08/06/2016	Works in progress
29 Clareville Court	2 bed	24/04/2016	Works in progress
33 Clareville Court	Bedsit	12/09/2016	Works in progress
41 Clareville Court	Bedsit	28/06/2016	Works in progress
50 Clareville Court	1 bed	22/06/2016	Works in progress
59 Clareville Court	1 bed	07/04/2016	Works in progress
70 Clareville Court	Bedsit	26/08/2016	Works in progress
11 Kilshane Court	2 bed	09/05/2016	Wheelchair Accessible
3 Mellowes Court	Bedsit	02/09/2016	Works in progress
42 Mellowes Court	Bedsit	26/09/2016	Works in progress
58 Mellowes Court	1 bed	06/09/2016	Works in progress
60 Mellowes Court	1 bed	02/09/2016	On offer
1 Merville Court	1 bed	10/07/2016	On offer
35 Merville Court	1 bed	28/09/2016	On offer

There are currently 10 vacant senior citizens units in the Cabra area

Address	Type of Unit	Date of vacancy	Remarks
19 Convent View Cres	Bedsit	09/06/2016	Works in progress
26 Convent View Cres	Bedsit	28/02/2016	On offer
27 Convent View Cres	Bedsit	16/05/2016	On offer
35 Convent View Cres	Bedsit	18/08/2016	Works in progress
27 Dunard Court	1 bed	06/12/2015	On offer
48 Dunard Court	Bedsit	02/08/2015	On offer
50 Dunard Court	Bedsit	18/07/2016	Works in progress
51 Dunard Court	Bedsit	03/05/2016	On offer
20 Rowan Hamilton Court	1 bed	11/05/2016	On offer
22 Rowan Hamilton Court	1 bed	4/09/2016	On offer

125 Carnlough Road

The Keyworker (case officer) who is looking for succession to tenancy on the applicant's behalf has been in discussion with the area office in connection with this dwelling. During these discussions it was stated Dublin City Council intends to remove all items and clear the house after the 17th October.

Rents Update

The Finglas Area Office continues to provide a rent assessment service for tenants living in the Finglas and Cabra areas.

Finglas Rent Assessment Update	
Assessments	90
Permission To Resides	5
Refunds	3

Barry Area

Meetings have been held with staff from the Local Area Office, the Anti-Social Policy Unit and the Law Department in relation to a problem tenancy in the Barry area. A decision was made to initiate legal proceedings for the recovery of the dwelling.

Fairlawn Park

An abandoned private house at 9 Fairlawn Park has been the source of a lot of anti-social behaviour over a number of months. The Local Area Office has attempted to secure the property on several occasions by steeling all entries into the dwelling. On Saturday 1st October a fire was started at the side of the house which caused the roof to catch fire and collapse: two neighbouring houses have been damaged due to this.

Over the last number of months the Area Office has been looking at different avenues of securing this house. Parts of the boundary wall have been steeled and we installed palisade fencing, all which has been dismantled by local gangs. On 12th October, Kelly Blocks (large concrete blocks) were installed to stop individuals gaining entry from Prospect Hill into Fairlawn Park.

Barnamore Road

25/25a Barnamore Park are private Houses and are owned by the same individual. The Local Area Office has been in discussion with the letting agency in relation to anti social issues/behaviour from these addresses. The Area Office has been informed by the Letting agency that they no longer have any input in these houses. The Letting Agency has been requested to ask the owners to contact Dublin City Council. The owner is out of the country. Derelict site have been informed of our concerns and issues.

Saint Finbarr's Court.

The Planners have rejected the proposed apartments for St. Finbarr's Court as presented at the September Area Committee Meeting. The proposal will have to change to the larger 1-bed units. This will delay the official launch of the Part 8 process by about a week.

It is hoped to have Block 2 in St. Finbarr's Court detenanted by December.

Rapid Housing - St Helena's Drive Update

Dublin City Council has appointed ABM Construction to design and build 39 houses at St. Helena's Drive (11x 3 bedroom units and 28 x 2 bedroom units).

Work is scheduled to commence on Monday the 17th of October. The works are scheduled to be completed in 32 weeks.

One house has been removed from the original plan to facilitate the building of a new back boundary wall between house numbers 11 to 17 Gortmore Drive.

The new boundary wall will be 7 meters out from the original boundary wall and will allow the residents extend their existing gardens out to the new boundary.

It will also allow most of the existing tree line to remain in place and the existing trees will be in the extended garden.

Three trees will remain outside the wall on the housing site. However, two of these trees may have to be removed. The remaining tree will remain in a garden of one of the houses in the new housing development.

Aidan Maher
Assistant Area Manager

**The Chairman and Members of
North West Area Committee.**

Meeting: 18th October 2016

Item No: 6

Finglas Area Office Report

Update on Kildonan Lands Project

Ed Flanagan has submitted an interim report on the public consultation process and results to date. The completion of this process has been extended to ensure that all relevant stakeholders, particularly residents in the adjoining streets, are given sufficient opportunities to have an input.

Brady Shipman Martin (BSM) continues to progress the masterplan options using the criteria listed in the September update. They will submit their draft report to the Development Group (DG) after analysis of the final consultation report.

The next meeting of the DG is provisionally fixed for the 27th October.

Finglas Safety Forum

The interviews for a new Coordinator for Finglas Safety Forum have been successful. Ms. Jackie Phelan has accepted the job and she is due to start on the 17th October.

COMMUNITY & SOCIAL DEVELOPMENT

Finglas Social Inclusion/Positive Ageing Week 2016

The Dublin City Council Community Team in conjunction with Finglas Positive Ageing Committee organised a number of events for Positive Ageing Week/Social Inclusion Week. The activities took place from Monday 26th September to Saturday 8th October this year.

Tai Chi

Over 20 people attended the Tai Chi session in the Finglas Leisure Centre, on Monday 26th September. Groups have since signed up to 10 sessions of tai chi over the coming months.

Over 55's Table Quiz

The Table Quiz was held on Wednesday 28th September in Erin's Isle GAA Club. Thirteen teams of five people per team took part. The winning team was presented with a trophy and vouchers. A great night was had by all.



Chair Aerobic

Chair Aerobics were held on Thursday 29th September at Odinswood Day Care Centre. Over 20 people participated in this event.

Finglas Senior Citizens Ball

Up to 300 people attended our annual senior citizens ball, Wednesday 5th October. It was a great night and enjoyed by all in attendance.



Afternoon Tea Dance

The Finglas Afternoon Tea dance group hosted a tea dance in WFTRA Hall on Thursday 6th October. The event was free of charge and open to the general public. Over fifty people attended this event.

Over 55's Pool Tournament.

An over 55's pool tournament took place in Merville Court Senior Citizens Complex on Friday 7th October. Over thirty people took part from the North side of the city.

Variety and Talent Show

Rivermount Drama and Variety Group presented A Variety and Talent Show In Erin's Isle GAA Club on Friday 7th October and Saturday 8th October. Our Community and Social Development section supported the group with this event.

North West Area LECP Consultations

North West Area Community Consultations for the new statutory Dublin City Local Economic and Community Plan 2016 – 2021 took place on the following dates.

- 14th September: Finglas Youth Resource Centre
- 19th September: Ballymun Civic Offices
- 26th September: Deaf Village Ireland

In addition to the above public events, community groups in the area were invited to participate and give their views as part of an on-line survey.

The consultation gave communities an opportunity to drop in and give their views on what should be included in the 2017 Action Plan.

Dublin City Council Community Grants Scheme:

Dublin City Council Community Grants Scheme is now accepting applications. Closing date for applications is Friday 28th October 2016 at 5.00pm. All grants should be returned to Dublin City Council, Community & Social Development, Block 3, Floor 1, Civic Offices, Wood Quay, Dublin 8.

Application forms are available from Community Development Staff in all NWA offices.

The Community Grants Scheme encourages community participation and assists local community groups in the delivery of their programmes:

Dublin City Council-Arts Grants 2017:

Dublin City Council – Art Grants are now available. Closing date for the receipt of completed applications is Tuesday 1st November 2016.

All applications should be sent to: Arts Grants Applications, Dublin City Arts Office, The Lab, Foley Street, Dublin 1. Telephone: 2225455

Halloween

Plans for this year's Finglas Halloween Festival are well underway. The event will commence at 6.00pm and run until 9.00pm on Monday 31st October.

Community participation is key to the success to the Halloween Festival. Dublin City Council will meet with volunteers on Monday 17th October at 6:30pm to allocate stalls and to brief volunteers on health and safety procedures.

Barnardos/Springboard Barry Close:

Barnardos Family Support Project offers information, help and support to children, young people and their parents/carers. The Centre has an 'open door' policy meaning that it is available to any parent, carer or child in the West Finglas area.

Unfortunately due to the high level of anti-social behaviour the Barnardos/Springboard is no longer operating from Barry Close. Dublin City Council is working with the Manager of the Springboard project to identify appropriate premises in the Finglas West area to enable this essential service be maintained.

Older Persons Expo 2016:

Dublin City Council Community and Social Development Team will invite groups working with Older People to attend an Older Persons Expo. This event will take place on Wednesday 30th November in WFTRA Hall, Mellowes Road, Finglas, Dublin 11.

The Expo will be an opportunity for groups in attendance to promote themselves, encourage new membership and share information with people who attend from the community.

Aidan Maher

Assistant Area Manager

**The Chairman and Members of
North West Area Committee.**

Meeting: 18th October 2016

Item No: 7

With reference to the proposed disposal of a plot of land on the Finglas Road, Dublin 11 to the Ardmore Care Home Group Ltd.

An application has been received by the Ardmore Care Home Group Ltd to purchase the plot of land adjacent to their property for gardening purposes.

Agreement has now been reached regarding the disposal of a plot of land on the Finglas Road to them, subject to the following terms and conditions:

1. That the subject plot, with an approximate area of 354m², is located on the west side of the Finglas Road, immediately to the north of the Ardmore Care Home, Finglas, Dublin 11.
2. That the Council grant a lease, co-terminus to the Ardmore Care Home leasehold interest of 250 years from 1st January 2005, registered on folio 1440262.
3. That the rent shall be €500 (five hundred euro) per annum subject to five yearly rent reviews linked to changes in the consumer price index.
4. That the land is used solely for gardening/landscape purposes.
5. That the manhole on the 1500mm x 150mm culvert into which the 525mm pipe from Glenhill Road connects, is to be exposed and made fully accessible in any proposed landscaping works.
6. That the Drainage Division of Dublin City Council is granted clear unobstructed access to the site at all times for maintenance purposes.
7. That a way leave agreement is entered into in respect of the area 5m either side of the culvert and the 525mm pipeline.
8. That no building/construction works are permitted on this site.
9. That the applicant will submit plans/drawings regarding suitable boundary works for approval.
10. That the applicant will be responsible for all other costs incurred in the inclusion of this land within its boundary.

11. That the applicant shall pay the Council's valuers fee of €1,500 (one thousand five hundred euro) plus VAT plus the Council's legal costs of conveyancing.
12. That this agreement is subject to the necessary consents and approvals being obtained.

The dates for the performances of any of the requirements of the proposed agreement may be amended at the absolute discretion of the Executive Manager.

The disposal shall be subject to any such covenants and conditions as the Law Agent in his discretion shall stipulate.

No Agreement enforceable at law is created or intended to be created until an exchange of contracts has taken place.

Paul Clegg

Executive Manager

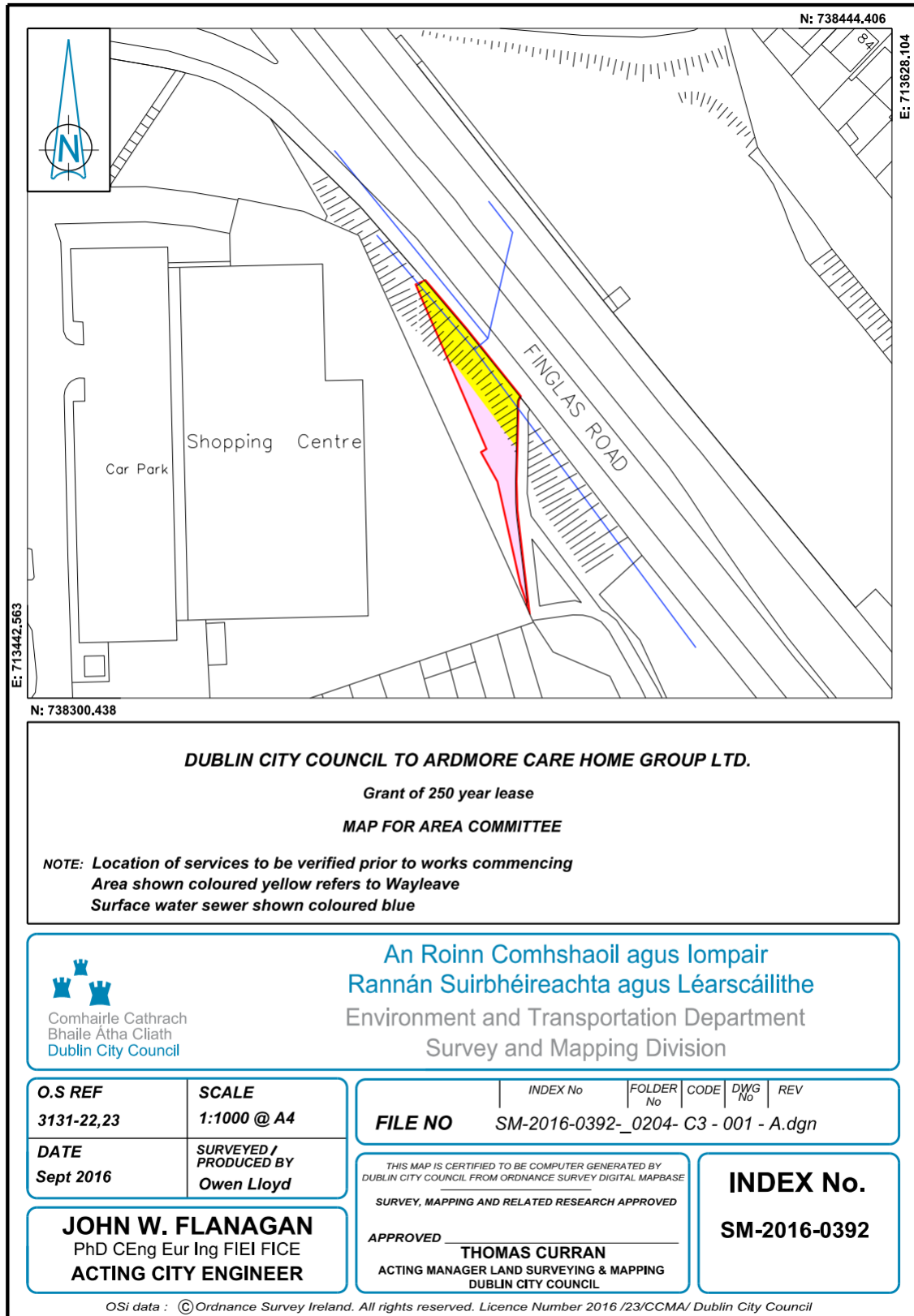

This page is intentionally left blank

**The Chairman and Members of
North West Area Committee.**

Meeting: 18th October 2016

Item No: 13

PUBLIC DOMAIN REPORT

North West Area Complaints received via CRM

The CRM is the system used by DCC Customer Services Centre and all departments to log and track complaints. Please see details below of the number of complaints received / investigated and closed by the North West Area Office from 1st September to 30th September.

Type of Complaint	Count of Incidents
Abandoned Bicycles or Trolleys	2
Bonfire Materials	5
Community Cleanups	8
Electoral Poster Complaint	1
FYS: Graffiti	1
Illegal Dumping	98
Nameplates	1
Overflowing Skips	3
Pothole	1
Public Litter Bin Maintenance	1
Report Dead Animal	1
Report Dog Fouling DCC	1
Report Graffiti	20
Report Litter Offence	8
Sweep Your Street	6
Tree Maintenance	3
Weed Control	2
	162

It is important to note that a significant number of additional complaints were also investigated as all area staff pick up complaints when carrying out daily duties but due to lack of resources all complaints are not logged.

City Neighbourhoods Award Winners North West Area

Residents/Environmental groups did the North West Area proud at the recent citywide awards ceremony, hosted by the Lord Mayor Brendan Carr, in Croke Park on the 29th September. A special well done to Courtlands who won the overall award.

Dublin City Neighbourhood Awards 2016 Overall Winner

Courtlands

Category Winners:

151-300 Houses – Courtlands

Best Urban Village – Drumcondra Tidy Village Group

Global Action Plan – Sustainability Initiative

Open Green Space – The Flowerpots, Doon Court

Business Competition – Global Action Plan

Team Dublin Clean up (Joint Winners) – Phibsborough Tidy Village Group

Runners up:

1-150 Houses – Belclare Residents Association

Over 300 Houses – Willow Park and Pinewood Residents Association.

Individual Contribution (Joint Second) – Karen McKevitt, Doon Court,

Endeavour Award (Most Improved Entry) - St Peters Environmental Group

Third Place:

Community Environmental Initiative – Glór na nGael, Dublin 11

Best New Entry – Doon Court Environmental Group

Best Garden – Rhonda Riordan, Coultry Way

Enhancements

As a result of representations from local residents a new kissing gate was recently installed between Willow Park Road and Poppintree Crescent to prevent the passage of scrambler motor cycles and to help alleviate some of the reported anti-social behaviour in the area. More planters have also been provided by the Public Domain Team to Environmental Groups throughout the NWA, including on Faussagh Avenue, Ballymun Courts and Belclare Park and Grove. Work has also commenced by DCC Parks on the raised beds at the entrance to Ratoath Estate, with the moving of the decorative sign into a newly constructed raised bed, which is due to be planted shortly.



The new raised bed recently installed at Ratoath Estate and the kissing gate fitted at the laneway between Willow Park Road and Poppintree Crescent

Halloween

In an effort to minimise the amount of flammable material appearing on bonfires the Public Domain Team and Housing Staff are currently distributing leaflets reminding residents of their legal responsibilities, under the Litter Pollution Act 1997, to ensure that waste disposed of does not end up on an illegal bonfire. The damage caused to green spaces by illegal bonfires has also been highlighted. In addition, visits have been paid by the Public Domain Team, accompanied by Litter Wardens, to Industrial Units around the NWA to inform businesses of their obligation to secure pallets and other flammables.

The Public Domain Team is closely liaising with the Gardai and other departments within DCC in relation to arrangements to collect bonfire material prior to and on the day of Halloween itself. In addition, additional resources have been secured to assist in bonfire clearance in the NWA over the Halloween weekend.

The Finglas “Fright Night” Halloween Festival will take place on Halloween night 31st October, commencing at 6pm at the Finglas Civic Centre. The Ballymun “Otherworld Festival” is also taking place at the Plaza on Main St, Ballymun. These events have, in previous years, been very successful in diverting young people away from illegal bonfires.

To report bonfire material to the NWA Public Domain Team Tel: 01-222 5412 / 6754 / 5407 / 5400, email nwa.publicdomain@dublincity.ie or phone DCC Customer Services on 01-2222222. Bonfire material can also be reported after hours to 01 – 6796186.

Tidy Towns Reports

Our NWA representatives in the annual Tidy Towns competition did the area proud again this year with all three getting favourable reports and increasing their scores when compared to 2015. Phibsborough improved greatly, increasing its marks from 236 to 253. Ballymun also increased its scoring from 272 to 281 and Finglas from 276 to 281. These excellent results reflect the hard work done during 2016 by our Tidy Towns Groups in all three areas.

Blue Bag Leaf Collection Scheme

In addition to the usual assistance to residents and environmental groups, the Public Domain Team will also provide bags and equipment to enable them to run leaf clean up events in their areas. Groups can then contact the team to arrange to have the bags collected. This assistance is especially targeted towards areas in estates and off main roads where resource limitations may prevent DCC from engaging in frequent leaf collections. Groups can contact the Public Domain Team on 01-222 5412 / 6754 / 5407 / 5400, email nwa.publicdomain@dublincity.ie or phone DCC Customer Services on 01-2222222.

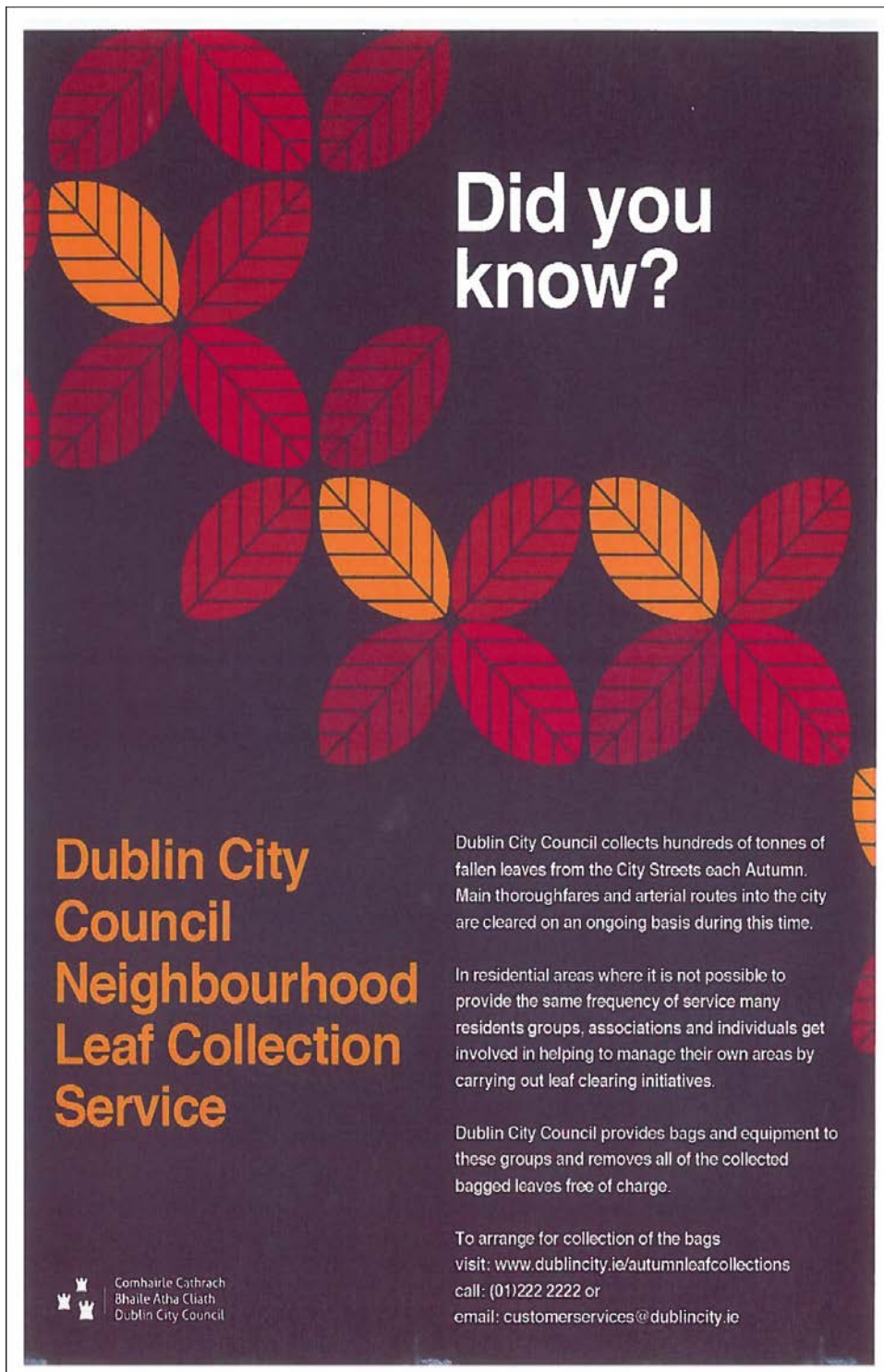

Did you know?

Dublin City Council Neighbourhood Leaf Collection Service

Dublin City Council collects hundreds of tonnes of fallen leaves from the City Streets each Autumn. Main thoroughfares and arterial routes into the city are cleared on an ongoing basis during this time.

In residential areas where it is not possible to provide the same frequency of service many residents groups, associations and individuals get involved in helping to manage their own areas by carrying out leaf clearing initiatives.

Dublin City Council provides bags and equipment to these groups and removes all of the collected bagged leaves free of charge.

To arrange for collection of the bags
visit: www.dublincity.ie/autumnleafcollections
call: (01)222 2222 or
email: customerservices@dublincity.ie

 Comhairle Cathrach
Bhaile Átha Cliath
Dublin City Council

Graffiti Removal Initiative

Over the last number of weeks there has been a concentration on graffiti removal in the Drumcondra area. Members of the Public Domain Team have surveyed the area and reported graffiti found to the DCC Graffiti Removal Crew. The areas covered have included the Drumcondra Road from Whitworth Road to Collins Avenue, St Alphonsus Road, Iona

Road, Hollybank Road and the surrounding residential areas. Removal work has also been conducted on the stretch between Doyle's Corner and St Mobhi Road.

Other areas where quantities of graffiti have been removed include Santry Lane, Ratoath Road and the Finglas Road.

JOHN TWAMLEY
PUBLIC DOMAIN OFFICER

This page is intentionally left blank

The Chairman and Members of
North West Area Committee.

Meeting: 18th October 2016

Item No: 14

Sports and Wellbeing Partnership Report

- **Marathon Kids** is a citywide running programme developed to encourage 6th class pupils to embrace healthy, active lifestyles. The aim of the programme is to inspire children to run over eight weeks to accumulate the equivalent distance of a Marathon – 26.2 miles!

DCC Sport & Wellbeing Partnership have teamed up with Fingal County Council to build on the very successful programme rolled out by Fingal in 2015, which saw twenty two primary schools and over six hundred kids take part in this unique event. The 2016 programme commenced in September and will carry through until mid November.

Pupils perform four running sessions each week, inching them closer to completing their first marathon. There are four schools from Ballymun and one from Glasnevin taking part.

Resource booklets have been distributed to all pupils to assist with motivation and learning. All participants will be invited to a 'final mile' event and celebration to be held in the National Sports Campus, Blanchardstown.

- **Fun and Games Programme with Mellowes Springs Childcare Centre:** A six week Fun and Games Programme commenced with children in the 4-10 age group from Mellowes Springs Childcare Centre on Wednesdays in October. The programme is aiming to improve the children's movement, balance and co-ordination skills through participation in fun and games activities.
- **Multi Sports Mini Games Programme with Finglas Youth Resource Centre** A six week mini games multi sports programme commenced for children in the 10-13 age groups from the Finglas Youth Resource Centre on Friday October 7th. Activities include uni hockey, spike ball, olympic handball, tug of war and indoor soccer. Children from the after school programme are also undertaking introduction Kayaking sessions at the Ballyfermot Outward Bounds centre on Thursday October 6th, 13th and 20th.
- **Outdoor Programme - Secondary School** This is a 6 week programme involving young males referred by the youth service. The programme involves outdoor activities based in various locations throughout the city for example hill walking, swimming, etc. The aim of the programme is to give participants the chance to learn

new skills and work in a team whilst in a fun, physically active and challenging environment. This programme is run in partnership with the local youth service.

- **Ballymun Active Retirement Walking group** The walking group meet every Tuesday morning at 10.20am in Ballymun Axis. Each week they go for approximately 5k walk in different parks; Albert College Park, Poppintree Park, and Santry Park. Followed by a meet up in the Axis Centre. Cost is free. All abilities welcome!
- **Go for Life – Older Adults Programme** - This programme runs every Monday from 1-2pm in Cabra Parkside Community and Sports Complex. The aim of the programme is to promote physical activity and encourage social support within the participants. The programme involves three throwing games where participants throw, lob and bowl items towards a target. The sessions are guided by the participants in terms of competitiveness and challenge matches against other groups across the city are planned.
- **Boxing Silver Sessions Programmes** – The Silver Programme is a little more intense than the Bronze and involves Body Sparring, in contrast, to the 'target practice' on knees and elbows of the Bronze. Participants will start to use head gear and gum shields in case of accidents, but will be watched with a view to being chosen for the Gold Programmes and hopefully, Showcase Finals, as we progress further. Currently, there are Transition Year students participating from Finglas, Whitehall, Ballymun and Glasnevin; while, younger students attending 5th and 6th classes, are taking part, from Finglas and Ballymun.
- **Boxing Primary School Programme** - This is a six week programme involving 6th class pupils from a local Cabra School. The programme is delivered by Dublin City Council Boxing Officer Paul Quinn in partnership with the DCC Sports Officer Maz Reilly and begins on 9th November. Young people take part in six boxing sessions conducted in the High Performance Unit beside the National Boxing Stadium with the final showcase taking place inside the stadium. During the programme participants learn about technique, commitment and sportsmanship.
- **Kickstart 1** - The FAI Community Development Officers will provide all the coach education from Kickstart 1 up to Youth Cert Level/National 'C' Licence (which will also see the students do coaching experience in schools and with local community groups and clubs).
- **Walking Football** – This programme is delivered every Tuesday from 11-1pm in Cabra Parkside Community and Sports Complex. The session is delivered in partnership with Cabra Development Programme and the FAI. The programme is open to men aged 55 years and older. It involves the same rules as ordinary soccer except players are not allowed to run. The aim of the programme is to provide an opportunity for men to take part in physical activity in a fun, friendly and social setting.
- **The Ballymun/Finglas Football Foundation Course (Project FUTSAL)** commenced on September 12th and will run until June 2017. Project FUTSAL stands for '*Football Used Towards Social Advancement and Learning*'. There are approx twenty participants on the course, both male and female. In conjunction with Whitehall College they will be studying for the FETAC Level 4/5 Sport and Recreation, while also working with Waverley Academy to do the ITEC Fitness Instructors Award (commencing January 2017).

- **Ballymun Bulldogs** - Mini rugby pop up club run in partnership with Leinster Rugby officer Stephen Maher every Monday 4-5pm in Poppintree community sports centre. Girls and boys aged 9-12 welcome, no experience necessary. Cost €1.
- **Cabra Crusaders** - Mini rugby pop up club run in partnership with Leinster Rugby officer Stephen Maher every Thursday, Cabra Parkside Community Centre.
- **Table Cricket** (cricket designed for physically challenged participants) will be starting with a group in Poppintree Sports Centre (dates in October and November to be confirmed).

Contact details

Antonia Martin, Manager, Sports Officers: antonia.martin@dublincity.ie
 Maz Reilly, Sports Officer: marielouise.reilly@dublincity.ie
 Niall Mc Donald, Sports Officer: niall.mcdonald@dublincity.ie
 John McDonald, Sports Officer: john.mcdonald@dublincity.ie
 Eileen Gleeson, Sports Officer: eileenb.gleeson@dublincity.ie
 Jamie Wilson, FAI Soccer: jamie.wilson@fai.ie
 Paul Whelan, FAI Soccer: paul.whelan@fai.ie
 Oisín Fagan, Boxing: oisinfagan@gmail.com
 Fintan McAllister, Cricket: fintan.mcallister@cricketleinster.ie
 Stephen Maher, Rugby: stephen.maher@leinsterrugby.ie

Report by

Alan Morrin, Staff Officer

This page is intentionally left blank

**The Chairman and Members of
North West Area Committee.**

Meeting: 18th October 2016

Item No: 15

Dublin's Culture Connects: The National Neighbourhood Project

Dublin City Council's new cultural programme, **Dublin's Culture Connects**, was officially launched on the 27th September 2016 by The Lord Mayor Brendan Carr and Minister for Arts, Heritage, Regional, Rural and Gaeltacht Affairs, Minister Heather Humphreys, TD at a special event in The Mansion House. It was attended by all of the National Cultural Institutions in Dublin, many of the community groups who are involved in the projects, Dublin City Councillors and many more.

Following on the adoption of a new Cultural Strategy in 2016, **Dublin's Culture Connects** is a series of legacy projects developed from the Dublin 2020 Capital of Culture Bid. The National Neighbourhood Project is an innovative programme creating new connections and partnerships across Dublin between Neighbourhoods, National Cultural Institutions, City Libraries, Artists, and the City. Spanning the Dublin City Council region, the project, for the first time, brings together the Dublin City Council Arts, cultural and community resources in partnership with all eight National Cultural Institutions located in Dublin. These are The Abbey Theatre, The National Museum of Ireland, The National Library of Ireland, The National Gallery of Ireland, The National Concert Hall, The Chester Beatty Library, The National Archives and The Irish Museum of Modern Art. Each of the Council's five administrative areas has been partnered with National Cultural Institutions.

The core value of **Dublin's Culture Connects** is the public and cultural community working together to develop projects based on shared ideas. It was devised following extensive consultation with the city's communities. All of the programmes focus on new partnerships and on new ways of working, that acknowledge how culture can bring neighbourhoods together.

Lord Mayor Brendan Carr commented: "I am delighted to see that all the work that went into our Capital of Culture bid is being rewarded. Thousands of Dubliners engaged with Dublin City Council over a number of months to suggest projects and programmes and The National Neighbourhood is just one of the great ideas to come out of the process. Culture is an important part in building neighbourhood spirit and it is an ambition of Dublin City Council to continue to give the opportunity for people to learn and participate in the arts in their neighbourhood in all parts of the City.

Minister for Arts, Heritage, Regional, Rural and Gaeltacht Affairs Heather Humphreys TD added: "A spirit of working together, of partnership, and creative collaboration has been the striking feature of everything we've seen throughout this special year of Commemoration.

We've seen how positively communities respond if you empower them to express themselves. I am delighted to see this approach to collaboration embodied in the Dublin's Culture Connects initiative. It is helping to build an ever expanding partnership between citizens and the cultural community, developing new audiences, encouraging participation and supporting our great artists and cultural organisations. By creating better links between members of the public and the cultural community, we can open communities up to the benefits of cultural engagement. Embedding cultural activity and expression within communities will help to create a healthier, more vibrant society. I hope the National Neighbourhood project can be used as a template for other regions and communities across the country, as we seek to constantly break down barriers to artistic and cultural participation."

About Dublin's Culture Connects: The National Neighbourhood projects

- **The National Neighbourhood: Press Play**

Dublin City Council will 'press play' on creativity in Finglas, Cabra, Ballymun and Whitehall. A series of pop-up contemporary museums of 'new treasures' will be created around the theme of play, in response to the Out of Storage exhibition at The National Museum of Ireland. Community partners include New Cross College, Margaret Aylward Community College, the Deaf Village and Cabra Parkside Community Sports Centre. The Abbey Theatre will also link with artists and the neighbourhood to create stories of identity, song and sport that grow from the pop-up museums.

- **The National Neighbourhood: It takes a Village**

What is it that creates a sense of neighbourhood in the place you live? Partnering with the Irish Museum of Modern Art, Dublin City Council is looking at how a village is made. Artists such as Seoidín O'Sullivan and architect Roísín Byrne are partnered with Belmayne Youth Group and former Communiversity students in Coolock, who will share their experiences and consider alternative community hubs in their neighbourhood. Men's Sheds groups from Ayrfield, Artane, Priorswood and Donaghmede, Raheny, Age Friendly Group and St Benedict's Photographic Group, will work across the generations to support the residents across the area in new neighbourhood initiatives.

- **The National Neighbourhood: Around the Table**

Dublin City Council will connect communities old and new across Dublin's historic central area with artists of different disciplines and the National Library of Ireland to explore the Library's collection. Themes of mothering, belonging, words and work will be shared through mapping the story, role and journey of food in the city, from the docks, to the markets and from the streets, to the table. Artists Jennie Moran, Jeanette Lowe and Donal Fallon will work together with Dublin Adult Learning Centre, Mountjoy Square; Dublin Dockworker's Preservation Society, East Wall; Just ASK Afterschool Klub; Smithfield and Stoneybatter People's History Project; and The Snug Women's Group, Green Street.

- **The National Neighbourhood: (y)our Story**

Did you know that there are 185 languages spoken in Dublin by 182 nationalities? Dublin City Council is working with artists and communities in Ballyfermot, Drimnagh and South Circular Road on the theme of storytelling. The projects work on telling, sharing and co-creating 'our' story, with support and inspiration from the collection and programmes of the National Concert Hall and the Chester Beatty Library. Stephen James Smith will engage communities from theatre and Traveller

backgrounds through spoken word and poetry; the musician Sam Kavanagh will sing with 10-14 year olds of Irish and Filipino heritage at the Bosco Youth Centre. They will compose and perform a new song. Two women's groups from the South Circular Road - the Islamic Foundation Amal Group and the newly formed Local Women's Knitting and Craft Group - are working with visual artist Helen Barry, videographer Hanan Dirya and story teller Xanthe Gresham.

- **The National Neighbourhood: Light Waves**

A bus trip will take us on a journey of discovery through local neighbourhoods. Dublin City Council is working with CoisCéim Dance Theatre, Dublin City Gallery, The Hugh Lane and the National Gallery of Ireland with communities from Irishtown, Ringsend, Sandymount and Pearse Street. Together, the partners will work on exploration, connection and disconnection with neighbouring Dublin villages and each other. A specially commissioned Number 1 bus will connect these neighbourhoods to the Hugh Lane Gallery and the National Gallery, as well as to the sea, the river and the canal, and offers opportunities for participation along the route. Riccy's Youth Café; Sandymount Dodder Sea Scouts; Sandymount Tidy Towns; Spellman Centre and Andrew's Resource Centre along with visual artist James Ó hAodha will also work with some of these communities on a project that explores maritime signalling systems.

- About Dublin's Culture Connects

The Dublin's Culture Connects programme is made up of four pillars: Dublin's Culture Connects: The National Neighbourhood; a new EU Funding Unit; support and training for cultural and community groups in the area of fundraising, the Fundraising Fellowship partnership with Business to Arts; and a new cultural audit and mapping project as part of the recently adopted Dublin City Development Plan.

www.dublincultureconnects.ie

Ray Yeates
Arts Officer

This page is intentionally left blank

Dublin City Council

Social Housing Delivery Report

3rd October 2016

Dublin City Council Targets under Social Housing Strategy for 2015-2017: 3347 Units

Capital Programme Target is 1498 units under the Social Housing Investment Programme (SHIP) - Capital Works Management Framework applies

Current Programme Target is 1849 units under the Social Housing Current Expenditure Programme (SHCEP)

COLOUR CODE	
BLUE	WITH COUNCIL
YELLOW	WITH AHB

Abbreviations and Definitions:

AHB – Approved Housing Body

CALF – Capital Advance Leasing Facility – up to 30% Capital injection to AHB's (SHCEP)

RAS – Rental Accommodation Scheme

Leasing – Long term leasing from private landlords or AHB's (SHCEP)

HAP – Housing Assistance Payment

Construction/Regeneration – DCC projects funded under SHIP

CAS – Capital Assistance Scheme (100% grant to AHBs under SHIP)

Acquisition – Purchase of previously built units (SHIP)

	2015	To 30 th September 2016
Units Completed to date	565	332
Voids turned round to date	1012	713
HAP Tenancies	112 (Dublin Region)	561 (Dublin Region)
Outturn	1689	1606

	2015	2016	2017	2018	2019	2020	Total
Outturn	1689	1606					3295
Units under construction		63	338				401
Units currently being acquired		258	15	97			370
Part V		25	26				51
Units at Tender Stage		0	19	194			213
Capital Appraisals Submitted to Department		64	48	318	200		630
Units at Preliminary Planning/Design		19	41	266	399	105	830
Potential Units from Vacant Council Lands						500	500
Sites for Social housing PPP Bundle 1						200	200
Projected Acquisitions			100	100	100		300
Rapid Home Delivery			201	100			301
Total	1689	2035	788	1075	699	805	7091

Schemes completed to date in 2016 – Department of Housing, Planning, Community and Local Government (DHPCLG) Capital Works Management Framework (CWMF) Stage 4

Committee Area/ Housing	Provider	Schemes	Funding Programme	No of Units
-------------------------	----------	---------	-------------------	-------------

Category				
South East / General Needs	Dublin City Council	Maxwell Road, D6	Regeneration	9
North West /Special Needs	Dublin City Council	Rapid Home Delivery - Poppintree	LA housing	22
South East /General Needs	Dublin City Council SE. GN	Crampton Buildings	Remedial Works	28
General Needs	Dublin City Council.	General Acquisitions	LA housing	101
General Needs/Special Needs	Dublin City Council	RAS Agreements and Leasing Arrangements	RAS/SHCEP	40
General Needs	Dublin City Council	RAS Acquisitions	RAS Capital Reserve	10
North West /Special Needs	Fold Housing Association	Ballygall Road Phase 2, Dublin 11	CALF & Leasing	11
South Central / General Needs	Tuath	An Riasc	CALF & Leasing	14
North Central / General Needs	Tuath	Thornwood, Beaumont, Dublin 9 Phase 1,2, 3, 4 and 5	CALF & Leasing	46
North Central / Special Needs	Co-Operative Housing Ireland	Merville Court, Fairview, Dublin 3	CALF & Leasing	10
Central/South Central/ South East – General Needs	Various AHBs	Various addresses	CALF & Leasing	9
North West	Various AHBs	Various addresses	CALF & Leasing	2

			(Congregated Settings	
South Central, South East, - Special Needs and General Needs	Peter McVerry Trust	Various addresses	Leasing	19
Central, South Central – Special Needs	HAIL	Various addresses	CAS	11
	Total			332

	Schemes Under Construction – DHPCLG CWMF Stage 4						
Committee Area/ Housing Category	Provider	Schemes	Funding Programme	No of Units	Status	Next Milestone	Expected Completion Date
North Central – General Needs	Dublin City Council	Buttercup Darndale, D 17	LA Housing	35	Under Construction	Under Construction. Phase 1 completion (6 units)	Q4 2016
North Central – General Needs	Dublin City Council	Priory Hall, D 13	LA Housing	35 (180)	Under Construction. Phases 1-5 (Blocks 1 – 7) complete. Approval to proceed to tender for Phase 6 (blocks 8 – 20)	1. Launch of New Priory units (Blocks 1-7) on 13 th October 2016. 2. Phase 6 (Blocks 8-20) to be tendered Oct 2016.	Q3 2016 Q4 2017
South East – General Needs	Dublin City Council	Charlemont (BI 3) Dublin 2	PPP	79	Development Agreement signed with Developer 14th Dec 2015. Contractor on site	Handover of units	Q3 - 2017
South Central – General Needs	Dublin City Council	Dolphin House, D8 Phase 1	Regeneration	100	Tender for the main contract prepared. Approved 8 th April 2016. Tenders issued 11 th April, 2016. Tenders returned 25 th May –sent to DECLG 29/06/16. A revised capital appraisal sent to DECLG. Approval received from DECLG to appoint selected contractor. Contract signing 23 rd September, 2016. Demolitions complete.	1. Contractor on Site 2. Phase 2 design to be developed	Q4 - 2017
South East – Special Needs	AHB	Harolds Cross D6 (Focus)	CALF & Leasing	28	On site November 2015. Department approved revised funding.	Completion of works	Q4 2016

South Central – Special Needs	AHB	Annamore Court (Canon Troy) D10 (The Iveagh Trust)	CALF & Leasing	70	DCC property. On site November 2015	Completion of works	Q3 2017
North West – Special Needs	AHB	Broome Lodge (Dunmanus) D. 7 (Cluid)	2014 CAS (10 units) & CALF and Leasing (33 units)	43	DCC site. Contractor started on site 7 th March 2016. CAS charge will be on 10 identified units. HFA funding approved on 3/3/16.	Completion of works	Q2 2017
Central Special Needs	AHB	St. Agathas Court (Peter McVerry Trust)	2014 CAS	11	DCC property. Department issued revised budget approval. On site.	Completion of works	2017
	Sub total			401			

	Units Currently Being Acquired – DHPCLG CWMF Stage 4						
Committee Area/ Housing Category	Provider	Schemes	Funding Programme	No of Units	Status	Next Milestone	Expected Completion Date
	Dublin City Council	General Acquisitions	LA Housing (Acquisitions)	82	With Law Department	Closing of Acquisitions ongoing	2016
North West – General Needs	AHB	An Riasc, Farnham Drive, Finglas, Dublin 11 (Tuath)	CALF & Leasing	35	1 st and 2 nd phase complete (14 units), Phase 3 to complete October	1 st and 2 nd phase complete. Phases 3, 4 & 5 to be acquired 2016	Q3/Q4 2016
South Central – Special Needs	AHB	Armagh Road D 12 (FOLD)	CALF & Leasing	97	Approved for CALF & Leasing	Contractor to commence on site Nov 2016	Q1 2018
North West – General Needs	AHB	Thornwood, Beaumont, Dublin 9 (Tuath)	CALF & Leasing	22	Approved by Department for CALF & Leasing March 2016	Tuath to acquire units over 7 phases. 46 units acquired to date	Q4 2016
North Central-General Needs	AHB	St. Pauls Court, Ard na Greine, Dublin 13 (Co-Operative Housing Ireland)	CALF & Leasing	11	Approved by Department June 2016. Some units still tenanted, resolution to be found re these units	to be acquired	2016
Central-General Needs	AHB	Castleforbes Square (Tuath)	CALF & Leasing	21	Contracts stage (this is separate to DCC acquisition). Revised funding approved by Department	to be acquired	Q4 2016
South Central-General Needs	AHB	James Street (Cluid)	CALF & Leasing (NAMA)	12	For RAS exit list allocation. AHB preparing planning application. Approved by Department January 2016. Planning permission granted 30/05/2016. Contractor went on	Units to be completed	Q4 2016

					site 8/8/16.		
Central-General Needs	AHB	Merville Ave (Co-operative Housing Ireland)	CALF & Leasing	5	Units to be acquired from developer	DECLG issued approval 03/05/2016	2017
Central	AHB	Various Addresses	CALF & Leasing	10	Approved by Department	to be acquired	Q4 2016
Various	AHB	Various Addresses	Leasing	3	Approved by Department	Finalise Lease	Q4 2016
Central – Special Needs	AHB	Sherrard St, Dublin 1 (PMcVT)	Leasing	17	Approved by Department July 2016	Lease to be finalised with owner	2016
South Central General Needs & Special Needs	AHB	Prior Hall, Bow Lane, Dublin 8 (Tuath)	Leasing	19	Approved by Department under Leasing	Tuath to enter into Lease arrangements with Landlord	Q4 2016
Central General Needs & Special Needs	DCC	Liffey Trust, Dublin 1 (DCC)	Leasing	10	Department have approved proposal	Authorisation finalised with Department, progressing with completing agreements. To be delivered as units become vacant	2017
All areas – Special Needs	AHB	Various Addresses	CAS	26	Acquisition approved by DCC	Legal documentation to be completed	2016
	Sub –total			370			
	GRAND TOTAL	Units under construction or being acquired		771			

Part V

Committee Area/ Housing Category	Provider	Schemes	Funding Programme	No of Units	Status	Next Milestone	Expected Completion Date
Central	Dublin City	Castleforbes, Northbank, D.1	LA Housing	26	Met with Receiver January 2016.	DCC to finalise legal agreement when	Q1 2017

	Council		(Acquisitions)		Receiver to submit schedule of works	received	
North West	Dublin City Council	Hampton Wood, Dublin 11	LA Housing (Acquisitions)	25	Agree purchase of units	DCC to agree costs to purchase units	Q4 2016
	TOTAL			51			

	Schemes at Tender Stage						
Committee Area/ Housing Category	Provider	Schemes	Funding Programme	No of Units	Status	Next Milestone	Expected Completion Date
Central General Needs	Dublin City Council	Ballybough Road	LA Housing	7	Tender report sent DHPCLG 27/09/16	Contractor appointed	Q4 – 2017
South Central General Needs	Dublin City Council	St. Teresa's Gardens	Regeneration	50	. Demolitions complete Enabling works for services diversions being carried out Boundary & Drainage enabling works tendered Q1 2016 Linear park design agreed	Boundary & drainage works will have to be retendered due to extent of soil contamination uncovered. Main contract – tender to issue Q2 2017 Precinct Improvement to commence Q4 2016	Q4 – 2018
North Central General Needs	AHB	Richmond Road (Co-operative Housing Ireland)	CALF & Leasing	39	Construction Development. Approval from Department 12/10/2015. Contractor appointed. Contractor on site.	Commence construction	2018
South Central General Needs	AHB	Orchard Lawns, Blackditch Road D10 (Co-operative Housing Ireland)	CALF & Leasing	72	DCC site. New contractor appointed. Contractor due on site mid October	Commence construction	2018
South Central Special Needs	AHB	Raleigh Square D12 (Tuath)	CALF & Leasing	33	DCC site. Tuath to retender. New tender accepted. Expect to go on site Qr 4 2016	Appointment of Contractor	2018
Central-General Needs	AHB	Killarney Court, Dublin 1 (Cluid).	CALF & Leasing	4	Change of use office to residential. Approved by Department 22.08.2016 – PAA only, no CALF	Design Team to be appointed	2017
North West-Special Needs	AHB	Wad River Court, Ballymun (Cluid)	CALF & Leasing	8	DCC site. Accelerated funding approved by Department 18/08/2016. Planning approval received.	To complete tender process	Q3 2017

	GRAND TOTAL			213			
--	-------------	--	--	-----	--	--	--

Capital Appraisals submitted to the Department.							
Committee Area/ Housing Category	Provider	Schemes	Funding Programme	No of Units	Status	Next Milestone	Expected Completion Date
North Central General Needs	Dublin City Council	Bunratty Road, Phase 1c	LA Housing	62	Scheme approved in principle by DPHCLG. Tender documentation to procure Design Team being prepared..	Issue of tender to procure design team:Q4 2016	Q2 2019
South Central General Needs	Dublin City Council	Cornamona, Ballyfermot	LA Housing	60	Approved in principle by DHPCLG.. Part 8 plans being finalised	Submission of Part 8 Q4 2016	Q4 2018
Central General Needs	Dublin City Council	North King Street	LA Housing	30	Part 8 was approved at a special meeting of the City Council on 25/7/16. tender documentation being approved.	Approval to go to tender	Q3 2018
Central General Needs	Dublin City Council	Infirmiry Road/ Montpelier Hill	LA Housing	30	Tender for design team being assessed.	Design team in place	Q2 2019
Central – General Needs	Dublin City Council	Dominick Street (East Side)	Regeneration	73	Outline design finalised. Cost Effectiveness Report submitted to DECLG on 1/6/16. Approval in principle to project – 29/06/16. Part 8 initiated Sept 2016.	Part 8 approval	Q4 2019
North Central General Needs	Dublin City Council	Belcamp (site B)	LA Housing	12	Scheme approved in principle by DPHCLG. Tender documentation to procure Design Team being prepared..	Issue of tender to procure design team:Q4 2016	Q2 2018
North Central General Needs	Dublin City Council	Belcamp (site C)	LA Housing	16	Scheme approved in principle by DPHCLG. Tender documentation to procure Design Team being prepared..	Issue of tender to procure design team:Q4 2016	Q2 2018
Central General Needs	Dublin City Council	Sackville Avenue Cottages/ Croke Villas	Regeneration	12 35	Approval to Stage 1 received from Department 20/06/2016. Design Team appointed	Bring to Part 8	Q4 2018 2019

South Central General Needs	AHB	Catherine's Gate, D.8. (Cluid)	CALF & Leasing	22	Cluid to make funding application under CALF and Leasing for all 22 units.	Units to be acquired	Q4 2016
South East Special Needs	AHB	Moss Street, D.2. (Co-operative Housing Ireland)	CAS	22	DCC property. Approved under 2015 CAS Programme. Design team appointed Oct 2015 and have met DCC's Architect. On 17/2/16 DCC and AHB's design team inspected building. Commencing design process. DCC in negotiations with Developer of adjoining site.	Conclude negotiations with Developer	2018
South East – Special needs	AHB	Townsend Street 180-187 (P McVerry Trust)	CAS	18	DCC property. Approved under 2015 CAS Programme. Design team appointed	Developed design and Cost Plan	2018
Central – Special Needs	AHB	Martanna House, High Park (Respond!)	CAS	8	Approved under 2015 CAS Programme. AHB reviewing costs. Respond submitted documents to seek permission to issue tenders.	Approval to go to tender	2018
South East – Special Needs	AHB	Beechill, Dublin 4. (RHDVHA)	CAS	20	DCC property. Approved under 2015 CAS Programme. Design Team Appointed. Dept issued Stage 2 approval . Planning application lodged 8/8/16(3490/16)	Decision on planning application	2018
Central Special Needs	AHB	Ellis Court, D.7. (Túath)	CAS	22	DCC property. Approved under 2015 CAS Programme. Design team reviewing following DCC's comments. AHB expects to submit for stage 2 approval early October.	Developed design and cost plan	2018
South Central – Special Needs	AHB	Rafter's Lane, D. 12. (Walkinstown Housing Assoc.)	CAS	15	DCC site. Approved under 2015 CAS Programme. WALK appointed Design Team off OGP Panel	Developed design and cost plan	2018
Central General Needs	AHB	St. Mary's Mansions (Cluid)	CALF & Leasing	80	DCC property. Planning permission granted. (2812/16). Title rectification underway.	Issue of tender documents	2018
South Central Special Needs	AHB	John's Lane West D8 (Focus)	CALF & Leasing	31	Focus has revised planning permission for 31 units. Design team appointed. Tender issued for demolition and enabling works contract.	Completion of tender process	2017

					Expected start date of December 2016		
Central – Special needs	AHB	Dominick Place (The Aids Fund)	CALF & Leasing	9	Approved for funding. Increase in costs to revert back to Department. Possible switch to CAS funding. AHB to consider various options.	AHB to decide on whether to pursue CALF or CAS funding stream	2017
North West – General Needs	AHB	Stormanstown Hall, Dublin 11 (Oaklee)	CALF & Leasing	42	Approved by Department for CALF and Leasing	AHB to agree acquisition terms with developer expect to complete December 2017	Q4 2017
South Central Special Needs	AHB	Kilmainham Cross (Novas Initiatives)	Request for CAS funding	11	Full planning permission for 11 units. Site provided by Department of Justice in response to Homeless Implementation Calls. DECLG raised queries. With AHB for response.	DCC to meet Novas & IPS to discuss viability of project	2018
Grand total				630			

Schemes at Preliminary Planning / Design							
Committee Area/ Housing Category	Provider	Schemes	Funding Programme	No of Units	Status	Next Milestone	Expected Completion Date
South East – General Needs	Dublin City Council	Charlemont (BI 4) Dublin 2	PPP	15	DCC to exercise an option to acquire further units at this location (15 units at 10% discount of market value)	Agree cost of 15 units with Developer and submit to DPHCLG for funding	2020
North West – General Needs	Dublin City Council	The Valley Site, St. Helena's Road, Finglas	LA Housing	50	Design drawn up. Proposal to include both private (120 approx) and social (50 approx) units	DCC to review overall plan	2018/2019
Norht Central – General Needs	Dublin City Council	Slademoire Ayrfield	LA Housing	15	Designs to be reviewed to quantify the extent of design work required to bring to Part 8 planning stage	DCC to review designs and submit to DPHCLG for approval.	2018/2019
Central – General Needs	Dublin City Council	Shaw Street Pearse St	LA Housing	11	New designs would be required as this site, which was acquired as Part V off site compliance, is no longer compliant with regulations.	Review options for future development of the site	2018/2019
Sth Central – General Needs	Dublin City Council	Springvale Chapelizod	LA Housing	81	Designs to be reviewed to determine extent of work required for Part 8 (off site Part V compliance)	DCC to review designs and submit to DPHCLG	2018/2019
Sth Central Special Needs	AHB	New Street Coombe (Peter McVerry Trust)	CAS	8	DCC property. Proposal to be submitted re the development units – potential for 4 units. Pre-planning meeting held. AHB preparing Capital Appraisal	AHB submits Capital Appraisal	2017
Sth Central General Needs	Dublin City Council	Site 1B St. Michaels Estate	LA Housing	58	. Site is now included in the Land Initiative proposal	Capital appraisal to be prepared	
South Central – General	Dublin City Council	Reuben Street	LA Housing	1	Site for one house, adjoining house refurbished and tenanted recently.	Determine future use of site	2018/2019

Needs							
North West – General Needs	Dublin City Council	Collins Avenue, Thatch Road	LA Housing	80	Affected by proposals for new high speed bus lane from Swords to City Centre, which will reduce number of units.	Determine when site will be available for future development	2018/2019
South Central – General Needs	Dublin City Council	Croftwood Gardens & Environs	LA Housing	45	Plan to develop a number of infill sites in this area. No of units reduced as modular housing on part of site	DCC to review and determine future development of sites	2018/2019
South Central	Dublin City Council	Coruba House lands, Dublin 12	LA Housing	20	Site boundary to be reviewed in relation to adjoining plot of land.	DCC to review site and prepare draft proposal for development.	2018/2019
Sth Central – General Needs	Dublin City Council	Dolphin Phase 2	Regeneration	90	Design being examined	Outline design & masterplan to be agreed	2020
South Central Page 67	AHB	Jamestown Court, Inchicore Dublin 10 (ALONE)	CALF & Leasing	32	Alone considering CALF & Leasing as alternative funding, but to develop entire complex rather than single block.AHB prepared proposal and DCC has given its comments.	AHB to submit revised proposal for site	2018
South Central Special Needs	AHB	Dolphin Park D8 (FOLD)	CALF & Leasing	49	Design Team Appointed, site meeting held 06/09/16 to agree outstanding issues. Consultation meeting held with residents reps. Planning application lodged	Grant of planning	2018
Central	AHB	North King Street 84 (Co-operative Housing Ireland)	CALF & Leasing	33	Planning application submitted 21/06/2016 (3163/16). 15/8/16, Additional information requested	Grant of Planning	Q4 2017
Central	AHB	Poplar Row D3 (Oaklee)	CALF & Leasing	29	Oaklee may submit revised planning application based on the new planning guidelines. On 2/2/16 planning decision for additional information (4124/15). Additional information submitted on 12/5/16. Decision made to grant pp	Finalise detailed design	2018
South East	AHB	Bethany House (Cluid)	CALF & Leasing	64	Proposed redevelopment of existing 38 units and the addition of an extra 26 units. Decanting to commence.	Development of design	2018

Central	AHB	Site at Railway St – opposite Peadar Kearney House(Circle)	CALF & Leasing	34	DCC site. Early Planning. Feasibility Study reviewed by DCC. Pre-planning meeting held. Revised Design submitted. Cost appraisal being carried out by Circle	Agree proposal	2019
North Central	AHB	Clongriffin (The Iveagh Trust)	CALF & Leasing	84	Early Planning. Part V	AHB to submit funding application	2018
South Central	Dublin City Council	Bow Lane James's Street	LA Housing	4	Site acquired by the Council.	DCC to review and prepare draft design.	2018/2019
Central Special Needs	AHB	Bolton St, Dublin 1 (NOVAS)	CAS	8	AHB prepared preliminary proposal to redevelop buildings as 2 *4bed. DCC reviewed proposal and made comments.	AHB to submit revised proposal for site	2018
Central	AHB	The Steelworks, Dublin 1 (Cluid)	CALF & Leasing	8	For St. Mary's Mansions decanting	DCC returned comments to Department	Q4 2016
Central, South Central (7), North West (3), North Central (1)	AHB	Various locations (Novas)	CALF & Leasing	11	Houses to be acquired for homeless	DCC returned comments to Department	Q4 2016
TOTAL				777			

Vacant Council Lands (Total Residential Dwellings to include 30% Social Housing)

Schemes/Sites	Comment	Approx.
Oscar Traynor Road	Lands owned by the Council (not acquired for housing purposes). Included in Housing Land Initiative feasibility study. Design being reviewed prior to going to market	195
North Central – General Needs		
O Devaney Gardens + Infirmary Road	former PPP lands. Phase 1. Included in Housing Land Initiative feasibility study. Part VIII report to demolish 4 blocks approved by the City Council on 25/07/16.	175
Central – General Needs		
St Michaels Estate	former PPP lands. Included in Housing Land Initiative feasibility study	130
South Central – General Needs		

Total		500
Sites for Social Housing PPP; Bundle 1		
Schemes/Sites	Comment	Approx.
Scribblestown (lot 5) North West – General Needs	Has existing design which could be modified	100
Ayrfield (part of) North Central – General Needs and Special Needs	Part of larger site which is available for social housing	100
Total		200

Rapid Home Delivery				
Scheme/Sites	No. of Units	Status	Next Milestone	Expected Completion Date
4 Sites: 1. St. Helena's Drive NW 2. Cherry Orchard SC 3. Belcamp H NC 4. Mourne Road SC	131	Letters of intent with winning bidders, main contract to be signed October 2016	Contractor to be on site mid October	Q1 2017
Woodbank Rathvilly NW HSE Lands Ballyfermot SC Woodville House NC	50-70	Currently reviewing sites including topographical surveys and mapping of utilities and services		
2 sites to be identified for a Pilot Scheme for Apartment Volumetric Build	100	Advertisement for Architectural Services for Volumetric Build Framework October 2016	Site Selection Q3 2016	2018
Total	301			

**The Chairman and Members of
North West Area Committee.**

Meeting: 18th October 2016

Item No: 17

**Traffic Service Requests,
Status Report at 15th September 2016**

Please note that to ensure continued efficient operation of the Sharepoint database system it has become necessary to archive all completed items up to and including 31/12/15. Therefore these items are not reflected in the Status Report.

**Traffic Advisory Group (TAG) Service Request
Statistics**

*Total TAG Requests received 01/01/16 to 15/09/16 (including duplicate requests)	221
.....of which completed	64

No. Requests received since previous report (i.e. between 16/08/16 and 15/09/16).	21
Total Requests received and currently open on Sharepoint since 1 st January, 2013 (not including secondary/duplicate requests. Number of secondary requests indicated in separate column)	349

**Breakdown of Requests currently open on
Sharepoint**

Stage 1	11
Stage 2	302
Stage 3	3
Stage 4	17
Stage 5	16

Non TAG Service Requests Statistics

Total Non- TAG Requests received since 1 st January 2016	610
.....of which Requests Completed	367
Total Requests currently received and open on Sharepoint since 1 st January, 2013	409

Traffic Advisory Group Status Reports

Explanation of Stages:

- Stage 1 - Set up file, Assignment to Engineer, etc
- Stage 2 - Assessment, Site surveys, review statutory orders, etc
- Stage 3 - Consultations, with Garda, Dublin Bus, Luas, NTA, Local residents / businesses, etc
- Stage 4 - Decision, TAG group, statutory orders, etc
- Stage 5 - Implementation, signs, lines, construction, signal changes, certifications, etc

Item	Ref	Road	Post-code	Topic	Request Description	Date Rec'd	SR Status	No. Secondary Requests
1	10199	GRIFFITH AVENUE (NW-EA)	D9	3 Tonne Limit	for traffic travelling westwards from Swords Road junction.	13/01/2014	Stage 4	0
2	10580	FAUSSAGH AVENUE (NW-EA)	D7	Traffic Calming	update on traffic calming request at this junction	11/02/2014	Stage 2	0
3	11377	KEMPTON WAY (NW-EA)	D7	Speed Ramps	on the road.	26/03/2014	Stage 2	1
4	11475	SKREEN ROAD (NW-EA)	D7	Traffic Lights	at the junction of Navan Road.	01/04/2014	Stage 2	1
5	11485	MILLBOURNE AVENUE (NW-EA)	D9	Pay & Display & Permit Parking	on the road.	01/04/2014	Stage 4	5
6	11583	CHURCH AVENUE (NW-EA)	D9	Engineer Query	parking provision at the Glasnevin Educate Together National School.	03/04/2014	Stage 2	0
7	11921	MILLMOUNT AVENUE (NW-EA)	D9	Buildout		24/04/2014	Stage 4	0
8	12043	COLLINS DRIVE (NW-EA)	D11	Zebra Crossing	at the junction of Glasaree Road.	29/04/2014	Stage 2	0
9	12052	COULTRY ROAD (NW-EA)	D9	Zebra Crossing	at Gaelscoil Bhail Munna.	29/04/2014	Stage 2	1
10	12227	BALBUTCHER LANE (NW-EA)	D11	Traffic Lights	at Carton Close/ Carton Court/ Carton Road.	12/05/2014	Stage 2	0
11	12405	STORMANSTOWN ROAD (NW-EA)	D11	Speed Ramps	additional ramp on the road.	12/05/2014	Stage 5	0

Item	Ref	Road	Post-code	Topic	Request Description	Date Rec'd	SR Status	No. Secondary Requests
		EA)						
12	12406	BALLYGALL ROAD EAST (NW-EA)	D11	Cycle Track	on both sides of the road.	12/05/2014	Stage 2	0
13	12611	SAINT HELENA'S ROAD (NW-EA)	D11	Pedestrian Crossing	south of Tesco's	26/05/2014	Stage 2	0
14	12612	SAINT HELENA'S ROAD (NW-EA)	D11	Pedestrian Crossing	at the junction of Tolka Valley Road.	26/05/2014	Stage 2	0
15	12644	SAINT PATRICK'S ROAD (NW-EA)	D9	No Left Turn (Rescind)	from St. Patrick's Road onto Whitworth Road, during morning peak.	29/05/2014	Stage 2	0
16	12646	SAINT PATRICK'S ROAD (NW-EA)	D9	Traffic Calming	on the road.	29/05/2014	Stage 2	0
17	12692	SAINT CANICES ROAD (NW-EA)	D11	Traffic Lights	request for traffic lights at the junction of St Canices Rd and Ballymun Rd	04/06/2014	Stage 2	0
18	12906	FINGLAS ROAD (NW-EA)	D11	Disabled Parking Bay (General)	and rescindment of Pay and Display Parking at the parking bay nearest the pedestrian lights to facilitate the Museum.	23/06/2014	Stage 2	0
19	13225	BLACKHORSE AVENUE (NW-EA)	D7	Traffic Lights	at the Ashtown Gate.	18/07/2014	Stage 2	0
20	13337	CLAREMONT COURT (NW-EA)	D11	Pedestrian Crossing	on Claremont Court at the junction of Fingals Road.	22/07/2014	Stage 2	0
21	13664	NAVAN ROAD (NW-EA)	D7	Bus Lane	from the Old Cabra Road to Nephin Road junction, outbound.	18/08/2014	Stage 4	0

Item	Ref	Road	Post-code	Topic	Request Description	Date Rec'd	SR Status	No. Secondary Requests
22	13796	CABRA DRIVE (NW-EA)	D7	Parking Prohibition	North west side. from the corner of No. 23 to Old Cabra Road and rescindment of stat no. 18270 (no parking). To be reviewed by Area Engineer.	28/08/2014	Stage 4	1
23	13970	SWORDS ROAD (NW-EA)	D9	Traffic Lights	at the exit to Elmhurst Nursing Home on Swords Road.	05/09/2014	Stage 2	0
24	14059	PINEWOOD AVENUE (NW-EA)	D11	Speed Ramps	on the road	15/09/2014	Stage 2	0
25	14544	GRIFFITH AVENUE (NW-EA)	D11	Traffic Calming	between Ballymun Road and Ballygall Road East.	06/10/2014	Stage 2	0
26	14545	BALLYBOGGAN ROAD (NW-EA)	D11	Pedestrian Refuge Island	at the junction of Ballyboggan Road and Broombridge Road.	06/10/2014	Stage 5	0
27	14626	RATOATH ROAD (NW-EA)	D7	Traffic Calming	on Cabra and Finglas ends of the road.	21/10/2014	Stage 2	0
28	14627	FAUSSAGH AVENUE (NW-EA)	D7	Traffic Calming	on the road.	21/10/2014	Stage 2	2
29	14628	NEPHIN ROAD (NW-EA)	D7	Traffic Calming	on the road.	21/10/2014	Stage 2	0
30	14630	HAZELCROFT ROAD (NW-EA)	D11	Traffic Calming	at the junction of Hazelcroft Road and Fairlawn Road.	21/10/2014	Stage 2	0
31	14631	FAIRLAWN ROAD (NW-EA)	D11	Traffic Calming	request for traffic calming on the road.	21/10/2014	Stage 2	0
32	14750	IONA CRESCENT (NW-EA)	D9	Stop Sign	'Stop' <u>or</u> 'Yield' Sign at the junction of Iona Villas.	13/10/2014	Stage 2	0
33	14798	RATOATH ROAD (NW-EA)	D11	Pedestrian Crossing	at the entrance to Colaiste Mhuire.	14/10/2014	Stage 2	3
34	15215	BALBUTCHER LANE (NW-EA)	D11	Pedestrian Crossing	At the Community Centre, near Carton Road.	04/11/2014	Stage 2	5

Item	Ref	Road	Post-code	Topic	Request Description	Date Rec'd	SR Status	No. Secondary Requests
35	15220	VENTRY PARK (NW-EA)	D7	Children Crossing Sign	at Ventry Playground.	18/11/2014	Stage 2	0
36	15231	BROOMBRIDGE ROAD (NW-EA)	D7	Double Yellow Lines	on the corners from 121/123 Broombridge Road to 353 Bannow Road.	18/11/2014	Stage 2	0
37	15352	ALBERT COLLEGE LAWN (NW-EA)	D9	Pay & Display & Permit Parking	Request for parking restriction as above.	12/11/2014	Stage 2	2
38	15450	WELLMOUNT ROAD (NW-EA)	D11	Engineer Query	Erection of mirrors, and/or "Danger Vehicles Exiting" markings at main exit to St. Michael's Secondary School.	18/11/2014	Stage 2	0
39	15473	VILLA PARK GARDENS (NW-EA)	D7	Double Yellow Lines	at the footpath dishing opposite the Credit Union.	25/11/2014	Stage 2	0
40	15490	IONA ROAD (NW-EA)	D9	Engineer Query	Request to investigate dangerous junction and slow down traffic at above.	20/11/2014	Stage 4	0
41	15541	KILDONAN ROAD (NW-EA)	D11	Yellow Box (Extend)	Dublin Bus request yellow box be enlarged as current size box restricts movement turning from Kildonan Road onto Mellows Road.	25/11/2014	Stage 4	0
42	15556	SHANTALLA ROAD (NW-EA)	D9	One-Way System	at the service road at the shops.	26/11/2014	Stage 2	0
43	15609	WHITWORTH ROAD (NW-EA)	D9	Speed Ramps	to replace the Speed Cushions with Speed Ramps.	26/11/2014	Stage 2	0
44	15649	FAUSSAGH AVENUE (NW-EA)	D7	Pedestrian Crossing	Request for pedestrian crossing at above.	01/12/2014	Stage 2	0

Item	Ref	Road	Post-code	Topic	Request Description	Date Rec'd	SR Status	No. Secondary Requests
45	15787	SYCAMORE PARK (NW-EA)	D11	Engineer Query	to arrange for a traffic inspection at the junction of Sycamore Park and Sycamore Road.	16/12/2014	Stage 2	0
46	15845	SYCAMORE PARK (NW-EA)	D11	Engineer Query	Request for traffic inspection of the junction of Sycamore Park and Sycamore Road.	16/12/2014	Stage 2	0
47	15846	SYCAMORE PARK (NW-EA)	D11	Pedestrian Crossing	Request for Pelican Crossing at the junction of Sycamore Park and Sycamore Road.	16/12/2014	Stage 2	0
48	15847	SYCAMORE PARK (NW-EA)	D11	Double Yellow Lines	at the junction of Sycamore Park and Sycamore Road.	16/12/2014	Stage 2	1
49	15854	BALLYMUN ROAD (NW-EA)	D9	Loading Bay	at the shops, at The Grapevine Off Licence.	15/12/2014	Stage 2	0
50	15866	SHANTALLA ROAD (NW-EA)	D9	Disabled Parking Bay (General)	outside The Haven Pharmacy, 2, Shantalla Road.	12/12/2014	Stage 2	0
51	15872	SAINT PATRICK'S PARADE (NW-EA)	D9	Double Yellow Lines	on the road.	18/12/2014	Stage 2	0
52	15987	SAINT MOBHI BOITHIRIN (NW-EA)	D9	Parking Prohibition	opposite Nos. 1-3.	19/12/2014	Stage 4	3
53	16071	OLD FINGLAS ROAD (NW-EA)	D11	School Warden	To relocate the existing School Warden to the pedestrian gate of St. Brigid's GNS.	12/01/2015	Stage 2	1
54	16153	BERRYFIELD ROAD (NW-EA)	D11	Children Crossing Sign	on the road.	20/01/2015	Stage 2	1
55	16157	BOTANIC VILLAS (NW-EA)	D9	Double Yellow Lines	on one side of Botanic Villas between Nos. 120 and 124 Botanic	20/01/2015	Stage 2	0

Item	Ref	Road	Post-code	Topic	Request Description	Date Rec'd	SR Status	No. Secondary Requests
					Road.			
56	16169	THE RISE (NW-EA)	D9	Continuous White Line (Rescind)	at the Ballymun Road junction.	16/01/2015	Stage 2	1
57	16259	ULSTER STREET (NW-EA)	D7	Double Yellow Lines (Extend)	on Ulster Street at Coonaught Street junction.	20/01/2015	Stage 2	0
58	16459	CARNLOUGH ROAD (NW-EA)	D7	Traffic Calming	on the road.	02/02/2015	Stage 2	1
59	16519	VILLA PARK GARDENS (NW-EA)	D7	Parking Prohibition	Request for Double Yellow Lines or Single Yellow Line.	04/02/2015	Stage 3	0
60	16529	CONNAUGHT STREET (NW-EA)	D7	Speed Ramps	on the road.	05/02/2015	Stage 2	0
61	16544	GLASANAON ROAD (NW-EA)	D11	Pedestrian Crossing	at Gaelscoil Ui Earcain.	05/02/2015	Stage 2	2
62	16592	IONA ROAD (NW-EA)	D9	Pay & Display & Permit Parking	On the un-named road that connects Iona Road to Lindsay Road.	05/11/2014	Stage 2	0
63	16694	RATOATH ROAD (NW-EA)	D7	Continuous White Line	and rescindment of broken white line at the new bridge.	13/02/2015	Stage 5	1
64	16706	MILLMOUNT AVENUE (NW-EA)	D9	Pay & Display & Permit Parking		17/02/2015	Stage 2	0
65	16726	WALSH ROAD (NW-EA)	D9	Traffic Calming	request for additional traffic calming.	16/02/2015	Stage 2	3
66	16812	SKREEN ROAD (NW-EA)	D7	Parking Prohibition	on the road.	20/02/2015	Stage 2	0
67	16875	FAUSSAGH ROAD (NW-EA)	D7	Speed Ramps	on the road.	05/02/2015	Stage 2	0
68	16876	FAUSSAGH AVENUE (NW-EA)	D7	Speed Ramps	on the road.	07/02/2015	Stage 2	0

Item	Ref	Road	Post-code	Topic	Request Description	Date Rec'd	SR Status	No. Secondary Requests
		EA)						
69	16889	DRUMCONDRA ROAD UPPER (NW-EA)	D9	No Right Turn	from Millmount Avenue onto Drumcondra Road.	24/02/2015	Stage 2	0
70	17007	RATOATH ROAD (NW-EA)	D7	Traffic Calming	from the roundabout at Drumcliffe Road up to Cabra cross.	02/03/2015	Stage 2	0
71	17010	SYCAMORE ROAD (NW-EA)	D11	Traffic Calming	on the road.	02/03/2015	Stage 2	0
72	17311	COOLATREE PARK (NW-EA)	D9	Speed Ramps	on the road.	23/03/2015	Stage 2	0
73	17529	VICTORIA LANE (NW-EA)	D9	Parking Prohibition	on Victoria Lane, the laneway to the rear of Nos. 2-48, Botanic Avenue and Nos. 1-55, Hollybank Road.	25/03/2015	Stage 4	3
74	17707	QUARRY ROAD (NW-EA)	D7	Engineer Query	NWAC 21/04/15 - review of possible solutions to tackle the illegal parking at the pedestrian entrance to Homestead Court on Quarry Road	21/04/2015	Stage 5	0
75	17785	KEMPTON GROVE (NW-EA)	D7	Double Yellow Lines	Opposite No. 6.	22/04/2015	Stage 2	0
76	17798	FINGLAS ROAD (NW-EA)	D11	Yellow Box	inbound at the pedestrian crossing at the junction of Ballyboggan Road.	23/04/2015	Stage 2	0
77	17800	FINGLAS ROAD (NW-EA)	D11	No U Turn	outbound at the junction of Ballyboggan Road, preventing a U Turn onto the inbound lane.	23/04/2015	Stage 2	0
78	18037	GROVE WOOD (NW-EA)	D11	Traffic Calming	on the road.	07/05/2015	Stage 2	0

Item	Ref	Road	Post-code	Topic	Request Description	Date Rec'd	SR Status	No. Secondary Requests
79	18078	COOLATREE PARK (NW-EA)	D9	Stop Sign	and rescindment of 'Yield' Sign on Coolatree Park at the junction of Coolgreena Road.	08/05/2015	Stage 2	0
80	18079	COOLGREENA ROAD (NW-EA)	D9	School Ahead Sign	on Coolgreena Road and Coolatree Park.	08/05/2015	Stage 2	0
81	18082	BEAUMONT ROAD (NW-EA)	D9	No Right Turn	from Beaumont Road onto Coolgreena Road, during morning peak.	08/05/2015	Stage 2	2
82	18087	THE PADDOCK (NW-EA)	D7	Traffic Calming	Request for a ramp at entrance/exit to estate.	11/05/2015	Stage 2	0
83	18154	MCKEE PARK (NW-EA)	D11		at entrance.	19/05/2015	Stage 2	0
84	18161	WALSH ROAD (NW-EA)	D9	Pedestrian Crossing	facing Griffith Park.	19/05/2015	Stage 2	3
85	18163	CREMORE CRESCENT (NW-EA)	D11	Double Yellow Lines	at entrance.	19/05/2015	Stage 2	0
86	18195	GLASANAON ROAD (NW-EA)	D11	Parking Prohibition	outside Nos. 154-208.	15/05/2015	Stage 2	0
87	18409	FINGLAS PLACE (NW-EA)	D11	Traffic Calming	on the road.	28/05/2015	Stage 2	1
88	18421	WILLOW PARK CRESCENT (NW-EA)	D11	Pedestrian Crossing	at the shops.	29/05/2015	Stage 2	0
89	18422	WILLOW PARK CRESCENT (NW-EA)	D11	Pedestrian Refuge Island (Rescind)	at the shops.	29/05/2015	Stage 2	0
90	18424	WILLOW PARK ROAD (NW-EA)	D11	Double Yellow Lines	at the junction of Willow Park Crescent.	29/05/2015	Stage 2	0
91	18489	BALLYGALL PARADE (NW-EA)	D11	Road Closure (Rescind)	at the western end of the road.	15/06/2015	Stage 2	0
92	18622	SAINT PATRICK'S PARADE (NW-EA)	D7	Traffic Calming	on the road.	16/06/2015	Stage 2	0

Item	Ref	Road	Post-code	Topic	Request Description	Date Rec'd	SR Status	No. Secondary Requests
93	18624	VALEVIEW CRESCENT (NW-EA)	D11	Speed Ramps	request for speed ramps on Valeview Crescent.	16/06/2015	Stage 2	0
94	18630	SAINT PATRICK'S PARADE (NW-EA)	D9	One-Way System	on the road.	16/06/2015	Stage 2	0
95	18653	GROVE WOOD (NW-EA)	D11	Speed Ramps	on the road.	08/06/2015	Stage 2	2
96	18715	FARNHAM DRIVE (NW-EA)	D11	Pedestrian Crossing	crossing to the pitches.	16/06/2015	Stage 4	0
97	18741	DALCASSIAN DOWNS (NW-EA)	D11	Double Yellow Lines	between 4 & 5, and 90 & 91 Dalcassian Downs.	15/06/2015	Stage 4	0
98	18766	FITZMAURICE ROAD (NW-EA)	D11	Pedestrian Crossing	Pedestrian crossing at the shops on Fitzmaurice Rd, at junction with Ballygall Rd East.	17/06/2015	Stage 2	4
99	18767	FITZMAURICE ROAD (NW-EA)	D11	Children Crossing Sign	Children Crossing sign at shops on Fitzmaurice Rd, at junction with Ballygall Rd East.	17/06/2015	Stage 2	0
100	18831	DRUMCONDRA ROAD LOWER (NW-EA)	D9	Stop Sign	and rescindment of 'Yield' Sign on the cycle lane at the entrance to the Archbishop's House.	22/06/2015	Stage 2	0
101	18851	CABRA DRIVE (NW-EA)	D7	No Parking	request for No Parking/Double Yellow Lines on the north west corner of the entrance road to Cabra Drive from the Old Cabra Road	24/06/2015	Stage 2	0
102	18857	LINDSAY ROAD (NW-EA)	D9	Yellow Box (Extend)	at junction of Hart's Corner/Lindsay Rd.	23/06/2015	Stage 2	0

Item	Ref	Road	Post-code	Topic	Request Description	Date Rec'd	SR Status	No. Secondary Requests
103	18878	LINDSAY ROAD (NW-EA)	D9	Speed Ramps	Request for additional speed ramps on above road	24/06/2015	Stage 2	0
104	18913	SHANDON PARK (NW-EA)	D7		Request for Children crossing sign at above locations and also Shandon Gardens	24/06/2015	Stage 2	0
105	18957	BOTANIC ROAD (NW-EA)	D9	Yellow Box	Request for yellow box at junction of the Smurfit site on Botanic Road	30/07/2015	Stage 2	0
106	19020	BLACKHORSE AVENUE (NW-EA)	D7	Pedestrian Crossing	in the vicinity of Cabra Gate entrance to the Phoenix Park.	03/07/2015	Stage 2	0
107	19029	WALSH ROAD (NW-EA)	D9	Speed Ramps	Request for additional speed ramps	06/07/2015	Stage 2	1
108	19062	SAINT EITHNE ROAD (NW-EA)	D7	Speed Ramps	for ramps on road.	07/07/2015	Stage 2	0
109	19079	FINGLAS PLACE (NW-EA)	D11	Road Closure	at one end of the road.	28/05/2015	Stage 2	0
110	19152	KEMPTON AVENUE (NW-EA)	D7	Traffic Calming	at the entrance to the Kempton Estate off the Navan Road	21/07/2015	Stage 2	0
111	19153	BROOMBRIDGE ROAD (NW-EA)	D7	Double Yellow Lines	At the junctions of Broombridge Road, Kilkieran Road and Ventry Road.	21/07/2015	Stage 2	0
112	19155	CARNLOUGH ROAD (NW-EA)	D7	Parking Prohibition	to examine the corners of Carnlough Road for illegal parking	21/07/2015	Stage 2	0
113	19172	NAVAN ROAD (NW-EA)	D5	Single Yellow Line	in the vicinity of No. 52	21/07/2015	Stage 2	0
114	19184	PLUNKETT ROAD (NW-EA)	D11	Speed Ramps	Speed ramps requested for Plunkett Road	16/07/2015	Stage 2	0
115	19384	OFFALY ROAD (NW-EA)	D7	Double Yellow Lines	Requesting double yellow lines at the junction of Offaly Road & Dowth	24/07/2015	Stage 2	1

Item	Ref	Road	Post-code	Topic	Request Description	Date Rec'd	SR Status	No. Secondary Requests
					Avenue			
116	1943 3	DRUMCONDRA ROAD UPPER (NW-EA)	D9	Yellow Box	at the entrance to the Nest Creche/Skylon Hotel.	30/07/2015	Stage 2	0
117	1951 2	BALLYGALL ROAD WEST (NW-EA)	D11	Double Yellow Lines	At the rear of St. Canice's Church.	05/08/2015	Stage 2	0
118	1951 4	CLUNE ROAD (NW-EA)	D11	Speed Ramps		05/08/2015	Stage 2	0
119	1962 5	DRUMCONDRA ROAD UPPER (NW-EA)	D9	Yellow Box	Outside the northern vehicular entrance to St. Patrick's College.	13/08/2015	Stage 2	0
120	1966 6	THE THATCH ROAD (NW-EA)	D9	Yellow Box (Rescind)	Requesting that yellow lines be removed from in front of ESB Boxes across from Thatch Road	14/08/2015	Stage 2	0
121	1969 4	KINVARA DRIVE (NW-EA)	D7	Traffic Calming	Traffic calming measures for Kinvara Drive.	17/08/2015	Stage 2	1
122	1969 9	GRIFFITH DOWNS (NW-EA)	D9	Engineer Query		17/08/2015	Stage 4	2
123	1972 5	FINGLAS PARK (NW-EA)	D11	Traffic Calming	on the long straight section.	15/09/2015	Stage 2	2
124	1972 6	WOODHAZEL WAY (NW-EA)	D11	Traffic Calming	at the junction of Woodhazel Way and Woodhazel Close.	15/09/2015	Stage 2	1
125	1975 5	HAMPSTEAD PARK (NW-EA)	D9	Traffic Calming	Request for traffic calming measures	21/08/2015	Stage 2	0
126	1983 5	WALSH ROAD (NW-EA)	D9	Cul-De-Sac	Request for northern ends of above roads to be blocked off (cul de sacs to be put in place).	26/08/2015	Stage 2	0
127	1983 9	DARGLE ROAD (NW-EA)	D9	Loading Bay	Convert easternmost P&D parking space into	26/08/2015	Stage 2	3

Item	Ref	Road	Post-code	Topic	Request Description	Date Rec'd	SR Status	No. Secondary Requests
					a Loading Bay.			
128	19859	GLASILAWN AVENUE (NW-EA)	D11	Loading Bay	Outside 19 Glasilawn Avenue, Dublin 11	27/08/2015	Stage 2	1
129	19907	BOTANIC AVENUE (NW-EA)	D9	Yellow Box	Yellow Boxes for Botanic Avenue.	31/08/2015	Stage 2	0
130	19908	BOTANIC AVENUE (NW-EA)	D9	Filter Light	Filter light for junction of Saint Mobhi Rd & Botanic Ave.	31/08/2015	Stage 2	0
131	19910	RATOATH ROAD (NW-EA)	D7	School Ahead Sign	request for school ahead signs to be placed on Ratoath Road in Cabra , two schools - Saint Catherines and Saint Dominics	01/09/2015	Stage 2	0
132	19927	LORCAN ROAD (NW-EA)	D9	Pedestrian Crossing	Install pedestrian lights at corner of Lorcan Rd.	01/09/2015	Stage 2	0
133	19928	SWORDS ROAD (NW-EA)	D9	Pedestrian Crossing	Pedestrian crossing, or warning sign, at slip road from McDonalds in OMNI Centre onto the Swords Rd.	01/09/2015	Stage 2	0
134	19949	RATOATH ROAD (NW-EA)	D7	Yellow Box	Request for yellow box at top end of above road at Cabra Cross	02/09/2015	Stage 2	0
135	20061	GLEBE VIEW (NW-EA)	D11	Traffic Calming	Request for traffic calming measures in Glebe View off Church Street as motorists speeding into the cul de sac causing dangerous situations for residents.	10/09/2015	Stage 2	0
136	20174	BOTANIC AVENUE (NW-EA)	D9	Traffic Calming	reps for review of traffic management on Botanic Avenue	15/09/2015	Stage 2	0

Item	Ref	Road	Post-code	Topic	Request Description	Date Rec'd	SR Status	No. Secondary Requests
137	20181	SAINT FINBAR ROAD (NW-EA)	D7	Children Crossing Sign	on the road.	07/09/2015	Stage 2	0
138	20185	DRUMCONDRA ROAD LOWER (NW-EA)	D9	Bus Lane	on the bridge over the Tolka, outbound.	15/09/2015	Stage 2	1
139	20188	GLENTIES DRIVE (NW-EA)	D11	Children Crossing Sign	on the road.	15/09/2015	Stage 2	1
140	20189	GLENTIES DRIVE (NW-EA)	D11	Speed Ramps	on the road.	15/09/2015	Stage 2	0
141	20190	TOLKA VALLEY ROAD (NW-EA)	D11	Roundabout	at the junction of Ratoath Road.	15/09/2015	Stage 2	0
142	20232	ABBEY DRIVE (NW-EA)	D7	Double Yellow Lines	from the bend at Ashington Park	16/09/2015	Stage 2	0
143	20256	LEINSTER STREET NORTH (NW-EA)	D7	Pay & Display & Permit Parking (extension of area)		17/09/2015	Stage 2	0
144	20278	SILLOGE ROAD (NW-EA)	D11	Pedestrian Crossing	Request for pedestrian crossing at Holy Spirit school	21/09/2015	Stage 2	0
145	20317	DINGLE ROAD (NW-EA)	D7	Traffic Calming	Request for speed ramps or traffic calming measures on Dingle Road	21/09/2015	Stage 2	0
146	20379	BALLYMUN ROAD (NW-EA)	D9	Disabled Parking Bay (General)	Request by Cllr to have a disabled parking bay outside the Supervalu shop on Ballymun road.	23/09/2015	Stage 2	0
147	20385	CABRA GROVE (NW-EA)	D7	Double Yellow Lines	along the left-hand side as you enter from Cabra Road, up as far as the curve.	24/09/2015	Stage 2	0
148	20494	DANE ROAD (NW-EA)	D11	Speed Ramps	Request for speed ramps on St Josephs Way, off dane road, beside	30/09/2015	Stage 2	0

Item	Ref	Road	Post-code	Topic	Request Description	Date Rec'd	SR Status	No. Secondary Requests
					Cairn Court			
149	20516	SHANGAN AVENUE (NW-EA)	D11	Double Yellow Lines	Request for double yellow lines around the Whiteacre Park Estate	01/10/2015	Stage 2	0
150	20522	GLASANAON ROAD (NW-EA)	D11	Double Yellow Lines	Request for double yellow lines outside Gaelscoil ui Earcain	01/10/2015	Stage 2	0
151	20568	PHIBSBOROUGH ROAD (NW-EA)	D7	Yellow Box	Request for yellow box at entrance to Bective Square Apartment complex at junction with Phibsborough road	05/10/2015	Stage 2	0
152	20630	SCRIBBLESTOWN AVENUE (NW-EA)	D11	Traffic Calming	within the Scribblestown Estate.	20/10/2015	Stage 2	3
153	20634	CHURCH AVENUE (NW-EA)	D9	Double Yellow Lines	Outside No. 3 Church Avenue. Cars visiting Bon Secours Hospital parking on Church Avenue.	07/10/2015	Stage 2	0
154	20677	THE THATCH ROAD (NW-EA)	D9	Double Yellow Lines	at entrance beside No.13.	20/10/2015	Stage 2	0
155	20685	VALLEY PARK ROAD (NW-EA)	D11	Speed Ramps	at entrance.	20/10/2015	Stage 2	0
156	20704	DELVILLE ROAD (NW-EA)	D11	Stop Sign	at the junction of Delville Road and St Pappin's Road.	20/10/2015	Stage 2	0
157	20706	RATOATH ROAD (NW-EA)	D7	Right Turn Filter Light	from Ratoath Road onto Navan Road.	20/10/2015	Stage 2	0
158	20707	BOTANIC AVENUE (NW-EA)	D9	Double Yellow Lines	at the junction of Botanic Avenue with St. Itas Terrace, Botanic Road.	20/10/2015	Stage 2	0

Item	Ref	Road	Post-code	Topic	Request Description	Date Rec'd	SR Status	No. Secondary Requests
159	20729	KINVARA AVENUE (NW-EA)	D8	Pedestrian Crossing	Request from area office from Navan Rd community council for pedestrian lights at Kinvara Avenue and Ashtown Grove.	12/10/2015	Stage 2	0
160	20739	ASHTOWN GROVE (NW-EA)	D7	Pedestrian Crossing	at the junction of Ashtown Grove and Navan Road.	09/10/2015	Stage 2	0
161	20794	COLLINS AVENUE (NW-EA)	D11	Yellow Box	to review traffic at the pedestrian lights at junction of Collins Avenue and Ballymun Road.	20/10/2015	Stage 2	0
162	20848	PARKGATE STREET (NW-EA)	D8	Loading Bay	Outside 25 Parkgate Street, Dublin 8.	16/10/2015	Stage 2	0
163	20868	CONNAUGHT STREET (NW-EA)	D7	Disabled Parking Bay (Residential)	To determine whether the road is high demand or not in relation to the level of parking occupancy for the provision of a bay outside No. 37. Pay and Display and Permit Parking will have to be rescinded.	19/10/2015	Stage 2	0
164	20963	FERGUSON ROAD (NW-EA)	D9	Speed Ramps (Rescind)	on the road.	20/10/2015	Stage 2	0
165	20984	CLAREMONT COURT (NW-EA)	D11	Double Yellow Lines	from 5m after the junction with Finglas Rd, in towards the first residence on Claremount Court.	22/10/2015	Stage 2	3
166	20991	NAVAN ROAD (NW-EA)	D7	No Parking	Request to disallow parking outside crèche at 351a Navan Rd.	22/10/2015	Stage 2	0

Item	Ref	Road	Post-code	Topic	Request Description	Date Rec'd	SR Status	No. Secondary Requests
167	20995	SAINT MARGARET'S ROAD (NW-EA)	D11	Pedestrian Crossing	Upgrade of the roundabout at LIDL and if the upgrade is warranted.	19/10/2015	Stage 2	0
168	21057	COLLINS AVENUE (NW-EA)	D9	Yellow Box	at the exit of Whitehall Church at Collins Avenue.	27/10/2015	Stage 2	0
169	21076	MANNIX ROAD (NW-EA)	D9	Cul-De-Sac	To make Mannix Road a Cul-de-Sac, between the rear entrance to Mannix Road and the Hollybank Road entrance.	28/10/2015	Stage 2	0
170	21094	GLASNEVIN AVENUE (NW-EA)	D9	Pedestrian Crossing	To review the Pedestrian Crossings at the junction of Glasnevin Avenue/Collins Avenue/Ballymun Road.	28/10/2015	Stage 2	0
171	21096	ALBERT COLLEGE PARK (NW-EA)	D9	Double Yellow Lines	at the junction of Collins Avenue Extension.	28/10/2015	Stage 2	0
172	21097	OLD FINGLAS ROAD (NW-EA)	D11	School Warden	at St. Mary's Faith Secondary School.	28/10/2015	Stage 2	0
173	21100	SAINT PAPPIN ROAD (NW-EA)	D11	Parking Prohibition	at the western junction of Dean Swift Road and St. Pappin's Road.	28/10/2015	Stage 2	0
174	21107	OLD CABRA ROAD (NW-EA)	D7	Traffic Calming	To review the traffic calming measures on the road.	27/10/2015	Stage 2	0
175	21122	GLENBEIGH ROAD (NW-EA)	D7	Double Yellow Lines	at the junction of Old Cabra Road.	28/10/2015	Stage 2	0
176	21181	OLD FINGLAS ROAD (NW-EA)	D11	Pedestrian Crossing	at the entrance to St. Mary's School.	29/10/2015	Stage 2	2
177	27737	DRUMCONDRA ROAD UPPER (NW-EA)	D1		on Drumcondra Road Upper at the junction with The Village.	17/11/2015	Stage 2	0

Item	Ref	Road	Post-code	Topic	Request Description	Date Rec'd	SR Status	No. Secondary Requests
178	27740	YELLOW ROAD (NW-EA)	D9	Stop Sign	on Yellow Road at the junction with The Thatch Road. Follow on request for info - 01/07/16 acknowledged.	17/11/2015	Stage 2	0
179	27741	SANTRY AVENUE (NW-EA)	D9	Traffic Lights	at the junction of Santry Avenue and Forrestwood Estate.	17/11/2015	Stage 2	0
180	27748	GLASAREE ROAD (NW-EA)	D11	Children Crossing Sign	Requesting 'Children at Play sign' be erected on Glasaree Road	09/11/2015	Stage 2	0
181	27754	BELCLARE AVENUE (NW-EA)	D11	Traffic Calming	at No. 13.	10/11/2015	Stage 2	0
182	27761	CREMORE DRIVE (NW-EA)	D11	Caution Children Sign	Request for Caution children crossing sign on above road	11/11/2015	Stage 2	0
183	27780	PROSPECT WAY (NW-EA)	D9	Bus Lane	Relocate the Bus Lane to the middle lane.	10/11/2015	Stage 2	0
184	27803	IONA ROAD (NW-EA)	D9	Disabled Parking Bay (Residential)	outside No. 78. Pay and Display and Permit Parking will have to be rescinded.	16/11/2015	Stage 5	0
185	27825	RIVER ROAD (NW-EA)	D15	Double Yellow Lines	on the bend.	12/11/2015	Stage 2	0
186	27866	DRUMCLIFFE ROAD (NW-EA)	D7	Caution Children Sign	Request for Children Crossing sign at Drumcliffe swale	13/11/2015	Stage 2	2
187	27921	FINGLAS ROAD (NW-EA)	D11	Electric Car Bay	Finglas road north of junction with Towerview Cottages, opposite cemetery, the 2nd and 3rd spaces.	19/11/2015	Stage 2	0
188	27979	BOTANIC ROAD (NW-EA)	D9	Yellow Box (Extend)	To include the bus lane at the junction of Lindsay Road.	18/11/2015	Stage 2	0

Item	Ref	Road	Post-code	Topic	Request Description	Date Rec'd	SR Status	No. Secondary Requests
189	28005	PROSPECT ROAD (NW-EA)	D9	Yellow Box	on Prospect Road/Finglas Road, having crossed from Lindsay Road.	23/11/2015	Stage 2	0
190	28007	SHANLISS GROVE (NW-EA)	D11	Children Crossing Sign	at entrance near junction with Shanliss Avenue.	17/11/2015	Stage 2	0
191	28133	BOTANIC ROAD (NW-EA)	D9	No Right Turn	from Botanic Avenue onto St. Mobhi Road, during evening peak hours.	26/11/2015	Stage 2	0
192	28152	HOME FARM ROAD (NW-EA)	D9	Loading Bay	outside Homepharm Pharmacy, No. 45a.	24/11/2015	Stage 2	0
193	28154	HOME FARM ROAD (NW-EA)	D9	Disabled Parking Bay (General)	outside Homepharm Pharmacy, No. 45a.	24/11/2015	Stage 2	2
194	28158	MCKEE AVENUE (NW-EA)	D11	Double Yellow Lines (Extend)	on either side of the entrance to Heath Square.	26/11/2015	Stage 2	0
195	28197	CONYNGHAM ROAD (NW-EA)	D8	Parking Prohibition	and rescindment of Pay and Display Parking along Longmeadow Apartments.	30/11/2015	Stage 2	1
196	28341	LINDSAY GROVE (NW-EA)	D9	Parking Prohibition	at the Prospect Road, end of the road.	17/11/2015	Stage 2	0
197	28353	NAVAN ROAD (NW-EA)	D7	Pedestrian Crossing	at the Halfway House.	07/12/2015	Stage 2	0
198	28367	GROVE PARK CRESCENT (NW-EA)	D10	Speed Ramps	on the road.	15/12/2015	Stage 2	0
199	28368	GROVE PARK DRIVE (NW-EA)	D11	Speed Ramps	on the road.	15/12/2015	Stage 2	0
200	28369	SHANOWEN CRESCENT (NW-EA)	D9	Parking Prohibition	in the cul-de-sac.	15/12/2015	Stage 2	0

Item	Ref	Road	Post-code	Topic	Request Description	Date Rec'd	SR Status	No. Secondary Requests
201	28370	GALLAUN ROAD (NW-EA)	D11	Stop Sign	Stop/Yield sign at the back of Poppintree Sports Complex and Gallaun Road.	15/12/2015	Stage 2	0
202	28374	GLASNEVIN AVENUE (NW-EA)	D9	Continuous White Line	from the junction with Ballymun Road as far as 30/32.	15/12/2015	Stage 2	0
203	28375	LORCAN AVENUE (NW-EA)	D9	Double Yellow Lines	at the junction of Lorcan Avenue and Lorcan Park.	15/12/2015	Stage 2	0
204	28376	LORCAN AVENUE (NW-EA)	D9	Yield Sign	at the junction of Lorcan Avenue and Lorcan Park.	15/12/2015	Stage 2	0
205	28382	KILSHANE ROAD (NW-EA)	D11	Traffic Calming	on the road, adjacent to No. 11.	07/12/2015	Stage 2	1
206	28419	FINGLAS ROAD (NW-EA)	D11	Pedestrian Crossing	Pedestrian Crossing/improve traffic flow at Finglas Road roundabout and Finglas Village junction.	15/12/2015	Stage 2	0
207	28517	GLENTIES PARK (NW-EA)	D11	Pedestrian Crossing	On Glenties Park at Cardiffsbridge Road junction.	15/12/2015	Stage 2	0
208	28632	SHANLISS ROAD (NW-EA)	D9	Traffic Calming		11/01/2016	Stage 2	0
209	28633	BALBUTCHER LANE (NW-EA)	D11	Traffic Calming	from the old Shopping Centre to Poppintree.	11/01/2016	Stage 2	0
210	28729	DALCASSIAN DOWNS (NW-EA)	D11	Double Yellow Lines	and rescindment of Pay and Display and Permit Parking opposite Nos. 11-14.	07/01/2016	Stage 2	0
211	28752	BOTANIC ROAD (NW-EA)	D9	Traffic Lights	To move the traffic lights on Botanic Road to just before the Lindsay Road junction.	18/11/2015	Stage 2	0
212	28753	BOTANIC ROAD (NW-EA)	D9	Speed Ramps	on Botanic Road just before the Lindsay Road junction.	18/11/2015	Stage 2	0

Item	Ref	Road	Post-code	Topic	Request Description	Date Rec'd	SR Status	No. Secondary Requests
213	28793	VALLEY PARK ROAD (NW-EA)	D7	Children Crossing Sign	on the road.	19/01/2016	Stage 2	0
214	28795	COLLINS AVENUE (NW-EA)	D9	Engineer Query	To review of the junction turning left from Collins Avenue West onto Swords Road.	11/01/2016	Stage 2	0
215	28809	ASHINGTON AVENUE (NW-EA)	D7	Pedestrian Crossing	on the road.	19/01/2016	Stage 2	0
216	28815	BLACKHORSE AVENUE (NW-EA)	D7	Parking Prohibition	various as part of Blackhorse Avenue Scheme.	12/01/2016	Stage 5	1
217	28816	DALCASSIAN DOWNS (NW-EA)	D11	Pay & Display & Permit Parking	Request to review the Pay and Display and Permit Parking opposite Nos. 12-14.	11/01/2016	Stage 2	0
218	29011	SHANDON PARK (NW-EA)	D7	Double Yellow Lines (Extend)	from the Shandon Gardens junction.	18/01/2016	Stage 2	0
219	29016	WOODHAZEL CLOSE (NW-EA)	D9	Parking Prohibition	Parking prohibitions for Woodhazel Close, Ballymun.	16/01/2016	Stage 2	0
220	29049	KEMPTON WAY (NW-EA)	D7	Double Yellow Lines (Extend)	on Kempton Way.	19/01/2016	Stage 2	0
221	29062	BOTANIC AVENUE (NW-EA)	D9	Disabled Parking Bay (Rescind Residential)	outside No. 88 and replace with Pay and Display and Permit Parking.	20/01/2016	Stage 2	0
222	29085	BOTANIC AVENUE (NW-EA)	D9	Right Turn Filter Light	from Botanic Avenue onto Saint Mobhi Road.	26/11/2015	Stage 2	0
223	29156	LEINSTER STREET NORTH (NW-EA)	D7	Double Yellow Lines	At No. 1, from the pay and display and permit parking to the junction of the laneway.	28/01/2016	Stage 2	0

Item	Ref	Road	Post-code	Topic	Request Description	Date Rec'd	SR Status	No. Secondary Requests
224	29162	PINE HURST (NW-EA)	D7	Yellow Box	east side of Ratoath Rd, at entrance to Pinehurst Estate.	28/01/2016	Stage 2	1
225	29208	SWORDS ROAD (NW-EA)	D9	No Left Turn	from Swords Road onto Collins Avenue.	01/02/2016	Stage 2	0
226	29302	MARLBOROUGH MEWS (NW-EA)	D7	Parking Prohibition	on the road.	01/02/2016	Stage 2	0
227	29372	DUNARD ROAD (NW-EA)	D7	Double Yellow Lines	DYs for Dunard Rd, close to Tesco's, on the corners heading into the cul-de-sac at Nos. 78 & 50.	04/02/2016	Stage 2	0
228	29410	CONNAUGHT STREET (NW-EA)	D7	Double Yellow Lines	Request for double yellow lines on laneway at rear of above roads.	05/02/2016	Stage 2	0
229	29432	PINEWOOD AVENUE (NW-EA)	D11	Speed Ramps	outside 25/27	16/02/2016	Stage 2	0
230	29524	LARKHILL ROAD (NW-EA)	D9	Speed Ramps		17/02/2016	Stage 2	0
231	29527	BALLYMUN ROAD (NW-EA)	D11	Yellow Box	Yellow box at above junction	09/02/2016	Stage 2	0
232	29837	RATOATH ROAD (NW-EA)	D7	Parking Prohibition	Parking restrictions outside no.287 Ratoath Road	19/02/2016	Stage 2	0
233	29882	SHANTALLA DRIVE (NW-EA)	D9	Speed Ramps	Speed ramps on the road	23/02/2016	Stage 2	0
234	29965	SAINT HELENA'S ROAD (NW-EA)	D11	Double Yellow Lines	from the junction of St. Helena's Drive to the rear entrance to Tesco Clearwater.	26/02/2016	Stage 2	0
235	29969	TOLKA VALLEY ROAD (NW-EA)	D11	Pedestrian Crossing	for safe crossing for disabled people to cross the disabled entrance to Tolka Valley Park.	29/02/2016	Stage 2	0
236	30002	BALLYGALL ROAD WEST (NW-EA)	D11	Yellow Box	Request for yellow box at above junction.	29/02/2016	Stage 2	0

Item	Ref	Road	Post-code	Topic	Request Description	Date Rec'd	SR Status	No. Secondary Requests
237	30003	DALCASSIAN DOWNS (NW-EA)	D11	Double Yellow Lines	outside the houses.	29/02/2016	Stage 2	0
238	30046	SAINT PATRICK'S PARADE (NW-EA)	D9	Pay & Display & Permit Parking	on the road, from St. Patrick's Road to St. Columba's Road Upper.	02/03/2016	Stage 2	1
239	30063	NORE ROAD (NW-EA)	D11	Double Yellow Lines	Double yellow lines on above road outside SPACE SELF STORAGE premises	03/03/2016	Stage 2	0
240	30098	COLLINS AVENUE (NW-EA)	D9	Double Yellow Lines (Extend)	from the junction of The Thatch Road.	04/03/2016	Stage 2	0
241	30099	GRIFFITH AVENUE (NW-EA)	D11	Yellow Box	at the junction of Ballygall Road East.	04/03/2016	Stage 2	0
242	30111	FITZMAURICE ROAD (NW-EA)	D11	Pedestrian Crossing	outside the Credit Union	04/03/2016	Stage 2	2
243	30128	COLLINS AVENUE (NW-EA)	D9	Double Yellow Lines	at the turning circle at No. 451.	07/03/2016	Stage 2	2
244	30178	ALBERT COLLEGE PARK (NW-EA)	D9	Single Yellow Line	outside Nos. 12A – 12C.	08/03/2016	Stage 2	0
245	30260	LARKHILL ROAD (NW-EA)	D9	One-Way System	Weekdays, at school collection and drop off times.	10/03/2016	Stage 2	0
246	30313	SAINT PAPPIN ROAD (NW-EA)	D11	Traffic Lights	at the junction of Stormanstown Road.	15/03/2016	Stage 2	0
247	30366	SAINT JOSEPH'S WAY (NW-EA)	D11	Traffic Calming	Ramps or traffic calming	18/03/2016	Stage 2	0
248	30426	SHANDON ROAD (NW-EA)	D7	Pay & Display Parking (extension of area)	Extension of parking area	22/03/2016	Stage 2	0
249	30540	OWENSILLA TERRACE (NW-EA)	D11	Disabled Parking Bay (Residential)	at No. 6.	31/03/2016	Stage 3	0

Item	Ref	Road	Post-code	Topic	Request Description	Date Rec'd	SR Status	No. Secondary Requests
250	30630	SHANOWEN ROAD (NW-EA)	D9	Double Yellow Lines	on either side of the entrance to Shanowen Hall Student Residence.	07/04/2016	Stage 2	0
251	30638	HOLLYBANK ROAD (NW-EA)	D9	Disabled Parking Bay (Residential)	Outside No. 72. Pay and Display and Permit Parking will have to be rescinded.	08/04/2016	Stage 4	0
252	30685	CEDARWOOD PARK (NW-EA)	D11	Children Crossing Sign	on the road.	19/04/2016	Stage 2	0
253	30686	BALBUTCHER LANE (NW-EA)	D11	Traffic Calming	beside the new RapiD built homes at Baile Na Laochra	19/04/2016	Stage 2	0
254	30708	WELLMOUNT ROAD (NW-EA)	D11	Pay & Display Parking	on the road N2 junction end.	19/04/2016	Stage 2	0
255	30746	SPIRE VIEW (NW-EA)	D7	Children Crossing Sign	on the road	13/04/2016	Stage 2	1
256	30768	DEAN SWIFT ROAD (NW-EA)	D11	Children Crossing Sign	on the road.	12/04/2016	Stage 2	0
257	30807	MARLBOROUGH ROAD (NW-EA)	D7	Pay & Display & Permit Parking	on the road.	14/04/2016	Stage 2	0
258	30826	BALBUTCHER LANE (NW-EA)	D11	Pedestrian Crossing	At Baile Na Laochra (Modular homes site)	16/04/2016	Stage 2	0
259	30830	SHANLISS WAY (NW-EA)	D11	Speed Ramps	between the Santry Lane end and the pedestrian entrance to Ballymun Estate.	16/04/2016	Stage 2	0
260	30870	CRANOGUE ROAD (NW-EA)	D11	Yield Sign	at the junction of Cranogue Terrace.	19/04/2016	Stage 2	0
261	30931	SHANTALLA DRIVE (NW-EA)	D9	Disabled Parking Bay (Residential)	Extension of the disabled parking bay outside No. 8.	07/04/2016	Stage 2	0
262	30950	POPPINTREE CRESCENT	D11	Traffic Calming	on the road at above location	22/04/2016	Stage 2	0

Item	Ref	Road	Post-code	Topic	Request Description	Date Rec'd	SR Status	No. Secondary Requests
		(NW-EA)						
263	30993	RATHLIN ROAD (NW-EA)	D9	Double Yellow Lines	on the road opposite the entrance to 400 Griffith Avenue	25/04/2016	Stage 2	0
264	31003	VIOLET HILL DRIVE (NW-EA)	D11	Children Crossing Sign	at entrance to the Estate	25/04/2016	Stage 2	0
265	31017	BARRY AVENUE (NW-EA)	D11	School Ahead Sign	on the road	26/04/2016	Stage 2	0
266	31113	ALBERT COLLEGE PARK (NW-EA)	D9	Continuous White Line	on the two bends	29/04/2016	Stage 2	0
267	31146	WILLOW PARK ROAD (NW-EA)	D11	Yellow Box	Outside number 156	03/05/2016	Stage 2	0
268	31157	HAMPSTEAD COURT (NW-EA)	D9	Double Yellow Lines (Extend)	Request for extension of DYL's outside no 42, location is opposite the Community Centre, at entrance to apartments.	05/05/2016	Stage 2	0
269	31193	SAINT CANICES ROAD (NW-EA)	D11	School Warden	at Sacred Heart Boys School.	09/05/2016	Stage 2	0
270	31200	BALLYGALL ROAD WEST (NW-EA)	D11	Double Yellow Lines (Extend)	at the junction of Ballygall Road West and Main Street Finglas.	09/05/2016	Stage 2	0
271	31201	ABBOTSTOWN ROAD (NW-EA)	D11	Traffic Calming	on the road.	09/05/2016	Stage 2	0
272	31206	ALBERT COLLEGE PARK (NW-EA)	D9	Double Yellow Lines	on one side of the road.	17/05/2016	Stage 2	0
273	31209	WALNUT LAWN (NW-EA)	D9	Double Yellow Lines	opposite No. 11.	17/05/2016	Stage 2	0
274	31210	CABRA ROAD (NW-EA)	D7	Yellow Box	at the junction of Cabra Road and Dowth Avenue.	17/05/2016	Stage 2	0
275	31211	WESTWOOD ROAD (NW-EA)	D11	Children Crossing Sign	at the entrance to Westwood Road from Ratoath Road.	17/05/2016	Stage 2	0

Item	Ref	Road	Post-code	Topic	Request Description	Date Rec'd	SR Status	No. Secondary Requests
276	31216	BALBUTCHER LANE (NW-EA)	D11	Yellow Box	at the junction of Carton Drive and Balbuthcer Lane.	17/05/2016	Stage 2	0
277	31257	RATOATH ROAD (NW-EA)	D7	Bus Stop Marking	at Dublin Bus No. 7027.	06/05/2016	Stage 2	0
278	31312	MILLMOUNT VILLAS (NW-EA)	D9	Double Yellow Lines	On Millmount Villas across the garage entrance to No. 48 Millmount Avenue.	12/05/2016	Stage 2	0
279	31350	SHANTALLA ROAD (NW-EA)	D9	Stop Sign	at the roundabout at the junction of Shantalla Road and Swords Road.	09/05/2016	Stage 2	0
280	31354	ALBERT COLLEGE DRIVE (NW-EA)	D9	Double Yellow Lines	at Albert College Court.	09/05/2016	Stage 2	0
281	31364	MAGENTA CRESCENT (NW-EA)	D9	Traffic Calming	traffic calming measures at the entrance	16/05/2016	Stage 2	0
282	31378	SAINT CLEMENTS ROAD (NW-EA)	D9	Double Yellow Lines (Rescind)	from outside No. 1.	17/05/2016	Stage 2	0
283	31415	FAUSSAGH AVENUE (NW-EA)	D7	Parking Prohibition	on the road.	17/05/2016	Stage 5	0
284	31514	SHANOWEN ROAD (NW-EA)	D9	Yellow Box	at the entrance to Shanowen Hall Student Residence	07/04/2016	Stage 2	0
285	31555	CABRA ROAD (NW-EA)	D7	Double Yellow Lines	across entrance to property No. 123	25/05/2016	Stage 2	0
286	31715	SHANOWEN ROAD (NW-EA)	D9		on above junction	31/05/2016	Stage 2	0
287	31717	SHANOWEN CRESCENT (NW-EA)	D9	Double Yellow Lines	at the entrance	31/05/2016	Stage 2	0
288	31760	BALLYGALL PARADE (NW-EA)	D9	Speed Ramps	on above road	03/06/2016	Stage 2	0
289	31827	LORCAN ROAD (NW-EA)	D9	Children Crossing Sign	on above road	08/06/2016	Stage 2	0
290	31910	BALLYMUN ROAD (NW-EA)	D11	Double Yellow	between house number 18 and 20	10/06/2016	Stage 2	0

Item	Ref	Road	Post-code	Topic	Request Description	Date Rec'd	SR Status	No. Secondary Requests
				Lines				
291	32027	NAVAN ROAD (NW-EA)	D7	Bus Lane	Bus Time Improvement Scheme including Bus Lane between Skreen Road and Nephin Road and No Right Turn from Navan Road onto Skreen Road.	16/06/2016	Stage 2	0
292	32052	MILLBOURNE AVENUE (NW-EA)	D9	Pay & Display & Permit Parking	change stat from nose to kerb to parallel parking	16/06/2016	Stage 5	0
293	32074	SHANOWEN ROAD (NW-EA)	D9	Double Yellow Lines	at Shanowen Hall Apartments.	20/06/2016	Stage 2	0
294	32075	MARGUERITE ROAD (NW-EA)	D11	Double Yellow Lines	in laneways (see email).	20/06/2016	Stage 4	0
295	32108	POPPINTREE CRESCENT (NW-EA)	D11	Traffic Calming	on Poppintree Crescent and Belclare Avenue.	13/06/2016	Stage 2	0
296	32113	COOLOCK LANE (NW-EA)	D9	Right Turn Filter Light	from Coolock Lane into Oarkpark Estate.	13/06/2016	Stage 2	0
297	32174	CHURCH AVENUE (NW-EA)	D9	Parking Prohibition	at St Mobhis Church, Church Avenue, Ballymun.	21/06/2016	Stage 2	0
298	32352	DRUMCONDRA ROAD UPPER (NW-EA)	D9	Double Yellow Lines	Outside The Nest Creche 27 Upper Drumcondra Rd	27/06/2016	Stage 2	0
299	32356	WELLMOUNT ROAD (NW-EA)	D11		Request to review vehicle entrance to St Michaels School in respect of approaching cyclists.	28/06/2016	Stage 2	0
300	32375	SAINT ITA'S ROAD (NW-EA)	D9	Disabled Parking Bay (Residential)	outside No.14	29/06/2016	Stage 2	0

Item	Ref	Road	Post-code	Topic	Request Description	Date Rec'd	SR Status	No. Secondary Requests
301	32428	CONNAUGHT STREET (NW-EA)	D7	Double Yellow Lines	There are no DYL's at laneway to the side of phibsboro shopping centre, cars are blocking access to an adjoining private laneway.	30/06/2016	Stage 4	0
302	32440	SHANDON PARK (NW-EA)	D7	Double Yellow Lines	Request for DYL's outside 114 shandon Park (request also in for repainting of existing ones at side of house SR 32438)	01/07/2016	Stage 2	0
303	32454	LEIX ROAD (NW-EA)	D7	Engineer Query	Request for engineer to look at putting rush hour restrictions at the above area, and also for engineer to put plans for increased parking into the area for when the LUAS station opens.	04/07/2016	Stage 2	0
304	32455	DOWTH AVENUE (NW-EA)	D7	Parking Prohibition	Request for parking restrictions at above road due to issues for the local residents as a result of illegal parking, and no parking restrictions.	04/07/2016	Stage 2	0
305	32458	DOWTH AVENUE (NW-EA)	D7	Speed Ramps	Request for speed ramps for above road as cars using it as a rat run.	04/07/2016	Stage 2	0
306	32523	MARLBOROUGH ROAD (NW-EA)	D7	Continuous White Line (Rescind)	on Marlborough Road at junction with North Circular Road	05/07/2016	Stage 2	0
307	32555	CREMORE HEIGHTS (NW-EA)	D11	Double Yellow Lines	at 1-29 on the church side of the road.	19/07/2016	Stage 2	0

Item	Ref	Road	Post-code	Topic	Request Description	Date Rec'd	SR Status	No. Secondary Requests
308	32558	SWORDS ROAD (NW-EA)	D9	Pedestrian Crossing	update request for the pedestrian crossing.	19/07/2016	Stage 2	0
309	32578	ARRAN ROAD (NW-EA)	D9	Disabled Parking Bay (Residential)	outside No. 28.	07/07/2016	Stage 2	0
310	32668	KEMPTON AVENUE (NW-EA)	D7	Double Yellow Lines	in the estate	12/07/2016	Stage 2	1
311	32669	BALLYMUN ROAD (NW-EA)	D9	Yellow Box	outside No.23	12/07/2016	Stage 2	0
312	32696	SHANOWEN ROAD (NW-EA)	D9	Double Yellow Lines	Outside number 190	13/07/2016	Stage 2	0
313	32698	HOME FARM PARK (NW-EA)	D9	Double Yellow Lines	Double yellow lines at entrance to Home Farm Park	13/07/2016	Stage 2	1
314	32986	PROSPECT SQUARE (NW-EA)	D9	Double Yellow Lines	Committee requests that DYLS be marked around bend of Prospect Sq. and St. Teresa Road	28/07/2016	Stage 2	2
315	33054	SWORDS ROAD (NW-EA)	D9	Pedestrian Crossing	at Comet Pub	28/07/2016	Stage 2	0
316	33058	ANNALY ROAD (NW-EA)	D7	Double Yellow Lines	request DYLS from stop sign towards his house	29/07/2016	Stage 2	0
317	33149	WELLMOUNT ROAD (NW-EA)	D11	Pedestrian Crossing	Request for pedestrian crossing	04/08/2016	Stage 2	0
318	33153	TOLKA COTTAGES (NW-EA)	D11	Disabled Parking Bay (Residential)	opposite property No. 12.	08/08/2016	Stage 2	0
319	33282	SWORDS ROAD (NW-EA)	D9	Pedestrian Crossing	Extra crossing.	16/08/2016	Stage 2	0
320	33312	KINVARA AVENUE (NW-EA)	D3	Right Turn Filter Light	from Kinvara Avenue, see comments on	17/08/2016	Stage 2	0

Item	Ref	Road	Post-code	Topic	Request Description	Date Rec'd	SR Status	No. Secondary Requests
					previous SR2010.			
321	33325	CHARLEVILLE ROAD (NW-EA)	D7	Double Yellow Lines	at corner of Charville Rd turning on to Cabra Rd.	18/08/2016	Stage 2	3
322	33343	CHURCH AVENUE (NW-EA)	D9	Double Yellow Lines	DYs for Church Avenue, between 11 Church Ave and 2 Ballymun Rd.	18/08/2016	Stage 2	0
323	33368	CABRA ROAD (NW-EA)	D7	Disabled Parking Bay (General)	in the vicinity of St. Peter's Avenue.	24/08/2016	Stage 4	0
324	33459	NAVAN ROAD (NW-EA)	D7	Yellow Box	at bus stop 1660 outbound.	30/08/2016	Stage 2	0
325	33466	MILLBOURNE AVENUE (NW-EA)	D9	Disabled Parking Bay (General)	Request to relocate a general disabled parking bay from outside the library to outside the health centre.	30/08/2016	Stage 2	0
326	33681	MAREWOOD CRESCENT (NW-EA)		Speed Cushions	Need higher ramps to slow down cars.	09/09/2016	Stage 1	0
327	33718	GLASANAON ROAD (NW-EA)	D11	School Warden	at Geal Scoil Ui Earcain.	12/09/2016	Stage 1	0
328	33719	GLASANAON ROAD (NW-EA)	D11	School Warden Crossing Box	at the main entrance to Gael Scoil Ui Earcain.	12/09/2016	Stage 1	0
329	33720	GLASANAON ROAD (NW-EA)	D11	Double Yellow Lines	at the junction of Glasanaon Road and Clasanaon Park.	12/09/2016	Stage 1	0
330	33723	BEAUMONT ROAD (NW-EA)	D5	Filter Light	for turning right and left to go into Beaumont Hospital from Beaumont Road.	12/09/2016	Stage 1	0
331	33733	MILLMOUNT AVENUE (NW-EA)	D9	Pedestrian Crossing	Request for above at Millmount House on the Fagans side of the	09/09/2016	Stage 1	0

Item	Ref	Road	Post-code	Topic	Request Description	Date Rec'd	SR Status	No. Secondary Requests
					road!			
332	33735	GRIFFITH AVENUE (NW-EA)	D9	Pedestrian Crossing	Request for another ped crossing south of the junction of Griffith Avenue and Drumcondra Road Upper.	13/09/2016	Stage 1	0
333	33738	SWORDS ROAD (NW-EA)	D9	Pedestrian Crossing	Request to stagger the Pedestrian Crossing on Swords Road near the entrance to Gaeltacht Park at Boyle Sports.	13/09/2016	Stage 1	0
334	33783	VIOLET HILL DRIVE (NW-EA)	D11	Double Yellow Lines	request for DYLS	14/09/2016	Stage 1	0
335	33815	BALLYMUN ROAD (NW-EA)	D11	Yellow Box	at the junction of St. Pappin Road.	12/09/2016	Stage 1	0
336	33881	NAVAN ROAD (NW-EA)	D7	Traffic Calming	from Cabra Cross to Ashtown	15/09/2016	Stage 1	0
337	6328	RIVER ROAD (NW-EA)	D15	Speed Ramps	additional Ramp around the corner from Pelletstown Manor.	25/02/2013	Stage 3	6
338	6358	SHANGAN ROAD (NW-EA)	D11	Traffic Lights	At junction of Balbutcher Lane and Balcurris Road	04/03/2013	Stage 2	3
339	6375	BALBUTCHER LANE (NW-EA)	D11	Traffic Lights	at junction of Sillogue Road.	28/02/2013	Stage 5	0
340	6706	BALCURRIS ROAD (NW-EA)	D11	Pedestrian Refuge Island	At pedestrian lights at rear of Ballymun Shopping Centre facing Plunkett Tower	27/03/2013	Stage 5	0
341	7855	CARRIG ROAD (NW-EA)	D13	Speed Ramps	between Knowth & Druid Court.	26/06/2013	Stage 5	1
342	8014	SHANTALLA DRIVE (NW-EA)	D9	Parking Prohibition	outside Mace shop.	17/07/2013	Stage 5	3

Item	Ref	Road	Post-code	Topic	Request Description	Date Rec'd	SR Status	No. Secondary Requests
343	8263	IONA ROAD (NW-EA)	D9	Traffic Island	Request for traffic island or build out at the junction of Crawford Avenue.	08/08/2013	Stage 5	1
344	8385	CRANOQUE ROAD (NW-EA)	D11	Speed Ramps	Appeal to S.R 6320 - Reps for Ramps on Cranogue Road	19/08/2013	Stage 2	1
345	8665	OLD CABRA ROAD (NW-EA)	D7	Traffic Calming	Request for traffic calming measures at the junction of North Circular Road/Old Cabra Road/Prussia Street, at Hanlon's Corner.	12/09/2013	Stage 2	0
346	8673	SAINT PATRICK'S ROAD (NW-EA)	D9	No Left Turn	Request for no left turn from St. Patrick's Road onto Whitworth Road, during morning peak.	12/09/2013	Stage 4	1
347	8810	COULTRY DRIVE (NW-EA)	D9	Speed Ramps	close to No. 27.	07/10/2013	Stage 5	2
348	9683	BALBUTCHER LANE (NW-EA)	D11	Traffic Calming	at its junction with Carton Terrace/Carton Drive.	02/12/2013	Stage 5	0
349	9921	CRAWFORD AVENUE (NW-EA)	D9	Buildout	near the junction of Iona Road.	06/12/2013	Stage 5	0

**The Chairman and Members of
North West Area Committee.**

Meeting: 18th October 2016

Item No: 18

						North West Oct Area Agenda 18/10/16 (TAG 27/09/16)					
Item	Request	Ref	Road	Post- code	Topic	Request Description	Request by	TAG Result	TAG Comments	Sec	Date Rec'd
1	Parking Prohibitions	16157	BOTANIC VILLAS (NW-EA)	D9	Double Yellow Lines	on one side of Botanic Villas between Nos. 120 and 124 Botanic Road.	cllr Rock	Not Recommended	The laneway / area at Botanic Villas is a "private road" i.e. not taken in charge by Dublin City Council . As such Dublin City Council / Parking Enforcement Department have no direct involvement with the lane between 120 Botanic Avenue and 124 Botanic Avenue off Botanic Avenue.	0	20/01/2015
2	Parking Prohibitions	33368	CABRA ROAD (NW-EA)	D7	Disabled Parking Bay (General)	in the vicinity of St. Peter's Avenue.	resident	Recommended	Disabled bay recommended on the south side of Cabra Road from the eastern boundary of No. 30 for 6m westwards.	0	24/08/2016
3	Parking Prohibitions	19859	GLASILAWN AVENUE (NW-EA)	D11	Loading Bay	Outside 19 Glasilawn Avenue, Dublin 11	resident	Recommended	It is recommended to install a Loading Bay on Glasilawn Ave: East side, near Village Home Bakery, from lamp standard no 39: Mon-Sat 07:00-19:00 southwards for 8.7m.	1	27/08/2015
4	Parking Prohibitions	30638	HOLLYBANK ROAD (NW-EA)	D9	Disabled Parking Bay (Residential)	Outside No. 72.	resident	Recommended	Rescind Pay & Display/Permit parking on the southern side of Hollybank Road from the common boundary of 70-72 for a distance of 6m west. Install disabled bay on the southside of Hollybank Road from the common boundary of 70-72 extending to a point 6m west.	0	08/04/2016

5	Traffic Conditions	15541	KILDONAN ROAD (NW-EA)	D11	Yellow Box (Extend)	request yellow box be enlarged.	dublin bus	Recommended	Dublin Bus request stat to increase the yellow box at Mellows Rd / Kildonan Rd to allow buses to exit Kildonan Rd from the North and turn west onto Mellows Rd. It is required to increase the size of the yellow box on both sides of the Mellows Rd carriageway at Kildonan Road. Extend yellow box south by 4.2 metres from the southeast corner of the yellow box and extend yellowbox west by 9.2 metres and extend yellow box north from this point 4.2 metres.	0	25/11/2014
6	Parking Prohibitions	32027	NAVAN ROAD (NW-EA)	D7	Bus Lane	Bus Time Improvement Scheme including Bus Lane between Skreen Road and Nephin Road and No Right Turn from Navan Road onto Skreen Road.	dcc sustainable traffic unit	Recommended	As part of Bus Time Improvement measures between Skreen Road and Navan Road: Measures to include a Cycle Lane and Bus Lanes in the outbound carriageway, Continuous white line and a No Right Turn (24 Hours) from Navan Road onto Nephin Road.	0	16/06/2016
7	Parking Prohibitions	30540	OWENSILLA TERRACE (NW-EA)	D11	Disabled Parking Bay (Residential)	at No. 6.	resident	Recommended	Install Disabled Bay on the Eastern side of Owensilla Terrace from a point opposite 1m north of the southern boundary of property no. 7 and extending northwards for 7m.	0	31/03/2016



**The Chairman and Members of
North West Area Committee.**

Meeting: 18th October 2016

Item No: 22

Ballymun Area Office Report October 2016

- 1. Community Update**
- 2. Housing/Estate Management**
- 3. Ballymun Economic Development/Town Civic Alliance**
- 4. Safer Ballymun/Drumcondra Glasnevin**

1. Community Update

General Community Activities

LECP Consultations: Three area based consultations were organised and collaboratively run by NWA Community Staff Members and NWAP Staff in relation to the LECP 2016/17 and took place as follows: Finglas Area: 14th September 11-1pm, Ballymun Area: Civic Offices: 19th September 2pm-4pm, Cabra Area: Blind Village: 26th September 7-9pm. All of these consultations which were based around the twelve high level goals set out in the LECP were open to residents and community groups from all areas of the North West Area. Further surveys were carried out in Drumcondra and sent out to various groups within the area. Feedback is being collated at present.

Community Grants Scheme 2016: The Community Development General and Adult Education Grants have been sent out to all relevant community groups in the Ballymun, Whitehall, Santry and Drumcondra areas. A number of new community groups have been identified and we aim to support these groups through the grant scheme and through relevant contact throughout the year.

The Ballymun Fun Run was organised by the Sports Development Officers and the Community Development Team in collaboration with local schools/youth projects and took place on Wednesday the 21st September between 10am and 12pm. It was a good success with over two hundred and fifty local children in attendance.

Social Inclusion

Older People

Positive Aging Week took place between Monday the 26th September and Wednesday the 5th October 2016. The Positive Aging Week Committee (strongly supported by the Community Team Members) met throughout the year and put together a fabulous programme of events/activities for older people in the local area. The Programme included a Ballroom of Romance (in Setanta), a pampering morning and a Film Showing (in Axis), a Mystery Tour, a Quiz (in Burren Court), a walk in Santry Woods and an afternoon music session in Marewood Court.

The Community Team organised a Gala Concert which took place on Friday the 30th September from 8pm-10pm in the Atrium of the Civic Buildings. The Deirdre Duffy School of Irish Dancing, The Monday Club Male Choir, Katie and Declan Rooney and the Dublin Airport Singers provided a colourful array of music and dance that was enjoyed by all. It attracted older people from the area and was a huge success. The Community Team worked with DCU and Third Age on a community event, known as Operation Conversation, which took place on Saturday the 1st October from 2-4pm in Albert College Park. This Family Event aimed to breakdown some of the barriers between young people and older people, dispel myths and promote a health intergenerational conversation. The event was attended by a number of local community groups and youth agencies as well as members of Comhairle Na N'Og. Community Team members attended and manned an information stand at an Information Fair for Older People on Friday the 23rd September in Corpus Christi Parish Hall in Drumcondra. Follow up meetings in relation to Community Activities were arranged at this event with a number of local community groups. General Meetings took place with Active Living Group, BADIG.

Mens Sheds: There is ongoing contact with the Ballymun Mens Shed in relation to their proposed new premises in the DCU Community Garden. Community Team members attended an advocates men sheds meeting with the IMSA and graduated from a Community Leadership Certificate along with men sheds advocates from all over the country. An initial meeting took place with St Michaels House in relation to setting up a Mens sheds for users of the service.

Baile Na Laochra Residents: Community Team members have been working on a collaborative project with DePaul Ireland, O Cuileann Housing and Poppintree Youth Project to engage the young people of

Baile Na Laochra in the upcoming Otherworld Festival. Two art/crafts workshops have been arranged and will take place in Poppintree Youth Project whereby the young people with design craft items to be displayed at the Otherworld Festival. The Residents will also be encouraged to take part in the Parade this year (Balbutcher Side). The young people will also take part in a community mural activity to brighten up the hoarding at the boundary of Baile Na Laochra and O Cuileann Site. Contact details for DePaul Ireland are Graham Fitzgerald Depaul Community and Outreach Services - Ballymun Case Management Team 01 8916103 ie.depaulcharity.org.

Events/Festivals

There are ongoing meetings with the Ballymun Festival Steering Committee in relation to the Otherworld Festival. The Event is in the final stages of planning and many community groups have been approached to take part in the parade and event this year. Ongoing meetings are also taking place with the Gardai, Event Organisations, Vendors, and Security Firms. The Festival will run on similar lines to last year with extra effort being put into a revamped Parade. The local youth projects are linking again with Axis this year to create an Enchanted Forest. Among the new groups involved are the Sillogue Ladies Group who will be setting up a Witches Brew Café, Doon Court Residents and the Baile Na Laochra Residents.

Environmental Initiatives

Continued linking with local environmental groups around the local area which are continuing to grow and flourish. A good number of local groups won prizes at the City Neighbourhoods Competition and the Tidy Towns Competition.

2. Housing/Estate Management Updates

Ballymun Rent Assessment Update	
	September 2016
Assessments	263
Permission To Resides	5
Refunds	14
Opening of Accounts	17
Closing of Accounts	8
Front Counter Calls	398
Window Replacements	3

C.C.T.V

The C.C.T.V system is working well. The system has undergone its scheduled PPM in the last number of weeks – this work included checking all of the cameras and updating the monitoring station in the control room.

Cleansing / Waste Management

Waste Management and the area office are continuing to combat illegal dumping at open spaces. These measures include using the C.C.T.V system to monitor and identify those responsible. The area office has targeted illegal dumping around Shangan, Termon and Knowth Court and a number of tenants have been called and warned about their behaviour.

Ballymun Lettings January - September 2016

Allocation Category	Housing List	Transfer List
Band 1 Priority		
Welfare	6	1
Travellers	2	
Surrendering Larger	1	1
Medical	6	2
Homeless	10	
Regen		2
Band 2	8	5
Band 3	12	12
Sub Total	45	23
Total Lettings	68	

Estate Management January - September 2016

No of Anti social complaints per 1997 act Drug Related	32
No of Anti social complaints per 1997 act Not Drug Related	163
No of other Complaints	
Total Complaints	170
No of Anti Social Interviews per 1997 act	77
No of Other Interviews	27
Total Interviews	104
No of Requests for mediation	1
No of Complaints referred to central unit for Action	2
No of Section 20 Evictions	
No of excluding Orders applied for by Tenant	
No of Excluding orders applied for by DCC	
No of surrender of Tenancies due to Anti Social Behaviour	
No of Notice to Quits sent to Central Unit	
No of Court Orders Granted	
No of Appeals / Judicial Reviews Challenges	
No of Warrants executed (Evictions)	

Ballymun Voids

Address	Number	Type	
Ballygall Parade	87	2 Bed	Under Repair
Belclare Park	43	3 Bed	Under repair
Collins Place	30	3 Bed	On Offer
Coultry Drive	29	3 bed	Under repair
Coultry Drive	87	2 Bed	Under repair
Coultry Drive	96	2 bed	Under repair
Griffith Road	21	2 bed	Under repair
Hampton Wood Ave	103	1 Bed	
Hampton Wood Rd	11	2 Bed	
Longdale Terrace	3	2 bed apt	Under repair
Marewood Crescent	64	1 Bed	Under repair
Shangan Avenue	34	1 bed	Under repair
Shangan Road	323	2 bed	Under repair
Shantalla Road	66	3 bed	Under Repair
Silloge Green	3	1 Bed	Under Repair
Senior Citizens			
Albert College	30	OPU	
Domville Court	3	OPU	
Domville Court	11	OPU	
Sandyhill Gardens	3	O.P.U	On Offer
Sandyhill Gardens	4	O.P.U	
Sandyhill Gardens	20i	O.P.U	On Offer
Pyrite Refurb			
Sandyhill Terrace	5		
Doon Court	8		
Owensilla	53		
Pyrite Long Term			
Carton Court	12		
Carton Terrace	6		
Carton Road	10		
Owensilla	3		

Pyrite

Pyrite works have started in the Carton Area on the first five houses. Families were moved temporarily into the local area and are expected to be back home before Christmas. All residents will be informed of potential move dates and phases in the coming weeks. This will be done by letter drop and calling door to door. Any enquiries on same can contact Connell McGlynn on 01- 222 5730.

Halloween

The Cleansing Section and the Public Domain Section in conjunction with the Area Offices is putting plans in place to tackle illegal dumping ahead of Halloween, in particular the removal of any potential bonfire material. An information campaign is ongoing in industrial estates and housing estates to highlight the need to keep all sorts of materials secure and prevent illegal dumping also.

Coultry/Shangan/Forestwood

The local office is engaging with new community groups in Shangan, Whiteacre and Coultry which has resulted in new neighbourhood initiatives such as clearing parking bays, tree pits and footpaths. Work on clearing the tree pits in Forestwood and Sallowood is now complete. Residents continue to work to keep these areas tidy, work on planters and monitor the upkeep of gardens and green spaces also. Most areas now have active residents involved in keeping the area in good shape. Dublin City Council continues to supply equipment and planting materials required. Dublin City Council are currently getting tenders/prices to have all houses treated and washed in the Woodhazel and Coultry Terrace areas.

Poppintree/Courts

The Parks Section in conjunction with the Community and Public Domain Sections around Dolmen court has been installing tree planters. Local residents are busy painting boundary walls and keeping green areas and gardens tidy. A number of painting and environmental projects have taken place in Poppintree in conjunction with the Public Domain and Community Sections. This has made a phenomenal difference to the lives of the people in the surrounding areas. It has helped bring communities together and enabled people to take pride in their areas, as well as being a factor in alleviating dumping in some of the more problematic areas. Paint, clean up equipment, and plants are supplied by DCC, who also remove bags after clean ups. A number of these projects include Doon Court, Belclare Grove and Belclare Park, all of which have won prizes in the City Neighbourhood Awards.

Residents have started painting and planting work in Knowth Court and Graigue Court and they hope to enter awards next year. If residents are interested in doing painting/environmental projects in the Ballymun/Santry/Whitehall area contact Astrid Green 2225715 Public Domain or the Community Section 2225725/2228526.

The Parks Section is still monitoring the pond in Poppintree for pollution. To date there have been no further reports of illegal dumping there.

3. Ballymun Economic Development/Town Civic Alliance

Economic Strategy

The Economic Sub-Committee met on 4th October 2016 and there were updates from Annabelle Conway, Innovate Dublin and Mick Creedon, Ballymun Jobs Centre, who gave a presentation on unemployment.

Stimulating Economic Activity

Free Wi-Fi for the Plaza: The kit for the Wi-Fi is being ordered and Eircom have been contacted to free up the line.

Vacant Neighbourhood Retail Units: The Economic Development Officer now has access to the vacant DCC units. A brochure has been produced to market each of the units and "To Let" signs have been produced. The current status of the vacant DCC units is:

Location	Ownership	Status	Comments
Coultry Unit B	DCC	T&C's offered for a new café	Planning has been approved for a new café in Coultry.
Coultry Unit C & D	DCC	Vacant	This unit is almost ready for letting
Shangan Court Unit 2	DCC	Occupied	This unit is almost ready for letting
Turnpike Santry Cross Unit 3	DCC	Vacant	Dog's Aid are applying for Planning permission
Silloque, Unit 3	DCC	Vacant	This unit is available for viewing by prospective tenants
Unit 9 & 10 Main St.	Private	For sale (POA)	Tenants (Boyle Sports & Dynasty Chinese) unaffected, 3,154 sq. ft.
Unit 1, Gateway	Private	Vacant	KPM Management co.
Unit 2, Gateway	Private	For sale (€75,000) – sale agreed	Tenant (Miami Sun) 1 year into a 5 year lease, 546 sq. ft.
Unit 6, Gateway	Private	Sale agreed	Tenant (Ridgeway Barber) unaffected , 560 sq. ft.
Santry Cross	Private	For sale ((700k) or rent (70,000)	Core shell with 4 car parking spaces, 7,347 sq. ft.
St. Pappins	Private	Sale agreed	

Enterprise Unit database

A database of all publicly and privately owned units in Ballymun is now completed. The database includes:

- Location map
- Drawings
- Photos
- Owner details
- Status (Receivership / available etc.)

‘StartUp Ballymun’ October 2016

- Robert Murphy will open the event
- Topics will include growing your business in a digital world
- There are 5 speakers confirmed to date with more to follow
- Salvatore Fanara, MD of Travelling Languages, www.travellinglanguages.com - your language school on the road....
- Lorcan Bannon, Head of Client Strategy, Olytico, www.olytico.com - Social media listening

- Ross Killeen, MD Event Junkies, www.eventjunkies.ie, a one-stop shop for production, shooting and editing needs, with a quick turnaround
- Elaine Cohalan, Dublin Cookie Company, www.thedublincookieco.com freshly baked cookies to order or buy in their cookie shop 29 Thomas St.
- Auveen Bell, Social Enterprise & Co-Founder of Blossom Ireland, www.blossomireland.ie, therapy-led camps and after school activities for children with intellectual disabilities aged 8 to 18 Currently serving all of Dublin, with plans to extend services nationwide

In addition, there will be information about the €2.5k website grant and free one to one business mentoring.

Ballymun4Business (B4b)

- The network meets every two weeks
- There are now 28 active members
- A tender for a new website has just been made public
- A Communications Administrator will be recruited through Job Bridge

Civic Alliance Update

A meeting of the Physical/Environmental Sub Committee took place on 22nd September. Issues discussed included an update on the LAP and the Boiler House Project, as well as an update on the progress of the Ballymun Town Centre Wi-Fi Project. A meeting of the Economic Sub Committee took place in the Civic Centre on the 4th October. The Economic Development Officer, Liam Barry, gave updates on the Economic Development Plan, vacant units and the short term initiatives for Economic Regeneration. It was reported that the Northern Site will be back on the market in the coming days and the CPO oral hearing for the Shopping Centre will commence on October 26th.

4. Safety Fora

Safer Ballymun

The next meeting of the Safer Ballymun community Safety Forum will take place on Tuesday October 18th in the Council Chamber, Ballymun Civic Centre. The Deputy Mayor will be in attendance on the night to launch Safer Ballymun Week. There is a wide programme of events planned for the week from Monday 17th October to Saturday 22nd October. Events include an Inter Agency soccer match, a senior citizens safety talk, a BADIG information afternoon and a Garda Station Open Day.

Drumcondra Glasnevin Community Forum

The most recent meeting of the Drumcondra/Glasnevin Community Forum took place on Wednesday September 28th in the Maples Hotel, Drumcondra. The meeting was chaired by Donal Barron and the Gardaí present gave statistics for the period from the last meeting on June 29th. Issues discussed on the night included anti-social behaviour in the area and the recent traffic survey and consultants report in relation to traffic issues in the area. The final meeting of the year is scheduled to take place on Wednesday 7th December.

Mary Taylor

Assistant Area Manager

**The Chairman and Members of
North West Area Committee.**

Meeting: 18th October 2016

**Development Department
Civic Offices**

Item No: 23

With reference to the proposed grant of a further licence of part of 133A Slaney Road, Glasnevin, Dublin 11 to Eco Mattress Recycling Limited.

By way of Agreement dated 25th November 2015 part of the premises at 133A Slaney Road, Glasnevin, Dublin 11 which said part is more particularly delineated on Map Index No. SM2011-0638 was let under licence by Dublin City Council to Eco Mattress Recycling Limited for use as a mattress recycling facility for a period of 6 months from 25th November 2015 and subject to a licence fee of €1,000 plus VAT.

This licence was extended for a further period of six months pending a decision by the Environment & Transportation Department on whether or not a longer letting should be proposed.

The current licence is due to expire on the 24th November 2016 and at the recommendation of the Environment & Transportation Department it is proposed to grant a further licence of part of the premises at 133A Slaney Road, Glasnevin, Dublin 11 to Eco Mattress Recycling Limited subject to the following terms and conditions:

1. The licence shall commence on 25th November 2016 for a period of 5 years.
2. The licence fee payable shall be the sum of €2,000 (two thousand euro) plus VAT per annum payable semi annually in advance.
3. The licensed area shall be used as a mattress recycling facility only. The licensee shall not permit the licensed area to be used for any other purpose.
4. Four car parking spaces shall be included in the licensed area for use by Eco Mattress Recycling Limited only. Vehicles are parked at their owners risk and the Council shall not be responsible for any loss or damage to vehicles or their contents.
5. The licensee shall be responsible for all outgoings associated with its use of the licensed area including taxes, utilities, water, insurance, waste disposal, agreed security costs and 1/3 of the Municipal Rates assessed on the entire premises within which the licensed area is situated.
6. The licensee shall carry out at its own expense any works necessary to render the licensed area fit for the licensee's proposed use and shall be responsible for all internal maintenance and repairs.
7. The licensee shall secure the licensed area throughout the licence period to the satisfaction of the Council.

8. The licensee shall indemnify the Council against all claims as a result of their use of the licensed area and shall obtain a high level of Public Liability Insurance and Employers Liability Insurance and the Council will have an absolute right to set a minimum level of public liability and employers liability insurance and to review the figures on a yearly basis (the current minimum levels are €6.5 million and €13 million respectively).
9. The Council shall not be responsible for any loss or damage to any goods, materials, vehicles and machinery on the licensed area.
10. Keys to the premises shall only be held by employees of Eco Mattress Recycling Limited who shall be responsible for all security issues associated with their use.
11. The licensee will ensure that the highest levels of Health & Safety standards shall apply to the use of the licensed area and access area and that noise levels do not disturb adjoining property owners.
12. The licensee shall keep the licensed area in a reasonably tidy condition during the licensed period. At the end of the licence period the licensee shall at it's own expense remove all materials not belonging to Dublin City Council and shall leave the property clean and cleared.
13. Each party shall be responsible for their own fees and costs incurred in this matter.
14. The Council reserves the right to terminate the licence on giving one months notice in writing to the licensee.
15. The licensee shall be obliged to sign a Renunciation of Rights to a new tenancy.
16. This licence shall be personal to the licensee and shall not be capable of transfer, sub-licence, assignment, mortgage or charge.
17. The above proposal is subject to any other terms and conditions deemed appropriate by the Council's Law Agent in agreements of this type.

Mr. Paul Clegg
Executive Manager

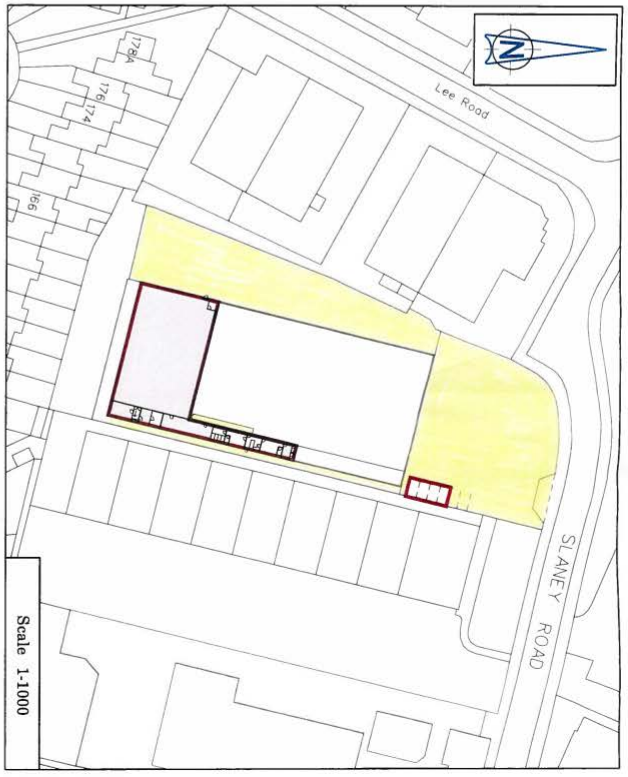

Dublin Industrial Estate, Slaney Road - Premises No. 133A
 Dublin City Council to Eco Mattress Recycling Ltd
 Right of Access over areas coloured yellow

DUBLIN CITY COUNCIL
 Comhairle Cathrach Bhaile Átha Cliath
 ENVIRONMENT AND ENGINEERING DEPARTMENT
 An Roinn Comhaltaithe agus Innealtóireachta
 Roinnín Sárthéarmaíochta agus Léarscálaithe
 Survey and Mapping Division

O.S. REF	3197-08	SCALE	1:1000 1:500
DATE	15-08-2012	SURVEYED BY	J. Kelly
PRODUCED BY	J. Kelly		
FILE NO	SM-2011-0638-0204-C03	INDEX NO	001 - A.dgn

MICHAEL PHILLIPS
 CITY ENGINEER
 Approved
PATRICK SHINE
 MANAGER LAND SURVEYING & MAPPING
 INDEX No.
 SM-2011-0638

OSi data : © Ordnance Survey Ireland. All rights reserved. Licence Number 2012 / 22 / CCMA / Dublin City Council

This page is intentionally left blank

**The Chairman and Members of
North West Area Committee.**

Meeting: 18th October 2016

Item No: 24

Wider Area Traffic Cell Analysis of Walsh Road, Ferguson Road and Millmount Avenue, Drumcondra

Report on Submissions from Members of the Public



Table of Contents

1	Introduction.....	1
1.1	Project Background	1
1.2	Public Information Events.....	1
2	Submissions	1
2.1	Introduction	2
2.2	Approach to the Review of Submissions	2
2.3	Option Preferences	2
2.4	Supportive Feedback.....	3
2.5	Opposed Feedback	4
2.6	Other Issues	7
3	Conclusion.....	8

2 Submissions

1.1 Project Background

Six options were developed to address the study objectives. The options presented are summarised below.

Option 1 - Staggered Parking

This option proposes the introduction of formalised and staggered on-street parking on the road which could act as a traffic calming feature and curtail vehicular speeds as motorists must manoeuvre around the parked vehicles.

Option 2 - Traffic signals

This option proposes the introduction of a sequence of traffic signals at the bottom of Walsh Road/Ferguson Road which could be used to create a shuttle system and create a delay for vehicles rat running through the area.

Option 3 - Circuitous route

This option proposes the creation of a circuitous route through the area by introducing a number of obstructions which could be planter boxes or bollards again with the aim of creating a delay for rat runners.

Option 4 - Road Closure on Walsh Road

This option proposes the closure of the Walsh Road /Home Farm junction.

Option 5 - Road Closure on Ferguson Road

This option proposes the closure of Ferguson Road / Home Farm junction.

Option 6 - Road Closure on Millmount Avenue/Millbourne Avenue

This option proposes the closure of Millmount Avenue/Millbourne Avenue at the Ferguson Road junction.

A report¹ was prepared assessing the merits of each of the options. Option 6 was identified as the most appropriate in terms of meeting the objectives for this scheme. A number of information sessions were organised to inform and obtain views on Option 6 and the other options.

1.2 Public Information Events

Two public information events were held in Drumcondra Library from 4:45-7:30pm on the 19th July and the 6th September 2016. The events were attended by personnel from **Dublin City Council and AECOM**.

All six options were on display in the Library at the events. Option 6 was identified as the emerging preferred option. The purpose of the events was to obtain views on the proposals and respond to any feedback provided.

¹ AECOM Options Report Wider Area Traffic Cell Analysis of Walsh Road, Ferguson Road and Millmount Avenue, Drumcondra

2.1 Introduction

Attendees at the public information events were encouraged to fill in a comment sheet provided on the evenings or to submit their comments via email to Dublin City Council. Submissions were accepted up to the 13th September. A total of 473 submissions were received by the deadline.

2.2 Approach to the Review of Submissions

The following outlines the approach to the review of submissions made:

- Firstly, all the comments were examined to establish how many positive and negative preferences were received for each option. The majority of comments received were in relation to Option 6. This is not surprising as this option was identified as the emerging preferred option.
- Secondly in order to gain a better understanding of the reasons behind the preferences expressed, the comments were studied to pick out the most common theme as well as any other issues frequently mentioned.
- Thirdly, the comments received for Option 6 were organised in terms of address. This task was undertaken to understand the general views by location of those that made a submission.
- Finally all the comments were reviewed to capture issues of concern to those that made submissions. This output from this task provides a series of other issues which can inform future work by Dublin City Council.

2.3 Option Preferences

Figure 1 below illustrates the number of responses in favour of (blue) and against (red) each of the options.

Note: Option 7 represents “do nothing” i.e. do not introduce any changes to the study area.

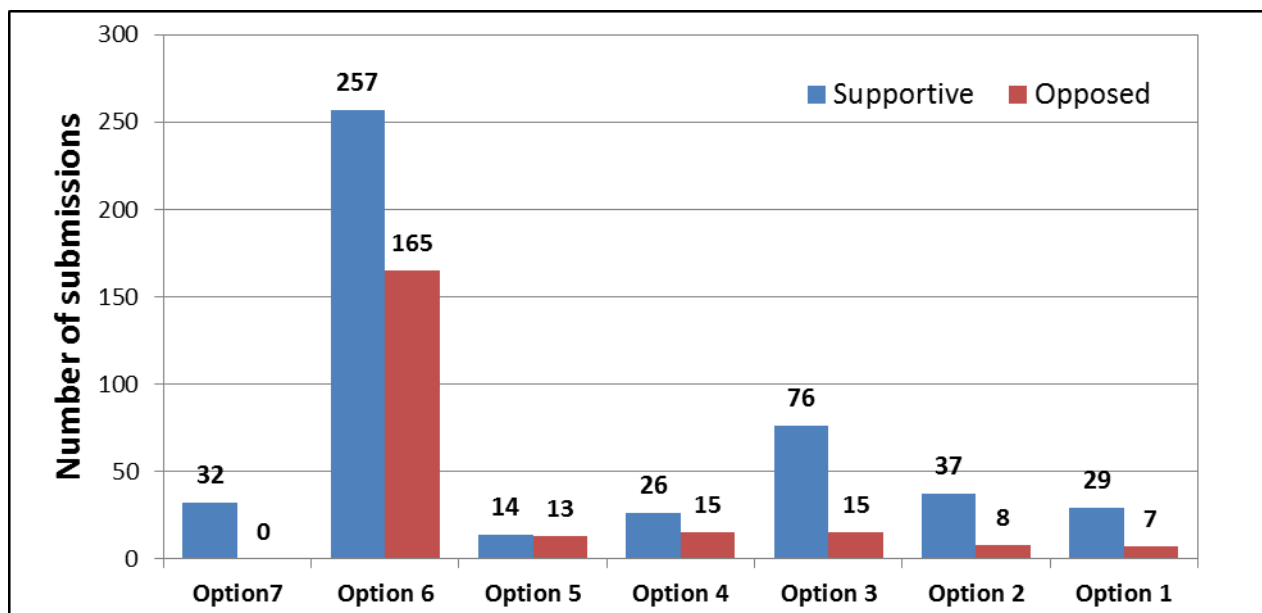

Figure 1: Feedback on Option

A total of 257 respondents were supportive of Option 6 while 165 respondents were opposed to the option. This represents a 61% - 39% split in favour of a road closure (for those that expressed a view on Option 6).

It is noted that the next preference after Option 6, was for Option 3, with less positive preferences expressed in relation to the other options.

It is also important to note, that while the majority of submissions made in relation to Option 6 were supportive of the proposal, there was still a sizable minority opposed to the option.

2.4 Supportive Feedback

The following table summarizes the most recurring comments from those in favour of Option 6. The comments are listed in order of popularity, with the most repeated comments at the top.

Comments	No of Submissions
Must value safety over convenience	71
Walsh Road / Ferguson Road are too dangerous for children to play	48
Traffic volumes and vehicular speed through the area are too high	45
Road closure is the only way to stop rat runs	44
Walsh Road and Ferguson Road are dangerous because cars drive on the pavement	24
Damage/fear of damage to parked cars	22
Too dangerous for elderly people to walk	17
Difficult to cross road (Walsh, Ferguson, Millmount, Millbourne) to get to school in morning/evening	16
Option 6 will alleviate noise and air pollution	14
A road closure will benefit everyone in area	14
No space for pedestrians on the pavements on Walsh Road / Ferguson Road	12
Too dangerous for cyclists	9
Proceed with Option 6 but take away the no right turn on Mobhi road to Home Farm road	7
Difficult to reverse out of driveway on Walsh Road /Ferguson Road	6
Large amount of illegal turning traffic on Walsh Road	6

Table 1: List of recurring comments in favour of Option 6

The large majority of submissions in favour of Option 6 expressed the desire to prioritise safety over convenience; meaning that the safety benefits of eliminating rat-runs through the area would far exceed any inconvenience caused to motorists' journey time.

The next most repeated comments were in relation to the danger for children playing in the area due to the excessive volume of traffic throughout the day and the dangerously high speed of vehicles (often over the pavement). Other submissions in favour of Option 6 mentioned how dangerous the area is for elderly people, the damage to parked vehicles, the difficulty in crossing the road and the lack of space for pedestrians on the footpaths which are already dangerous to due vehicles mounting the footpaths in order to pass oncoming traffic.

2.5 Opposed Feedback

The list below summarizes the most recurring comments from those opposed to Option 6. Again, the comments are listed in order of popularity, with the most repeated comments at the top.

Comments	No of Submission s
Option 6 will only force traffic onto the neighbouring roads	65
Problem for people looking to access the schools (St Pats and Corpus Christi)	56
Option 6 would cut residents off from local amenities e.g. Health clinic, shops, church, library	53
Option 6 will be a major inconvenience in terms of journey time	45
Opposed to any changes to the existing road layout	28
Option 6 penalizes access to study area for residents	26
Drumcondra won't be able to accommodate the additional traffic	20
Option 3 would be enough to eliminate the rat runs whilst still maintaining full access for all	16
Too many cars will park at the cul-de-sac if a road closure is introduced	12
Option 6 would negatively impact local businesses	10
Option 6 would lead to anti-social behaviour at the road closure	9

Table 2: List of Recurring Comments against of Option 6

Most of the submissions against Option 6 mentioned that introducing a road closure at the bottom of Ferguson Road would consequently move the high volume of rat-run traffic onto the surrounding residential roads in the wider study area. Many comments also expressed concern about the difficulty in accessing schools in the area as well as local amenities should the proposed road closure be introduced. Other repeated comments were in relation to the increased journey time, redirecting traffic to the already congested Drumcondra Road, and the limited accessibility the area and the negative impact on local businesses.

2.5 Location Assessment

The location of submissions made was analysed to obtain a general feel for how the residents of those locations have responded to the proposals.



Figure 2: Houses within close proximity of the proposed road closure

88% of the submissions in favour of Option 6 came from residents living in the area in red in Figure 2. Table 3 and Table 4 below present a breakdown of the number of responses from each street inside this area as well as outside the red area.

Supportive of Option 6	
Walsh Road	155
Ferguson Road	20
O' Daly Road	4
Hardiman Road	15
Windele Road	1
Joyce Road	8
O' Brien's Place	0
Fleming Road	3
Barron Place	0
O' Neachtain Road	1
Comyn Place	0
Millbourne Avenue	2
Millmount Avenue	16
Millmount Villas/Place/Terrace	0
College Manor	0
Inside red area	225 (88%)
Outside red area	32 (12%)

Opposed to Option 6	
Walsh Road	12
Ferguson Road	13
O' Daly Road	2
Hardiman Road	3
Windele Road	7
Joyce Road	1
O' Brien's Place	3
Fleming Road	4
Barron Place	6
O' Neachtain Road	2
Comyn Place	3
Millbourne Avenue	10
Millmount Avenue	15
Millmount Villas/Place/Terrace	4
College Manor	2
Inside red area	87 (53%)
Outside red area	78 (47%)

Table 3 (left) and Table 4 (right): Breakdown of Option 6 preference/opposition by area

Table 3 shows that the support for the road closure is quite localised to within the red area – only 12% of submissions in favour of the road closure came from outside this immediate area. While interestingly Table 4 shows a more even spread of submissions opposing Option 6 outside and inside the red area.

2.6 Other Issues

Table 5 lists the most recurring comments which were not directly related to Option 6 i.e. suggestions and general observations from residents of the area.

Comments	No of Submissions
Would like to see speed limits in locality reduced	28
Need to improve/raise the speed bumps	25
The law needs to be enforcement to prevent illegal turning in the area	22
Make Walsh Road and Ferguson Walsh one-way	19
Would like to see filter lane with traffic light to make right turn from Drumcondra road to Millmount easier	18
Would like to see cameras at junctions of Walsh Road and Ferguson Road to catch motorists illegally turning	16
Need pedestrian crossings in the area e.g. on Millmount Avenue, at park entrance on Walsh Road, at lane opposite St Pats	14
Would like electronic bollards for Option 6 which operate during peak times	11
Implement Option 6 on a 3-6 month trial basis	11
Would like to see planters staggered on both sides of Walsh Road and Ferguson Road to slow down traffic	11
Would like to see right turn allowed from Richmond Road	11
Introduce permit / pay and display parking on Millmount Avenue	9
Consideration should be given to need for school parking in the area	6
Would like electronic bollards at top of Walsh Road and Ferguson Road	5
Richmond Road should be made one-way	5
Schools could help the situation by starting at different times	3
Large amount of illegal turning traffic on Walsh Road and Ferguson Road	3

Table 5: List of general comments about the study area

The most commonly mentioned issues were about the need for upgraded speed bumps, speed signs and a reduced speed limit in the study area as well as proper enforcement of restricted movements e.g. the no right turn onto Walsh Road and Ferguson Road, the no left turn from Millmount Avenue and the no right turn from Millbourne Avenue and Richmond Road. Some of the other repeated suggestions included making Walsh Road and Ferguson Road one-way (in opposite directions) and the need for a right turn filter light from Drumcondra Road onto Millmount Avenue, if option 6 goes ahead. Many suggested implementing Option 6 on a trial basis for 3 to 6 months and/or if possible introducing electronic bollards which either operate during peak times or can be lowered via swipe cards allocated to residents.

3 Conclusion

The following are the conclusions of this note which summarises the responses to the public information events held in relation to the Wider Area Traffic Cell Analysis of Walsh Road, Ferguson Road and Millmount Avenue project:

- A total of 473 submissions were received;
- The majority of the submissions received related to Option 6. This Option was identified prior to the public information events as the emerging preferred option;
- Of the submissions that expressed a view on Option 6, the majority supported the proposal (61%);
- While those who expressed opposition to Option 6 were in the minority (39%), there was still a sizable volume of submissions from people who held the view that this option should not proceed;
- Those in favour of Option 6 are mostly located in the immediate vicinity of the proposed road closure;
- A number of issues that are not addressed by any of the options are of concern to those that made submissions. These issues have been captured in this report.